

Springtime in Texas

Beefmaster Sale

APRIL 27, 2013
BRENHAM, TEXAS
Washington County Fairgrounds

★ **60 Lots** ★

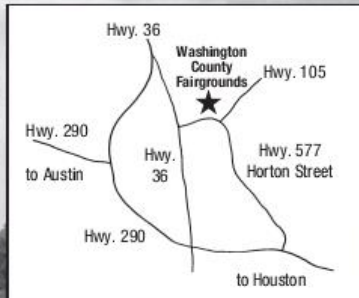

SCHEDULE OF EVENTS:

Friday, April 26:
View Cattle all Day
6 pm - Social
Saturday, April 27:
10:30 a.m. - Sale

JBBA Show following the sale

For additional information contact
Dawn Compton 979-204-3630



Preview cattle & catalogs.
www.advancedvideoauctions.com

HOTELS:

LaQuinta 979-836-5551 • Holiday Inn 979-836-4590 • Comfort 979-421-8100
Ramada 979-836-1300 • Best Western 979-251-7791 • Days Inn 979-830-1110

CONSIGNORS:

Swinging B
Beefmasters
Mackie Bounds

T5
Beefmasters
J.C. Thompson

Maneth
Beefmasters
Gery Maneth

KAN
Beefmasters
Kenneth Allen

Seeker
Beefmasters
Rick Seeker

Sister Grove
Ranch
H.G. Griffin

Armatys 5A
Ranch
Max Armatys

Hillside Farms
Mike Savage

Millseat
Beefmasters
Steve Doty

Dun Rovin
Ranch
Jerry Ronquille



SALE MANAGER:
Three G Sales & Service
Mike Green

915 Pearidge, Franklin, GA 30217
979-229-6563 Mobile • 706-675-1797 Fax
threeg1990@yahoo.com

Find us on Facebook @ 3G Sales & Service

Sale Consultant: Bruce Robbins 210-861-5136

Auctioneer: Anthony Mihalski 210-415-0888

VIDEO AVAILABLE

Dear Beefmaster Breeders,

Welcome to our annual Springtime In Texas Sale, April 27 at the Washington County Fairgrounds. This year's offering is a continuation of excellence from the consignors. You will have the opportunity to select from all categories of cattle to include some semen and embryos. Please study the catalog hard as you will find top replacements for your programs.

The cattle will be in place on Friday for your viewing pleasure. Friday evening join us for a fajita dinner, social and meet and greet. Saturday the sale will start at 10:30 am. After the sale we will host a JBBA heifer show at the same cite. Contact Dawn Compton for information at 979-204-3630.

The sale will be online for absentee bidding during the sale. Please see the information in this catalog for instructions on how to register and bid online.

We are looking forward to seeing you at the sale. If myself or sale consultant Bruce Robbins can help you in any way, please don't hesitate to call on us. See you in Brenham!

Sincerely,



Mike Green
3G Sales and Service

Technology • Experience • Communications



Bid and Buy live using the industry's best real time interactive online auction service.

Advanced Video Auctions (AVA) provides live video auctions, webinars and many other marketing and meeting presentations in real time over the internet.

The **AVA** system was created and developed especially for the marketing and promotion of livestock and is well proven to provide a unique presentation for various livestock events via the internet.

Videos, still images and detailed information on each of the lots offered is available prior to the sale and may be viewed anytime at www.AdvancedVideoAuctions.com. You do not need a username or password in order to preview the sale offering prior to the sale, but we do encourage you to **Register Early** for the sale to obtain your username and password. You can use this login info on the **AVA** system for each sale where you desire to become a buyer.

On sale day you will log on with your username and password and will then be able to view the auction broadcast with either live streaming video or pre-recorded video of the lots, and on some events, you will see both. In addition, the **AVA** system provides **live streaming audio** from the sale site so you don't miss any part of the auction

action; hearing the auctioneer and other comments announced. Plus, you can **privately chat** in real time with the on-side bid administrator.

Please go to www.AdvancedVideoAuctions.com to register for the sale or event. You only have to register once for all events held! Please try to register prior to sale or event day. Also, please note that payment terms are unique and specific for each sale. Please review any of the sale terms ahead of time and if you have any questions, you can contact the sale personnel designated for that auction.

Optimal Connection Speed: DSL, Cable internet or any Broadband internet connections. Minimum download speed of 512 is recommended.

Computer Requirements: Most any computer six years old or younger with the latest versions of the Internet browsers Internet Explorer or Firefox with Adobe Flash player installed are recommended. You can download the current version of the Flash player at www.adobe.com.

Best Viewing: Set your computer screen to at least 1024 x 768 pixels.

Sale Day Help Desk: 888.354.0181

Contact us today for more information about www.AdvancedVideoAuctions.com | 888.354.0181

ADOPTED BY BEEFMASTER BREEDERS UNITED
FOR BBU APPROVED SALES
Effective September 10, 2010

THE FOLLOWING TERMS ARE APPLICABLE TO ALL TRANSACTIONS IN BBU APPROVED SALES:

1. **BIDDING:** Each animal will be sold to the highest bidder without reserve.
2. **BIDDING DISPUTE:** The Auctioneer in charge will settle any dispute as to bids, and his decision on such matters shall be final.
3. **TERMS:** Terms of the sale are cash due upon sale, unless prior credit arrangements for the sale have been agreed upon in writing between the Buyer and Seller, in which event, the terms of the written credit arrangement between the Buyer and Seller for the sale shall prevail. The failure of a member buyer to pay the appropriate party the sale amounts when due may constitute a cause for exclusion from BBU pursuant to Article I, section 9 of the By Laws of BBU.
4. **PURCHASER'S RISK:** Each animal becomes the risk of the purchaser as soon as the auctioneer declares it sold.
5. **CERTIFICATE OF BREEDING AND/OR TRANSFERS:** All required paperwork will be transferred to the buyer at the seller's expense, upon settlement.
6. **HEALTH:** All animals will have appropriate certificates of veterinary inspection for travel to the sale site and will to the best of the seller's knowledge be eligible for interstate shipment, however, buyers need to be aware of their individual resident state's requirements for shipment of cattle. Any and all testing will have been completed within thirty (30) days of the sale date.
7. **ANNOUNCEMENTS:** Any changes in information of any kind will be announced from the auction box and such announcements shall take precedence.
8. **BREEDING GUARANTEES:**
 - a) **FEMALES: OPEN AND/OR EXPOSED FEMALES:** Females younger than twenty-four (24) months of age can be sold as open. Open females are so guaranteed. Any female is considered a breeder if she is certified to be pregnant by a licensed veterinarian at the time of sale and/or has a nursing calf at side. Cows (including donor cows) with calves at side six (6) months or older must be certified to be pregnant by a licensed veterinarian.
 - b) **SAFE IN CALF FEMALES** have been examined by a competent veterinarian and are so guaranteed.
 - c) **BULLS:** Bulls eighteen (18) months or older are guaranteed to have passed a Bull Breeding Soundness Evaluation (BSE) and to have been certified a satisfactory potential breeder by a licensed veterinarian within forty-five (45) days prior to sale date. The results of the Breeding Soundness Evaluation (BSE) must be reported on a fully completed official form and attached to the health papers required for the sale.
9. **DISCLOSURE OF PRIOR PROCEDURES:** If known to the seller, there must be a disclosure in the current sale catalog or from the box of any circumcision or other surgical alteration of any underline of any male or female and of any single egg or super-ovulation flush of any female sold in a BBU Approved Sale.
10. **INHERITED DEFORMITIES GUARANTEE:** All bred females are guaranteed not to produce a calf with an inherited deformity occurring in Bovine for a period of nine months following date of sale.
11. **REPRESENTATIONS AND GUARANTEES:** All representations and guarantees, whether set forth in sale catalogs, these Terms and Conditions of Sale or otherwise, are solely those of seller and are not those of BBU. Except for the assurances set forth in the Approved Sales Agreement that an animal does not exhibit a genetic defect and that its registry information is consistent with the information in BBU's records, BBU makes no representations, warranties, guaranties or assurances whatsoever.
12. **RIGHTS AND OBLIGATIONS:** The above terms and conditions of sale shall constitute a contract between buyer and seller of each animal and shall be equally binding upon both. Each sale or resale of an animal constitutes a separate transaction. Neither BBU, the sale manager, nor any other person connected with the management of the sales assumes any liability, legal or otherwise, for any subsequent resale of an animal.
13. **REMEDIES:** a) **OPEN AND/OR EXPOSED FEMALES** are guaranteed to be breeders by twenty-four (24) months of age except in cases of animals purchased and then fitted for show or administered any super ovulation drug. In cases of animals fitted for show or administered any super ovulation drug after purchase, the breeding guarantees, if any, shall be such as agreed upon between buyer and seller. All claims for a refund must be made in writing to the seller within six (6) months after the animal reaches twenty-four (24) months of age. Open females are so guaranteed. If within sixty (60) days after the sale date, a female sold as "open" proves to be with calf, the buyer may return the 9/10/2010 female to the farm of the seller, provided the female is in good condition and in compliance with the health requirements of the seller's state, and receive refund of the full purchase price. The acceptance of the refund of the full purchase price shall in any case be deemed full satisfaction and settlement of the matter. The buyer's failure to notify the seller within sixty (60) days from the date of sale and to make the election as hereinabove provided shall relieve and absolve the seller of any duty, obligation or liability to the buyer regarding the purchase of said female. The seller and buyer shall bear equally all reasonable and necessary transportation expenses that are incurred in returning the animal to seller.

b) SAFE IN CALF FEMALES are guaranteed to have been examined by a licensed veterinarian. If within thirty (30) days after sale date, a female sold as “safe in calf” proves not to be in calf, the buyer may immediately request that the female receive service from the bull previously used, if available, or return the female to the farm of the seller, provided the female is in good condition and in compliance with the health requirements of the seller’s state, for a refund of the full purchase price. The acceptance of the refund of the full purchase price shall in any case be deemed full satisfaction and settlement of the matter. The buyer’s failure to notify the seller within thirty (30) days from the sale date and to make the election as hereinabove provided shall relieve and absolve to the seller of any duty, obligation or liability to the buyer regarding the purchase of said female. The seller and buyer shall bear equally all reasonable and necessary transportation expenses that are incurred in returning the animal to seller.

c) FLUSHES AND TIME REQUIREMENTS: A flush consists of all viable embryos, transferred or frozen, received from a female as the result of the administration of any super ovulation drug. The sale of a flush or resulting pregnancies must specify in the sale catalog the number of pregnancies guaranteed and the disposition of any other pregnancies resulting from the flush, the disposition of any frozen embryos resulting from the flush and any additional charge for the recipient cows. The maximum time for the delivery of the guaranteed results must be specified along with a payment schedule. Non-delivery or only partial delivery by the specified time by the seller will result in a pro-rata refund of all monies paid by the buyer for such flush or pregnancies not delivered.

d) PREGNANCY AND/OR PREGNANT RECIPIENT COW: Pregnancy and/or pregnant recipient cow is a cow of any breed that is carrying a pregnancy (guaranteed to have been examined by a licensed veterinarian as safe in calf) as the result of a flush as so stated on the certification of embryo transplant form. Such pregnancy and/or pregnant recipient cow is guaranteed to be carrying the embryo pregnancy so stated and if found not safe in calf by a licensed veterinarian within thirty (30) days of delivery of the recipient cow to the buyer, the buyer will have the same remedies as set forth in clause b) for the safe in calf females. The amount bid by the buyer for the individual pregnancy and/or pregnant recipient cow offered at a sale will be inclusive of the recipient cow. A pregnancy and/or pregnant recipient cow should be available at the sale site; however, if not available it must be delivered to the buyer, at the seller’s expense, within thirty (30) days of the sale with the necessary health papers sufficient for delivery to the buyer.

e) CLONES: Only BBU replication cell-cloned animals shall be eligible for registration and eligible to sell in BBU Voluntary Approved Sales. Genetically modified animals shall not be eligible for registration and cannot sell in BBU Approved Sales. Cloned animals shall be guaranteed by the seller to be breeders under the same terms of the agreement for females and bulls. *Any additional guarantees with respect to clones shall be by separate agreement between buyer and seller.*

f) BULLS: If within one-hundred twenty (120) days from the date of sale, the bull has failed to pass a Breeding Soundness Evaluation (“BSE”) certified by a licensed veterinarian, buyer must send seller written notification of the failure of the test within one-hundred and twenty (120) days from the date of sale and include the BSE test results. Within sixty (60) days after seller’s notification of the failed BSE test, buyer and seller shall identify a mutually agreeable licensed veterinarian or technician certified by a licensed veterinarian to perform another BSE on the bull at the buyer’s expense. The results of the test shall be deemed final and conclusive of this matter and binding on buyer and seller. If, in the opinion of said veterinarian or technician, the bull is unable to pass a BSE and be confirmed a satisfactory potential breeder, he shall so certify in writing to the seller and the buyer which shall include the official form used by the Society of Theriogenology or the official BBU Breeding Soundness Evaluation form. In such event the buyer may return the bull to the farm of seller, provided the bull is in good condition and in compliance with the health requirements of the seller’s state, for a refund of the full purchase price. The acceptance of the refund of the full purchase price shall in any case be deemed full satisfaction and settlement of the matter. The seller and buyer shall bear equally all reasonable and necessary transportation expenses that are incurred in returning the animal to seller. A listing of industry standards for Scrotal Circumferences for bulls at various ages will be printed in the sale catalog. Satellites, Marketing Groups, or individuals may specify additional guarantees.

THIS IS A BBU APPROVED SALE AND FOLLOWS THE BBU VOLUNTARY SALE AGREEMENT (on file at the BBU Office).

BBU Mission Statement:

Our Mission is to enhance breeders’ ability to raise and promote cattle based upon the founding “Six Essential”.

DISPOSITION
FERTILITY
WEIGHT
CONFORMATION
HARDINESS
MILK PRODUCTION

Our Vision is to increase worldwide demand for Beefmaster Cattle.

Guiding Principles:

1. Always strive for breed improvement. 2. Never compromise integrity. 3. Expand...Encourage...Educate.



**Beefmaster
Breeder
United**

Voluntary Classification Guidelines:

Cattle are visually inspected by a BBU field representative for desirable traits. Each animal is classified according to BBU's Standards of Excellence.

Any bull or female in the "U" category will be so designated on the BBU Certificate of Breeding along with the date and initials of the BBU field representative. To be presented for a "U" classification, males and females must be a minimum of 8 months with no upper age limit. Classification of Certified Beefmaster cattle is \$5.00 per head or \$350.00 per stop, whichever is greater.

Any bull or female in the "X" category will be removed from the registry by BBU's office and so noted by correspondence to the member. BBU will not charge the member a classification fee for an "X" animal.

Bulls must have a yearling scrotal measurement (taken between 320-410 days of age) of at least 30 cm to meet the "U" qualification. A measurement of 34 cm is the objective.

All cattle presented for classification must have permanent identification and must be certified or an application for certification must be presented to the field representative.

To receive a number score all animals must have a "U" classification.

All animals (male and female) aged 13 months and up may be presented for "U" classification and number scores for conformation and underline, with the stipulation that if the animal is seen later in a BBU Approved or Sanctioned Sale it is subject to reclassification by the BBU field service representative at the sale (at no charge).

Scrotal Circumference Scores:

SCORE	AGE		
	15-20 Mo. Old	21-30 Mo. Old	Over 30 Mo. Old
Very Good	More than 37 cm.	More than 39 cm.	More than 40 cm.
Good	31-37 cm.	32-39 cm.	33-40 cm.
Poor	Less than 31 cm.	Less than 32 cm.	Less than 33 cm.

CONSIGNERS INDEX

Armaty's 5A Ranch , Max Armatys, College Station, TX.....	43, 44, 45
Bounds Swinging B Ranch , Mackie & Norma Bounds, Axtell, TX.....	18, 19, 20, 21, 22, 23, 24, 25, 26, 27A, 27B, 28,
Diamond L Ranch , Brenham, TX.....	34, 35, 36, 37,
Dun Rovin Ranch-Sister Grove Ranch , Montgomery, TX.....	46, 47
Gareth Johnson , Mullin, TX.....	51
Hill Side Farm , Hamilton, MS.....	39, 40
Jacob Johnson , Mullin, TX.....	52
Jon Colburn , Olive Branch, MS.....	54
Kan , Kenneth & Nancy Allen, Bryan, TX.....	50,
Maneth Farms Beefmasters , Yoakum, TX.....	41, 42
T5 Ranch , J.C. Thompson, Roans Prairie, TX.....	29, 30, 31, 32, 33
Red Bayou Syndicate , Franklin, GA.....	53
Rick Seeker , Brenham, TX.....	1A, 1B, 1C, 1D, 2, 3, 4, 5, 6, 7, 8, 9, 10, 11, 12, 13, 14, 15, 16, 17
Steve & Peggy Doty , Bleiberville, TX.....	48, 49

LOT 1A**RICK SEEKER - BULL PICK**

ID#: 14/2
 BREEDER: SEEKER
 BBU#: 1023330
 DOB: 2-10-12
 COLOR: RED MUL

** CAVALIER 19/5 LH C817557 DNA 302A
 L YR-CY U 1/2 11/96 BT 5679A

QUASAR 991 LE C811785 DNA 26B
 HARROD FARMS U 1/02 BT 7176A

MARILYN 19/5 LE C708045
 MAXWELL RANCH BT 5840F

** RED SUGAR 104/93 LH C529759 DNA 184A
 L TWO RANCH U 1/2 11/94 BT 4550F

JEZABELLE 62J8 LE C801257 DNA 371399A
 THE HOMESTEAD U 2/00 BT 6925A

** MISS JUDY 6/91 LH C459847
 L TWO RANCH U 1/2 8/92 BT 4138B

** PAINTED WARRIOR 0026 RH C134634
 BARFIELD U 1/81 BT 535

** PAINTED TIGER 3-390 LH C238565 DNA US3000923
 DUNKIN FARMS U 10/85 BT 3081B

** 1-126 LH C166366
 DUNKIN FARMS U 1/3 9/90 BT 3535A

** CHEROKEE PHANTOM USA 122/90 LE C457159 DNA 4C
 CHANNAROCK FARM U 1/2 9/91 BT 4528A

** MASON-DIXON QUEEN 3-2-6 LE C535009
 CHEROKEE HILLS BT 5098D

** 2017 LH C247496
 THOMPSON - ROCKING T U 2/2 10/91 BT 3413C

TIGER QUEEN HAS ALWAYS BEEN A HERD BULL PRODUCER. THIS FLUSH WITH LOGAN BRINGS FORWARD TREMENDOUS MARKETABILITY AND PREDICTABILITY. THESE ARE VERY HEAVY MUSCLED PROSPECTS. TAKE YOUR PICK!

SIRE: ** LOGAN 62M27 LE C883222 DNA 322220A
 THE HOMESTEAD U 1/2 1/06 BT 7960A

DAM: TIGER QUEEN 200 LE C759737
 TRENT CROMER BT 6410A

EPDS						
	BW	WW	YW	MILK	TM	SC
EPD	1.6	7	13	1	4	0.4
ACC	PE	PE	PE	PE	PE	PE

ULTRASOUND EPDS				
	REA	%IMF	Rib Fat	Rump Fat
EPD	-0.07	0.1	0.08	0.17
ACC	PE	PE	PE	PE

INDIVIDUAL PERFORMANCE RECORDS								
	BW	WW	YW	Scrotal	REA	%IMF	Rib Fat	Rump Fat
Ratio		100	104		105	73	76	51
Contmp.		4	4		4	4	4	4
Adj. Trait		505	1031	30.92	11	1.7	0.13	0.16

LOT 1B**RICK SEEKER - BULL PICK**

ID#: 13/2
 BREEDER: SEEKER
 BBU#: 1023329
 DOB: 2-9-12
 COLOR: RED MUL

** CAVALIER 19/5 LH C817557 DNA 302A
 L YR-CY U 1/2 11/96 BT 5679A

QUASAR 991 LE C811785 DNA 26B
 HARROD FARMS U 1/02 BT 7176A

MARILYN 19/5 LE C708045
 MAXWELL RANCH BT 5840F

** RED SUGAR 104/93 LH C529759 DNA 184A
 L TWO RANCH U 1/2 11/94 BT 4550F

JEZABELLE 62J8 LE C801257 DNA 371399A
 THE HOMESTEAD U 2/00 BT 6925A

** MISS JUDY 6/91 LH C459847
 L TWO RANCH U 1/2 8/92 BT 4138B

** PAINTED WARRIOR 0026 RH C134634
 BARFIELD U 1/81 BT 535

** PAINTED TIGER 3-390 LH C238565 DNA US3000923
 DUNKIN FARMS U 10/85 BT 3081B

** 1-126 LH C166366
 DUNKIN FARMS U 1/3 9/90 BT 3535A

** CHEROKEE PHANTOM USA 122/90 LE C457159 DNA 4C
 CHANNAROCK FARM U 1/2 9/91 BT 4528A

** MASON-DIXON QUEEN 3-2-6 LE C535009
 CHEROKEE HILLS BT 5098D

** 2017 LH C247496
 THOMPSON - ROCKING T U 2/2 10/91 BT 3413C

EPDS						
	BW	WW	YW	MILK	TM	SC
EPD	1.6	7	13	1	4	0.4
ACC	PE	PE	PE	PE	PE	PE

ULTRASOUND EPDS				
	REA	%IMF	Rib Fat	Rump Fat
EPD	-0.07	0.1	0.08	0.17
ACC	PE	PE	PE	PE

INDIVIDUAL PERFORMANCE RECORDS								
	BW	WW	YW	Scrotal	REA	%IMF	Rib Fat	Rump Fat
Ratio		101	101		101	125	141	160
Contmp.		4	4		4	4	4	4
Adj. Trait		510	1011	30.89	10.59	2.9	0.24	0.5

SIRE: ** LOGAN 62M27 LE C883222 DNA 322220A
 THE HOMESTEAD U 1/2 1/06 BT 7960A

DAM: TIGER QUEEN 200 LE C759737
 TRENT CROMER BT 6410A

LOT 1C**RICK SEEKER - BULL PICK**

ID#: 12/2
 BREEDER: SEEKER
 BBU#: 1023328
 DOB: 2-7-12
 COLOR: RED MUL

** CAVALIER 19/5 LH C617557 DNA 302A
 L YR-CY U 1/2 11/96 BT 5679A

QUASAR 991 LE C811785 DNA 26B
 HARROD FARMS U 1/02 BT 7176A

MARILYN 19/5 LE C708045
 MAXWELL RANCH BT 5840F

** RED SUGAR 104/93 LH C529759 DNA 184A
 L TWO RANCH U 1/2 11/94 BT 4550F

JEZABELLE 62J8 LE C801257 DNA 371399A
 THE HOMESTEAD U 2/00 BT 6925A

** MISS JUDY 6/91 LH C459847
 L TWO RANCH U 1/2 8/92 BT 4138B

** PAINTED WARRIOR 0026 RH C134634
 BARFIELD U 1/81 BT 535

** PAINTED TIGER 3-390 LH C238565 DNA US3000923
 DUNKIN FARMS U 10/85 BT 3081B

** 1-126 LH C166366
 DUNKIN FARMS U 1/3 9/90 BT 3535A

** CHEROKEE PHANTOM USA 122/90 LE C457159 DNA 4C
 CHANNAROCK FARM U 1/2 9/91 BT 4528A

** MASON-DIXON QUEEN 3-2-6 LE C535009
 CHEROKEE HILLS BT 5098D

** 2017 LH C247496
 THOMPSON - ROCKING T U 2/2 10/91 BT 3413C

EPDS						
	BW	WW	YW	MILK	TM	SC
EPD	1.6	7	13	1	4	0.4
ACC	PE	PE	PE	PE	PE	PE

ULTRASOUND EPDS				
	REA	%IMF	Rib Fat	Rump Fat
EPD	-0.07	0.1	0.08	0.17
ACC	PE	PE	PE	PE

INDIVIDUAL PERFORMANCE RECORDS								
	BW	WW	YW	Scrotal	REA	%IMF	Rib Fat	Rump Fat
Ratio		101	93		105	85	71	90
Contmp.		4	4		4	4	4	4
Adj. Trait		509	923	29.87	11.05	2.2	0.12	0.28

SIRE: ** LOGAN 62M27 LE C883222 DNA 322220A
 THE HOMESTEAD U 1/2 1/06 BT 7960A

DAM: TIGER QUEEN 200 LE C759737
 TRENT CROMER BT 6410A

LOT 1D

RICK SEEKER – BULL PICK

ID#: 11/2
 BREEDER: SEEKER
 BBU#: 1023327
 DOB: 2-5-12
 COLOR: RED MUL

** CAVALIER 19/5 LH C817557 DNA 302A

LYR-CY U 1/2 11/96 BT 5679A

QUASAR 991 LE C811785 DNA 26B

HARROD FARMS U 1/02 BT 7176A

MARILYN 19/5 LE C708045

MAXWELL RANCH BT 5840F

SIRE: ** LOGAN 62M27 LE C883222 DNA 322220A
 THE HOMESTEAD U 1/2 1/06 BT 7960A

** RED SUGAR 104/93 LH C529759 DNA 184A

L TWO RANCH U 1/2 11/94 BT 4550F

JEZABELLE 62J8 LE C801257 DNA 371399A

THE HOMESTEAD U 2/00 BT 6925A

** MISS JUDY 6/91 LH C459847

L TWO RANCH U 1/2 8/92 BT 4138B

** PAINTED WARRIOR 0026 RH C134634

BARFIELD U 1/81 BT 535

** PAINTED TIGER 3-390 LH C238565 DNA US3000923

DUNKIN FARMS U 10/85 BT 3081B

** 1-126 LH C166366

DUNKIN FARMS U 1/3 9/90 BT 3535A

DAM: TIGER QUEEN 200 LE C759737
 TRENT CROMER BT 6410A

** CHEROKEE PHANTOM USA 122/90 LE C457159 DNA 4C

CHANNAROCK FARM U 1/2 9/91 BT 4528A

** MASON-DIXON QUEEN 3-2-6 LE C535009

CHEROKEE HILLS BT 5098D

** 2017 LH C247496

THOMPSON - ROCKING T U 2/2 10/91 BT 3413C

EPDS						
	BW	WW	YW	MILK	TM	SC
EPD	1.6	7	13	1	4	0.4
ACC	PE	PE	PE	PE	PE	PE

ULTRASOUND EPDS				
	REA	%IMF	Rib Fat	Rump Fat
EPD	-0.07	0.1	0.08	0.17
ACC	PE	PE	PE	PE

INDIVIDUAL PERFORMANCE RECORDS								
	BW	WW	YW	Scrotal	REA	%IMF	Rib Fat	Rump Fat
Ratio		99	102		90	108	112	99
Contmp.		4	4		4	4	4	4
Adj. Trait	501	1021	30.77	9.43	2.5	0.19	0.31	

LOT 2

RICK SEEKER – BRED HEIFER

ID#: SOUTH OAKS 1143
 BREEDER: DODDS
 BBU#: 1008342
 DOB: 3-26-11
 COLOR: RED MUL
 SAFE TO: RED BAYOU 990090 5-6 MONTHS

THIS IS A HALF SISTER TO THE RESERVE CHAMPION FEMALE THIS YEAR IN HOUSTON. SHE'S LONG, DEEP AND EXTREMELY POPULARLY BRED. SAFE TO RED BAYOU 5-6 MONTHS. WON'T THAT BE AN EXCITING CAI F?

EPDS						
	BW	WW	YW	MILK	TM	SC
EPD	1.0	7	9	0	4	-0.1
ACC	.45	.41	.34	.17	-	.21

ULTRASOUND EPDS				
	REA	%IMF	Rib Fat	Rump Fat
EPD				
ACC				

INDIVIDUAL PERFORMANCE RECORDS								
	BW	WW	YW	Scrotal	REA	%IMF	Rib Fat	Rump Fat
Ratio		98	102					
Contmp.		6	6					
Adj. Trait	73	456						

** BLACK JACK 21 LE C817059 DNA 40A

SHELL RANCH U 1/2 4/02 BT 7093A

ACE IN THE HOLE 70/3 LE C898727 DNA 249A

TRENT CROMER U 1/2 9/06 BT 8285A

SUGAR PIE 42/01 LE C852246

TRENT CROMER U 1/2 10/04 BT 7516B

SIRE: 131 LE C951001
 COTTAGE FARM

** INFINITY 120/96 LH C706197 DNA 674A

L TWO RANCH U 1/2 12/97 BT 5956A

CF GOLDLOCKS 808 LE C891779 DNA 963A

COTTAGE FARM BT 9258A

BOMB SHELL 396 LE C742387 DNA 313359A

COTTAGE FARM U 1/2 10/00 BT 6758B

** RED SUGAR 104/93 LH C529759 DNA 184A

L TWO RANCH U 1/2 11/94 BT 4550F

** SYNERGY 84/95 LH C615710 DNA 183A

L TWO CATTLE U 1/2 1/97 BT 5779A

** PRISSY LADY 117/93 LH C537931

L TWO RANCH U 1/2 9/95 BT 5207A

DAM: BF17/07 LH C958589
 BAILEY FARM

** SPARTACUS 86/653 RH C317158 DNA 9A

DAVID C BROWN BEEFMASTERS U 1/3 5/93 BT 3116A

MOMMA MIA 83/93 LH C538974

L TWO RANCH U 1/2 11/94 BT 4841D

** 23 LH C327451

BALES U 2/3 5/94 BT 3374D

LOT 3

RICK SEEKER – BRED HEIFER – POLLED

ID#: 13/1
 BREEDER: SEEKER
 BBU#: 1011449
 DOB: 6-4-11
 COLOR: RED
 SAFE TO: RED BAYOU 990090 8 MONTHS

A VERY HEAVY BONE BULLET PROOF DAUGHTER OUT OF A TIGER QUEEN DAUGHTER. POWER AND PREDICTABILITY ABOUND THIS FEMALE. ON TOP OF IT ALL SHE IS BRED TO RED BAYOU AND POLLED.

EPDS						
	BW	WW	YW	MILK	TM	SC
EPD	0.4	10	16	1	6	0.4
ACC	.47	.44	.39	.19	-	.24

ULTRASOUND EPDS				
	REA	%IMF	Rib Fat	Rump Fat
EPD	-0.05	0.2	0.01	0.03
ACC	PE	PE	PE	PE

INDIVIDUAL PERFORMANCE RECORDS								
	BW	WW	YW	Scrotal	REA	%IMF	Rib Fat	Rump Fat
Ratio	101	97	100					
Contmp.	2	2	2					
Adj. Trait	68	449	657					

** C.J'S DESPERADO 530 RH C631430 DNA 16C

CLARK JONES FARMS U 1/3 11/96 BT 5760A

C.J'S BANDELERO 960 RH C809701 DNA 100A

CLARK JONES FARMS U 1/3 2/02 BT 7189A

WORK OF ART 507 LT C611580

CAIN U 1/2 8/98 BT 5694A

SIRE: BULLET PROOF 864 LE C931489 DNA US9000957935 PV
 COTTAGE FARM U 4/08

** CAVALIER 19/5 LH C617557 DNA 302A

LYR-CY U 1/2 11/96 BT 5679A

** OASIS 655 LE C828198 DNA 251620A

COTTAGE FARM U 1/2 2/04 BT 7628A

** SEX LIFE 388 LE C714150 DNA 313360A

COTTAGE FARM U 1/3 10/00 BT 6533C

721 LE C755781

CLARK JONES FARMS

C.J'S SOUL MAN 168 RH C867835 DNA US3000427

CLARK JONES FARMS U 1/2 2/04 BT 7670A

SOULMANS MOMMA 928 LE C799411

CLARK JONES FARMS U 11/00 BT 8016A

DAM: 8/6 LH C946058
 SEEKER

** PAINTED TIGER 3-390 LH C238565 DNA US3000923

DUNKIN FARMS U 10/85 BT 3081B

TIGER QUEEN 200 LE C759737

TRENT CROMER BT 6410A

** MASON-DIXON QUEEN 3-2-6 LE C535009

CHEROKEE HILLS BT 5098D

LOT 4**RICK SEEKER – BRED HEIFER**

ID#: 14/1
 BREEDER: SEEKER
 BBU#: 1011450
 DOB: 6-10-11
 COLOR: RED
 SAFE TO: RED BAYOU 990090 4-5 MONTHS

ANOTHER BULLET PROOF DAUGHTER WITH HIS VOLUME AND POWER. BRED AGAIN TO RED BAYOU FOR A SURE TO BE FANCY CALF.

EPDS						
	BW	WW	YW	MILK	TM	SC
EPD	1.3	15	23	1	8	0.2
ACC	.42	.41	.36	.17	-	.23

ULTRASOUND EPDS				
	REA	%IMF	Rib Fat	Rump Fat
EPD	0.04	0.0	-0.07	-0.06
ACC	PE	PE	PE	PE

INDIVIDUAL PERFORMANCE RECORDS								
	BW	WW	YW	Scrotal	REA	%IMF	Rib Fat	Rump Fat
Ratio	99	103	100					
Contmp.	2	2	2					
Adj. Trait	70	475	652					

SIRE: BULLET PROOF 864 LE C931489 DNA US9000957935 PV
 COTTAGE FARM U 4/08

DAM: 554 RH C925330
 GALBRAITH BROS.

**** C.J'S DESPERADO 530 RH C631430 DNA 16C**
 CLARK JONES FARMS U 1/3 11/96 BT 5760A
C.J'S BANDELERO 960 RH C809701 DNA 100A
 CLARK JONES FARMS U 1/3 2/02 BT 7189A
 WORK OF ART 507 LT C611580
 CAIN U 1/2 8/98 BT 5694A

**** CAVALIER 19/5 LH C617557 DNA 302A**
 LYR-CY U 1/2 11/96 BT 5679A

**** OASIS 655 LE C828198 DNA 251620A**
 COTTAGE FARM U 1/2 2/04 BT 7628A
**** SEX LIFE 388 LE C714150 DNA 313360A**
 COTTAGE FARM U 1/3 10/00 BT 6533C

**** COUNTRY WESTERN 340/9 RT C380140**
 GORDONS U 1/3 4/91 BT 4025A

**** BLACK MAGIC 120/97 LE C754207 DNA 599A**
 KOOPMAN U 1/2 11/99 BT 6408A
**** MAGIC MOM 72/2 LE C527692 DNA 416448A**
 KOOPMAN U 2/2 11/98 BT 6839A

**** HAVANA 485 LT C609842**
 CAIN U 1/2 9/95 BT 5367A

JULIE 43/00 43/00 RH C822385
 LITTLE HORN U 1/2 9/03
 64/5 RH C635838
 LITTLE HORN U 1/2 6/97 BT 6228A

LOT 5**RICK SEEKER – BRED HEIFER – POLLED**

ID#: 15/1
 BREEDER: SEEKER
 BBU#: 1011451
 DOB: 8-1-11
 COLOR: RED
 SAFE TO: RED BAYOU 990090 3 MONTHS

TWIN TO LOT 6. A VERY CORRECT, POLLED BULLET PROOF DAUGHTER OUT OF TRIPS TO WIN. THE BULLET PROOF X BLACK JACK CROSS IS VERY PREDICTABLE. NOTICE PAINTED TIGER IN THE MATERNAL MIX. BRED TO RED BAYOU.

EPDS						
	BW	WW	YW	MILK	TM	SC
EPD	0.7	12	18	2	8	0.4
ACC	.45	.42	.38	.17	-	.23

ULTRASOUND EPDS				
	REA	%IMF	Rib Fat	Rump Fat
EPD	-0.06	0.0	-0.06	-0.05
ACC	PE	PE	PE	PE

INDIVIDUAL PERFORMANCE RECORDS								
	BW	WW	YW	Scrotal	REA	%IMF	Rib Fat	Rump Fat
Ratio	103	99	100					
Contmp.	2	2	1					
Adj. Trait	55	426	640					

SIRE: BULLET PROOF 864 LE C931489 DNA US9000957935 PV
 COTTAGE FARM U 4/08

DAM: TRIPS TO WIN 412 LH C912872
 COLBURN U 3/06

**** C.J'S DESPERADO 530 RH C631430 DNA 16C**
 CLARK JONES FARMS U 1/3 11/96 BT 5760A
C.J'S BANDELERO 960 RH C809701 DNA 100A
 CLARK JONES FARMS U 1/3 2/02 BT 7189A
 WORK OF ART 507 LT C611580
 CAIN U 1/2 8/98 BT 5694A

**** CAVALIER 19/5 LH C617557 DNA 302A**
 LYR-CY U 1/2 11/96 BT 5679A

**** OASIS 655 LE C828198 DNA 251620A**
 COTTAGE FARM U 1/2 2/04 BT 7628A
**** SEX LIFE 388 LE C714150 DNA 313360A**
 COTTAGE FARM U 1/3 10/00 BT 6533C

**** BLACK MAGIC 120/97 LE C754207 DNA 599A**
 KOOPMAN U 1/2 11/99 BT 6408A

**** BLACK JACK 21 LE C817059 DNA 40A**
 SCHELL RANCH U 1/2 4/02 BT 7093A
 MISS SCARLET USA 8-1 LE C757559 DNA 34A
 TRENT CROMER U 1/2 4/01 BT 6562B

**** PAINTED TIGER 3-390 LH C238565 DNA US3000923**
 DUNKIN FARMS U 10/85 BT 3081B

CIRCLE C 16/2 16/2 LE C874664
 TRENT CROMER U 9/03 BT 7956A
 CHEROKEE LEE 5-10-246 LE C670242
 CHEROKEE HILLS BT 6546A

LOT 6**RICK SEEKER – OPEN HEIFER – POLLED**

ID#: BELLE 16/1
 BREEDER: SEEKER
 BBU#: 1011452
 DOB: 8-1-11
 COLOR: RED

SHOWN BY COLLIN WENZEL OF HEWITT, TX. OPEN AND READY TO BREED. TWIN SISTER SELLS AS LOT 5.

EPDS						
	BW	WW	YW	MILK	TM	SC
EPD	1.0	13	19	2	9	0.4
ACC	.45	.42	.38	.17	-	.23

ULTRASOUND EPDS				
	REA	%IMF	Rib Fat	Rump Fat
EPD	-0.06	0.0	-0.06	-0.05
ACC	PE	PE	PE	PE

INDIVIDUAL PERFORMANCE RECORDS								
	BW	WW	YW	Scrotal	REA	%IMF	Rib Fat	Rump Fat
Ratio	97	101						
Contmp.	2	2						
Adj. Trait	58	431						

SIRE: BULLET PROOF 864 LE C931489 DNA US9000957935 PV
 COTTAGE FARM U 4/08

DAM: TRIPS TO WIN 412 LH C912872
 COLBURN U 3/06

**** C.J'S DESPERADO 530 RH C631430 DNA 16C**
 CLARK JONES FARMS U 1/3 11/96 BT 5760A
C.J'S BANDELERO 960 RH C809701 DNA 100A
 CLARK JONES FARMS U 1/3 2/02 BT 7189A
 WORK OF ART 507 LT C611580
 CAIN U 1/2 8/98 BT 5694A

**** CAVALIER 19/5 LH C617557 DNA 302A**
 LYR-CY U 1/2 11/96 BT 5679A

**** OASIS 655 LE C828198 DNA 251620A**
 COTTAGE FARM U 1/2 2/04 BT 7628A
**** SEX LIFE 388 LE C714150 DNA 313360A**
 COTTAGE FARM U 1/3 10/00 BT 6533C

**** BLACK MAGIC 120/97 LE C754207 DNA 599A**
 KOOPMAN U 1/2 11/99 BT 6408A

**** BLACK JACK 21 LE C817059 DNA 40A**
 SCHELL RANCH U 1/2 4/02 BT 7093A
 MISS SCARLET USA 8-1 LE C757559 DNA 34A
 TRENT CROMER U 1/2 4/01 BT 6562B

**** PAINTED TIGER 3-390 LH C238565 DNA US3000923**
 DUNKIN FARMS U 10/85 BT 3081B

CIRCLE C 16/2 16/2 LE C874664
 TRENT CROMER U 9/03 BT 7956A
 CHEROKEE LEE 5-10-246 LE C670242
 CHEROKEE HILLS BT 6546A

LOT 7**RICK SEEKER – OPEN HEIFER**

ID#: 12/2
 BREEDER: SEEKER
 BBU#: 1023324
 DOB: 2-4-12
 COLOR: RED MUL

I REALLY DID NOT WANT TO SELL MY LOGAN X TIGER QUEEN FEMALES. THIS FEMALE IS SURE TO GO INTO A DONOR PROGRAM. LOGAN AND TIGER JUST WORKS. LONG BODIED, HEAVY MUSCLED AND PREDICTABLE! FLUSHMATE TO LOT 1.

EPDS						
	BW	WW	YW	MILK	TM	SC
EPD	1.6	7	13	1	4	0.4
ACC	PE	PE	PE	PE	PE	PE

ULTRASOUND EPDS				
	REA	%IMF	Rib Fat	Rump Fat
EPD	-0.07	0.1	0.08	0.17
ACC	PE	PE	PE	PE

INDIVIDUAL PERFORMANCE RECORDS								
	BW	WW	YW	Scrotal	REA	%IMF	Rib Fat	Rump Fat
Ratio		98	88		99	108	122	91
Contmp.		3	3		3	3	3	3
Adj. Trait		488	816		10.32	3.36	0.33	0.55

SIRE: **** LOGAN 62M27 LE C883222 DNA 322220A**
 THE HOMESTEAD U 1/2 1/06 BT 7960A

**** CAVALIER 19/5 LH C617557 DNA 302A**
 LYR-CY U 1/2 11/96 BT 5679A
QUASAR 991 LE C811785 DNA 26B
 HARROD FARMS U 1/02 BT 7176A
MARILYN 19/5 LE C708045
 MAXWELL RANCH BT 5840F

**** RED SUGAR 104/93 LH C529759 DNA 184A**
 L TWO RANCH U 1/2 11/94 BT 4550F
JEZABELLE 62J8 LE C801257 DNA 371399A
 THE HOMESTEAD U 2/00 BT 6925A
**** MISS JUDY 8/91 LH C459847**
 L TWO RANCH U 1/2 8/92 BT 4138B
**** PAINTED WARRIOR 0026 RH C134634**
 BARFIELD U 1/81 BT 535
**** PAINTED TIGER 3-390 LH C238565 DNA US3000923**
 DUNKIN FARMS U 10/85 BT 3081B
**** 1-126 LH C166366**
 DUNKIN FARMS U 1/3 9/90 BT 3535A

DAM: **TIGER QUEEN 200 LE C759737**
 TRENT CROMER BT 6410A

**** CHEROKEE PHANTOM USA 122/90 LE C457159 DNA 4C**
 CHANNAROCK FARM U 1/2 9/91 BT 4528A
**** MASON-DIXON QUEEN 3-2-6 LE C535009**
 CHEROKEE HILLS BT 5098D
**** 2017 LH C247496**
 THOMPSON - ROCKING T U 2/2 10/91 BT 3413C

LOT 8**RICK SEEKER – OPEN HEIFER – POLLED**

ID#: 1/2
 BREEDER: SEEKER
 BBU#: 1023320
 DOB: 3-5-12
 COLOR: RED MUL

YOU WANT RED POLLED GENETICS? HERE SHE IS. VERY CORRECT AND EASY KEEPING. SOME VERY EXCITING CATTLE IN THIS GIRL'S PEDIGREE.

EPDS						
	BW	WW	YW	MILK	TM	SC
EPD	1.0	13	18	1	7	0.4
ACC	PE	PE	PE	PE	PE	PE

ULTRASOUND EPDS				
	REA	%IMF	Rib Fat	Rump Fat
EPD	-0.02	0.0	-0.03	-0.03
ACC	PE	PE	PE	PE

INDIVIDUAL PERFORMANCE RECORDS								
	BW	WW	YW	Scrotal	REA	%IMF	Rib Fat	Rump Fat
Ratio		100	100		100	100	100	100
Contmp.		1	1		1	1	1	1
Adj. Trait		555	1007		12.83	3.03	0.2	0.37

SIRE: **BULLET PROOF 864 LE C931489 DNA US9000957935 PV**
 COTTAGE FARM U 4/08

**** C/J'S DESPERADO 530 RH C631430 DNA 16C**
 CLARK JONES FARMS U 1/3 11/96 BT 5760A
C/J'S BANDELERO 960 RH C809701 DNA 100A
 CLARK JONES FARMS U 1/3 2/02 BT 7189A
WORK OF ART 507 LT C611580
 CAIN U 1/2 8/98 BT 5694A

**** CAVALIER 19/5 LH C617557 DNA 302A**
 LYR-CY U 1/2 11/96 BT 5679A
**** OASIS 655 LE C828198 DNA 251620A**
 COTTAGE FARM U 1/2 2/04 BT 7628A
**** SEX LIFE 388 LE C714150 DNA 313380A**
 COTTAGE FARM U 1/3 10/00 BT 6533C
**** RANGER'S PRIDE 815/9 LH C127934 DNA 15B**
 * THOMPSON - ROCKING T U 9/88 BT 1728A

**** HAVANA 485 LT C609842**
 CAIN U 1/2 9/95 BT 5367A

DAM: **1/0 LH C834641**
 SEEKER

**** VANNA 5660 LH C273206**
 THOMPSON BROTHERS U 1/2 6/91 BT 2933C

**** PAINTED TIGER 3-390 LH C238565 DNA US3000923**
 DUNKIN FARMS U 10/85 BT 3081B

TIGER QUEEN 200 LE C759737
 TRENT CROMER BT 6410A

**** MASON-DIXON QUEEN 3-2-6 LE C535009**
 CHEROKEE HILLS BT 5098D

LOT 9**RICK SEEKER – OPEN HEIFER**

ID#: 2/2
 BREEDER: SEEKER
 BBU#: 1023396
 DOB: 4-30-12
 COLOR: RED

BULLET PROOF AGAIN AND GOES BACK TO DREAM LADY'S LAST NATURAL CALF. JAZZIE, OASIS AND DREAMLADY MAKE FOR AN EXCEPTIONAL MATERNAL GREATNESS. 1.15 REA/CWT 3.14 IMF.

EPDS						
	BW	WW	YW	MILK	TM	SC
EPD	0.9	15	21	0	8	0.4
ACC	PE	PE	PE	PE	PE	PE

ULTRASOUND EPDS				
	REA	%IMF	Rib Fat	Rump Fat
EPD	-0.04	0.1	-0.04	-0.04
ACC	PE	PE	PE	PE

INDIVIDUAL PERFORMANCE RECORDS								
	BW	WW	YW	Scrotal	REA	%IMF	Rib Fat	Rump Fat
Ratio		93	108					
Contmp.		9	6					
Adj. Trait		491	987					

SIRE: **BULLET PROOF 864 LE C931489 DNA US9000957935 PV**
 COTTAGE FARM U 4/08

**** C/J'S DESPERADO 530 RH C631430 DNA 16C**
 CLARK JONES FARMS U 1/3 11/96 BT 5760A
C/J'S BANDELERO 960 RH C809701 DNA 100A
 CLARK JONES FARMS U 1/3 2/02 BT 7189A
WORK OF ART 507 LT C611580
 CAIN U 1/2 8/98 BT 5694A

**** CAVALIER 19/5 LH C617557 DNA 302A**
 LYR-CY U 1/2 11/96 BT 5679A
**** OASIS 655 LE C828198 DNA 251620A**
 COTTAGE FARM U 1/2 2/04 BT 7628A
**** SEX LIFE 388 LE C714150 DNA 313380A**
 COTTAGE FARM U 1/3 10/00 BT 6533C
**** BLACK JACK 21 LE C817059 DNA 40A**
 SCHELL RANCH U 1/2 4/02 BT 7093A

ZZ TOP 27-4 LH C912215 DNA 742A
 THREE G SALES & SERVICE U 1/2 5/06 BT 9007A
JAZZIE 293L55 LE C857929 DNA 648896 PV
 THE HOMESTEAD U 1/03 BT 7711A

DAM: **8/7 LH C958554**
 SEEKER

**** PHANTOM 0266 LH C136861**
 THOMPSON BROTHERS U 5/82 BT 531

3/1 LH C867921
 SEEKER

116/87 LH C324874
 L TWO RANCH U 2/1 9/91 BT 3619A

LOT 10

RICK SEEKER – OPEN HEIFER

ID#: 3/2
 BREEDER: SEEKER
 BBU#: 1023397
 DOB: 5-2-12
 COLOR: RED MF

**** C.J'S DESPERADO 530 RH C631430 DNA 16C**
 CLARK JONES FARMS U 1/3 11/96 BT 5760A
C.J'S BANDELERO 960 RH C809701 DNA 100A
 CLARK JONES FARMS U 1/3 2/02 BT 7189A
WORK OF ART 507 LT C611580
 CAIN U 1/2 8/98 BT 5694A

SIRE: **BULLET PROOF 864 LE C931489 DNA US9000957935 PV**
 COTTAGE FARM U 4/08

**** CAVALIER 19/5 LH C617557 DNA 302A**
 LYR-CY U 1/2 11/96 BT 5679A
**** OASIS 655 LE C828198 DNA 251620A**
 COTTAGE FARM U 1/2 2/04 BT 7628A
**** SEX LIFE 388 LE C714150 DNA 313360A**
 COTTAGE FARM U 1/3 10/00 BT 6533C
**** BLACK MAGIC 120/97 LE C754207 DNA 599A**
 KOOPMAN U 1/2 11/99 BT 6408A
**** BLACK JACK 21 LE C817059 DNA 40A**
 SCHELL RANCH U 1/2 4/02 BT 7093A
MISS SCARLET USA 8-1 LE C757559 DNA 34A
 TRENT CROMER U 1/2 4/01 BT 6562B

BULLET PROOF JUST WORKS ON BLACK JACK. LADY LIMESTONE IS VERY CLOSELY BRED TO SYNERGY. YOUNG BUT GOOD. 1.07 REA/CWT 3.30 IMF.

EPDS						
	BW	WW	YW	MILK	TM	SC
EPD	0.8	11	16	1	7	0.3
ACC	PE	PE	PE	PE	PE	PE

ULTRASOUND EPDS				
	REA	%IMF	Rib Fat	Rump Fat
EPD	-0.10	0.1	-0.05	-0.05
ACC	PE	PE	PE	PE

DAM: **24-6 LE C945059**
 D T RANCH

**** RED SUGAR 104/93 LH C529759 DNA 184A**
 L TWO RANCH U 1/2 11/94 BT 4550F
LADY LIMESTONE 36-0 LE C844915
 D T RANCH BT 7351A
PRISSY LADY II 125/96 LH C707425 DNA 204A
 L TWO RANCH U 1/2 12/97 BT 6191B

INDIVIDUAL PERFORMANCE RECORDS								
	BW	WW	YW	Scrotal	REA	%IMF	Rib Fat	Rump Fat
Ratio		99	92					
Contmp.		9	6					
Adj. Trait		521	845					

LOT 11

RICK SEEKER – OPEN HEIFER

ID#: 4/2
 BREEDER: SEEKER
 BBU#: 1023321
 DOB: 5-3-12
 COLOR: BLACK

**** BLACK MAGIC 120/97 LE C754207 DNA 599A**
 KOOPMAN U 1/2 11/99 BT 6408A
**** BLACK JACK 21 LE C817059 DNA 40A**
 SCHELL RANCH U 1/2 4/02 BT 7093A
MISS SCARLET USA 8-1 LE C757559 DNA 34A
 TRENT CROMER U 1/2 4/01 BT 6562B

SIRE: **ACE IN THE HOLE 70/3 LE C898727 DNA 249A**
 TRENT CROMER U 1/2 9/06 BT 8285A

**** INFINITY 120/96 LH C706197 DNA 674A**
 L TWO RANCH U 1/2 12/97 BT 5956A
SUGAR PIE 42/01 LE C852246
 TRENT CROMER U 1/2 10/04 BT 7516B
Q TEE PIE 13/9 LE C798178
 TRENT CROMER U 9/00 BT 7223B
**** COUNTRY WESTERN 340/9 RT C380140**
 GORDONS U 1/3 4/91 BT 4025A
**** BLACK MAGIC 120/97 LE C754207 DNA 599A**
 KOOPMAN U 1/2 11/99 BT 6408A
**** MAGIC MOM 72/2 LE C527692 DNA 416448A**
 KOOPMAN U 2/2 11/98 BT 6839A

IF BLACK IS YOUR THING, CHECK OUT THIS FANCY ACE IN THE HOLE DAUGHTER. SHE'S YOUNG BUT VERY FANCY AND FEMININE. 1.34 REA/CWT 3.12 IMF.

EPDS						
	BW	WW	YW	MILK	TM	SC
EPD	1.7	5	10	3	6	-0.3
ACC	PE	PE	PE	PE	PE	PE

ULTRASOUND EPDS				
	REA	%IMF	Rib Fat	Rump Fat
EPD	0.27	-0.1	0.05	0.04
ACC	PE	PE	PE	PE

DAM: **554 RH C925330**
 GALBRAITH BROS.

**** HAVANA 485 LT C609842**
 CAIN U 1/2 9/95 BT 5367A
JULIE 43/00 43/00 RH C822385
 LITTLE HORN U 1/2 9/03
64/5 RH C635838
 LITTLE HORN U 1/2 6/97 BT 6228A

INDIVIDUAL PERFORMANCE RECORDS								
	BW	WW	YW	Scrotal	REA	%IMF	Rib Fat	Rump Fat
Ratio		93	94					
Contmp.		9	6					
Adj. Trait		492	858					

LOT 12

RICK SEEKER – OPEN HEIFER

ID#: 5/2
 BREEDER: SEEKER
 BBU#: 1023398
 DOB: 5-4-12
 COLOR: RED

**** C.J'S DESPERADO 530 RH C631430 DNA 16C**
 CLARK JONES FARMS U 1/3 11/96 BT 5760A
C.J'S BANDELERO 960 RH C809701 DNA 100A
 CLARK JONES FARMS U 1/3 2/02 BT 7189A
WORK OF ART 507 LT C611580
 CAIN U 1/2 8/98 BT 5694A

SIRE: **BULLET PROOF 864 LE C931489 DNA US9000957935 PV**
 COTTAGE FARM U 4/08

**** CAVALIER 19/5 LH C617557 DNA 302A**
 LYR-CY U 1/2 11/96 BT 5679A
**** OASIS 655 LE C828198 DNA 251620A**
 COTTAGE FARM U 1/2 2/04 BT 7628A
**** SEX LIFE 388 LE C714150 DNA 313360A**
 COTTAGE FARM U 1/3 10/00 BT 6533C
721 LE C755781
 CLARK JONES FARMS
C.J'S SOUL MAN 168 RH C867835 DNA US3000427
 CLARK JONES FARMS U 1/2 2/04 BT 7670A
SOULMANS MOMMA 928 LE C799411
 CLARK JONES FARMS U 11/00 BT 8016A

BULLET PROOF STRIKES AGAIN. RANGER'S PRIDE AND VSB 26/5 WAS A GREAT CROSS FOR L2. SHE'S YOUNG BUT STELLER BRED. 1.42 RE/CWT 3.78 IMF.

EPDS						
	BW	WW	YW	MILK	TM	SC
EPD	0.2	10	15	1	6	0.4
ACC	PE	PE	PE	PE	PE	PE

ULTRASOUND EPDS				
	REA	%IMF	Rib Fat	Rump Fat
EPD	-0.04	0.2	-0.01	0.01
ACC	PE	PE	PE	PE

DAM: **13/6 LH C946068**
 SEEKER

**** RANGER'S PRIDE 815/9 LH C127934 DNA 15B**
 * THOMPSON - ROCKING T U 9/88 BT 1728A
99-3 LH C582767
 FORK CREEK U 1/2 9/94 BT 7959A
**** 26/5 LT C265024**
 * V S B BAR U 1/3 5/92 BT 2780B

INDIVIDUAL PERFORMANCE RECORDS								
	BW	WW	YW	Scrotal	REA	%IMF	Rib Fat	Rump Fat
Ratio		95	97					
Contmp.		9	6					
Adj. Trait		502	885					

LOT 13**RICK SEEKER – OPEN HEIFER**

ID#: 6/2
 BREEDER: SEEKER
 BBU#: 1023399
 DOB: 5-5-12
 COLOR: RED MUL

A COOL FEMALE WITH AN INTERESTING PEDIGREE. BULLET PROOF ON TOP BUT CHECK OUT SCARLET'S PRIDE ON THE MATERNAL SIDE TO INSURE FERTILITY. FANCY MAE IS A FLUSH MATE TO PHANNIE MAE, THE DAM OF CHEROKEE PHANTOM. LADY IN WAITING WAS A FROZEN EMBRYO FOR OVER 20 YEARS. 1.20 REA/CWT 2.77 IMF.

EPDS						
	BW	WW	YW	MILK	TM	SC
EPD	1.3	13	20	1	8	0.4
ACC	PE	PE	PE	PE	PE	PE

ULTRASOUND EPDS				
	REA	%IMF	Rib Fat	Rump Fat
EPD				
ACC				

INDIVIDUAL PERFORMANCE RECORDS								
	BW	WW	YW	Scrotal	REA	%IMF	Rib Fat	Rump Fat
Ratio		95	87					
Contmp.		9	6					
Adj. Trait		500	797					

SIRE: BULLET PROOF 864 LE C931489 DNA US9000957935 PV
 COTTAGE FARM U 4/08

DAM: 182/7 LH C957505
 J T FARMS

** C/J'S DESPERADO 530 RH C631430 DNA 16C
 CLARK JONES FARMS U 1/3 11/96 BT 5760A
 C/J'S BANDELERO 960 RH C809701 DNA 100A
 CLARK JONES FARMS U 1/3 2/02 BT 7189A
 WORK OF ART 507 LT C611580
 CAIN U 1/2 8/98 BT 5694A

** CAVALIER 19/5 LH C617557 DNA 302A
 LYR-CY U 1/2 11/96 BT 5679A
** OASIS 655 LE C828198 DNA 251620A
 COTTAGE FARM U 1/2 2/04 BT 7628A
** SEX LIFE 388 LE C714150 DNA 313360A
 COTTAGE FARM U 1/3 10/00 BT 6533C
** RANGER'S PRIDE 815/9 LH C127934 DNA 15B
 * THOMPSON - ROCKING T U 9/88 BT 1728A
** SCARLET'S PRIDE 4101 LH C577841 DNA US3000459
 M J CATTLE COMPANY U 1/2 12/95 BT 5614A
** MISS SCARLETT 81-8 LH C392218
 COTTAGE FARM U 1/1 11/90 BT 3987A

** PHANTOM 0266 LH C136861
 THOMPSON BROTHERS U 5/82 BT 531
 FANCY MAE 6-36 LE C746125
 TRENT CROMER U 1/2 4/05 BT 6982B
 LADY IN WAITING 46/2 BE C517306
 DOUBLE BAR S BT 5535A

LOT 14**RICK SEEKER – OPEN HEIFER**

ID#: 7/2
 BREEDER: SEEKER
 BBU#: 1023400
 DOB: 5-6-12
 COLOR: RED

A FULL GENETIC SISTER TO LOT 12. CHECK OUT HER YEARLING WEIGHT! IMF 4.28!

EPDS						
	BW	WW	YW	MILK	TM	SC
EPD	0.2	11	17	1	6	0.5
ACC	PE	PE	PE	PE	PE	PE

ULTRASOUND EPDS				
	REA	%IMF	Rib Fat	Rump Fat
EPD	-0.04	0.1	-0.03	-0.03
ACC	PE	PE	PE	PE

INDIVIDUAL PERFORMANCE RECORDS								
	BW	WW	YW	Scrotal	REA	%IMF	Rib Fat	Rump Fat
Ratio		100	123					
Contmp.		9	6					
Adj. Trait		529	1129					

SIRE: BULLET PROOF 864 LE C931489 DNA US9000957935 PV
 COTTAGE FARM U 4/08

DAM: 12/6 LH C946067
 SEEKER

** C/J'S DESPERADO 530 RH C631430 DNA 16C
 CLARK JONES FARMS U 1/3 11/96 BT 5760A
 C/J'S BANDELERO 960 RH C809701 DNA 100A
 CLARK JONES FARMS U 1/3 2/02 BT 7189A
 WORK OF ART 507 LT C611580
 CAIN U 1/2 8/98 BT 5694A

** CAVALIER 19/5 LH C617557 DNA 302A
 LYR-CY U 1/2 11/96 BT 5679A
** OASIS 655 LE C828198 DNA 251620A
 COTTAGE FARM U 1/2 2/04 BT 7628A
** SEX LIFE 388 LE C714150 DNA 313360A
 COTTAGE FARM U 1/3 10/00 BT 6533C
 721 LE C755781
 CLARK JONES FARMS
 C/J'S SOUL MAN 168 RH C867835 DNA US3000427
 CLARK JONES FARMS U 1/2 2/04 BT 7670A
 SOULMANS MOMMA 928 LE C799411
 CLARK JONES FARMS U 11/00 BT 8016A

** RANGER'S PRIDE 815/9 LH C127934 DNA 15B
 * THOMPSON - ROCKING T U 9/88 BT 1728A
 99-3 LH C582767
 FORK CREEK U 1/2 9/94 BT 7959A
** 26/5 LT C265024
 * V S B BAR U 1/3 5/92 BT 2780B

LOT 15**RICK SEEKER – OPEN HEIFER**

ID#: 15/2
 BREEDER: SEEKER
 BBU#: 1023403
 DOB: 5-30-12
 COLOR: RED

YOUTHFUL BULLET PROOF DAUGHTER WITH AGAIN BLACK JACK MATERNALLY. MISS CHOCOLATE MINT WAS ONE OF THE QUEEN DAUGHTERS THAT I KEPT. THEY ARE EASY KEEPING AND CONTINUED TO BREED ON TIME EVEN DURING THE DROUGHT. 1.21 REA/CWT 5.05 IMF!

EPDS						
	BW	WW	YW	MILK	TM	SC
EPD	0.9	13	18	1	8	0.4
ACC	PE	PE	PE	PE	PE	PE

ULTRASOUND EPDS				
	REA	%IMF	Rib Fat	Rump Fat
EPD	-0.09	0.0	-0.06	-0.01
ACC	PE	PE	PE	PE

INDIVIDUAL PERFORMANCE RECORDS								
	BW	WW	YW	Scrotal	REA	%IMF	Rib Fat	Rump Fat
Ratio		102						
Contmp.		9						
Adj. Trait		538						

SIRE: BULLET PROOF 864 LE C931489 DNA US9000957935 PV
 COTTAGE FARM U 4/08

DAM: 7/6 LH C946071
 SEEKER

** C/J'S DESPERADO 530 RH C631430 DNA 16C
 CLARK JONES FARMS U 1/3 11/96 BT 5760A
 C/J'S BANDELERO 960 RH C809701 DNA 100A
 CLARK JONES FARMS U 1/3 2/02 BT 7189A
 WORK OF ART 507 LT C611580
 CAIN U 1/2 8/98 BT 5694A

** CAVALIER 19/5 LH C617557 DNA 302A
 LYR-CY U 1/2 11/96 BT 5679A
** OASIS 655 LE C828198 DNA 251620A
 COTTAGE FARM U 1/2 2/04 BT 7628A
** SEX LIFE 388 LE C714150 DNA 313360A
 COTTAGE FARM U 1/3 10/00 BT 6533C
** MR COFFEE 9006/8 LE C775045
 HARROD FARMS U 1/2 3/00 BT 6669A
 BLACK SEX APPEAL 92 LE C907169 DNA 460A
 T - BOB BT 8602A

SEXSATION 400 LE C742384 DNA 78A
 COTTAGE FARM U 5/99 BT 8028A
** BLACK JACK 21 LE C817059 DNA 40A
 SCHELL RANCH U 1/2 4/02 BT 7093A
 MISS CHOCOLATE MINT 9/4 LH C914302
 SEEKER
 TIGER QUEEN 200 LE C759737
 TRENT CROMER BT 6410A

LOT 16

RICK SEEKER – OPEN HEIFER - POLLED

ID#: 8/2
 BREEDER: SEEKER
 BBU#: 1023401
 DOB: 6-1-12
 COLOR: RED

A FULL SISTER TO THE LOT 3 BRED HEIFER. NOTICE THE CALVING INTERVAL CONSISTENT AT A YEAR, JUST LIKE HER SISTER, SHE WILL BE VERY PRODUCTIVE. SHE'S POLLED TO BOOT! 1.14 REA/CWT 2.87 IMF.

EPDS						
	BW	WW	YW	MILK	TM	SC
EPD	0.4	11	16	1	6	0.5
ACC	PE	PE	PE	PE	PE	PE

ULTRASOUND EPDS				
	REA	%IMF	Rib Fat	Rump Fat
EPD	-0.06	0.2	0.01	0.03
ACC	PE	PE	PE	PE

INDIVIDUAL PERFORMANCE RECORDS								
	BW	WW	YW	Scrotal	REA	%IMF	Rib Fat	Rump Fat
Ratio		106						
Contmp.		9						
Adj. Trait		563						

SIRE: BULLET PROOF 864 LE C931489 DNA US9000957935 PV
 COTTAGE FARM U 4/08

DAM: 8/6 LH C946058
 SEEKER

** C.J'S DESPERADO 530 RH C631430 DNA 16C
 CLARK JONES FARMS U 1/3 11/96 BT 5760A

C.J'S BANDELERO 960 RH C809701 DNA 100A
 CLARK JONES FARMS U 1/3 2/02 BT 7189A
 WORK OF ART 507 LT C611580
 CAIN U 1/2 8/98 BT 5694A

** CAVALIER 19/5 LH C817557 DNA 302A
 LYR-CY U 1/2 11/96 BT 5679A

** OASIS 655 LE C828198 DNA 251620A
 COTTAGE FARM U 1/2 2/04 BT 7628A
** SEX LIFE 388 LE C714150 DNA 313360A
 COTTAGE FARM U 1/3 10/00 BT 6533C
 721 LE C755781
 CLARK JONES FARMS

C.J'S SOUL MAN 168 RH C867835 DNA US3000427
 CLARK JONES FARMS U 1/2 2/04 BT 7670A
 SOULMANS MOMMA 928 LE C799411
 CLARK JONES FARMS U 11/00 BT 8016A

** PAINTED TIGER 3-390 LH C238565 DNA US300092:
 DUNKIN FARMS U 10/85 BT 3081B

TIGER QUEEN 200 LE C759737
 TRENT CROMER BT 6410A

** MASON-DIXON QUEEN 3-2-6 LE C535009
 CHEROKEE HILLS BT 5098D

LOT 17

RICK SEEKER – OPEN HEIFER

ID#: 10/2
 BREEDER: SEEKER
 BBU#: 1023408
 DOB: 6-18-12
 COLOR: RED WUL

I PURCHASED THIS HEIFERS DAM FROM DR. RESTREPO BECAUSE OF TIGER QUEEN, BUT IF YOU LOOK FARTHER YOU WILL FIND SYNERGY AND VICTOR'S SISTER MATERNALLY. SHE'S MY YOUNGEST TO SELL BUT HAS GREAT PERFORMANCE. IMF 3.91.

EPDS						
	BW	WW	YW	MILK	TM	SC
EPD	0.9	10	14	2	7	0.2
ACC	PE	PE	PE	PE	PE	PE

ULTRASOUND EPDS				
	REA	%IMF	Rib Fat	Rump Fat
EPD				
ACC				

INDIVIDUAL PERFORMANCE RECORDS								
	BW	WW	YW	Scrotal	REA	%IMF	Rib Fat	Rump Fat
Ratio		118						
Contmp.		9						
Adj. Trait		625						

SIRE: EMS RED BAYOU 1058 RE C977083
 P & L

DAM: POLLED MOM VANNA 141 LE C1003104
 SANTA ANA RANCH INVTs LLC

** POLLED MANDATE 404/5 LE C705841
 CHANNAROCK FARM U 1/2 4/98 BT 6226A

BLACK BAYOU 1071/3 LE C892444 DNA US3000542
 CHANNAROCK FARM U 1/2 5/06 BT 8891A
** 2C46/8 LH S9887
* MULLINS U 3/3 6/91

** BLACK JACK 21 LE C817059 DNA 40A
 SCHELL RANCH U 1/2 4/02 BT 7093A

EMS BODY POTION 5-39 LH C915300 DNA 384991A PV
 EMMONS RANCH BT 88U475

EMS BODY BY SMOOTH 0-31 LH C820410 DNA 4919925
 EMMONS RANCH BT 7700A

ACE IN THE HOLE 70/3 LE C898727 DNA 249A
 TRENT CROMER U 1/2 9/06 BT 8285A

VICTOR'S ACE 121 LE C930267 DNA 434740A
 T V R U 1/2 1/09

224 LE C813245 DNA 351A PV
 COTTAGE FARM U 10/00 BT 8427A

** HAVANA 485 LT C609842
 CAIN U 1/2 9/95 BT 5367A

HAVANA - QUEEN 5/8 LH C967279
 SEEKER

TIGER QUEEN 200 LE C759737
 TRENT CROMER BT 6410A

LOT 18

**BOUNDS SWINGING B RANCH – PAIR
 MACKIE & NORMA JEAN BOUNDS**

ID#: JANINE 44/8
 BREEDER: A & G FARMS
 BBU#: 978009
 DOB: 10-1-08
 COLOR: RED

HEIFER
 RHONDA 4-13
 BOUNDS
 1023522
 2-3-13
 RED

SPARTACUS, INFINITY, AND CAVALIER ALL WRAPPED UP IN THIS YOUNG COW. JANINE IS VERY FEMININE, HONEST, CALF RAISING MACHINE. SHE HAS A SHOW HEIFER PROSPECT AT SIDE Sired BY SMITH & WESSON'S FULL BROTHER, BLACK POWDER. EVERY TIME A BLACK POWDER CALF HITS THE GROUND, I WANT TO KICK MYSELF FOR SELLING THAT BULL!!! HIS CALVES ARE FLAT AWESOME. HEIFER CALF BORN 2-3-13.

EPDS						
	BW	WW	YW	MILK	TM	SC
EPD	0.6	6	2	-5	-2	-0.1
ACC	.39	.45	.45	.33	-	.34

ULTRASOUND EPDS				
	REA	%IMF	Rib Fat	Rump Fat
EPD	-0.32	-0.1	-0.02	-0.06
ACC	.41	.42	.42	.44

INDIVIDUAL PERFORMANCE RECORDS								
	BW	WW	YW	Scrotal	REA	%IMF	Rib Fat	Rump Fat
Ratio		100	100		100	100	100	100
Contmp.		1	1		1	1	1	1
Adj. Trait		501	620		7.1	0.89	0.23	0.32

SIRE: SWB BLACK POWDER 29-09 LE C977450 DNA US400045601 PV
 BOUNDS SWINGING B RANCH

DAM: JANINE 44/8

C.J'S BANDELERO 960 RH C809701 DNA 100A
 CLARK JONES FARMS U 1/3 2/02 BT 7189A

BULLET PROOF 864 LE C931489 DNA US9000957935 PV
 COTTAGE FARM U 4/08

** OASIS 655 LE C828198 DNA 251620A
 COTTAGE FARM U 1/2 2/04 BT 7628A

ACE IN THE HOLE 70/3 LE C898727 DNA 249A
 TRENT CROMER U 1/2 9/06 BT 8285A

MARISSA 22/7 LT C944803 DNA 504519A PV
 BRADLEY'S CIRCLE J U 10/07

** GLADIATOR 8/36 LH C85998
 CIRCLE DOT U 11/80 BT 494

** SPARTACUS 86/653 RH C317158 DNA 9A
 DAVID C BROWN BEEFMASTERS U 1/3 5/93 BT 3116A

** DREAMLADY 2C 9-77 LH S769
 MAURICE HARRELL U 1/2 9/90 BT 2012A

** INFINITY 120/96 LH C706197 DNA 674A
 L TWO RANCH U 1/2 12/97 BT 5956A

LADY EM 293L59 LE C858346 DNA 387399A
 THE HOMESTEAD U 1/03 BT 8218A

SECRET LADY 293J34 LE C815252
 THE HOMESTEAD U 1/01 BT 8972A

LOT 19

**BOUNDS SWINGING B RANCH – PAIR
MACKIE & NORMA JEAN BOUNDS**

ID#: MYSTERY OF ACE 914
BREEDER: RJR
BBU#: 985633
DOB: 4-18-09
COLOR: RED BRINDLE

HEIFER
SWB MONICA 2/13
BOUNDS
1021707
1-10-13
BLACK

C.J'S BANDELERO 960 RH C809701 DNA 100A
CLARK JONES FARMS U 1/3 2/02 BT 7189A
BULLET PROOF 864 LE C931489 DNA US9000957935 PV
COTTAGE FARM U 4/08
** OASIS 655 LE C828198 DNA 251620A
COTTAGE FARM U 1/2 2/04 BT 7628A

SIRE: SWB BLACK POWDER 29-09 LE C977450 DNA US400045601 PV
BOUNDS SWINGING B RANCH

WOW, I CAN'T BELIEVE WE ARE LETTING THIS PAIR GO!! THIS ACE IN THE HOLE DAUGHTER IS AS ATTRACTIVE AS YOU CAN MAKE ONE. VERY FEMININE FRONTED, EXTRA LONG SPINED, AND HAS AN IMPECCABLE UDDER. JBBA KIDS, BE SURE TO NOTICE THIS SHOW STOPPER HEIFER CALF Sired BY SMITH & WESSON'S FULL BROTHER BLACK POWDER. THIS BABY IS SURE TO TAKE YOU TO THE WINNER'S CIRCLE. HEIFER CALF BORN 1-10-13

ACE IN THE HOLE 70/3 LE C898727 DNA 249A
TRENT CROMER U 1/2 9/06 BT 8285A
MARISSA 22/7 LT C944803 DNA 504519A PV
BRADLEY'S CIRCLE J U 10/07
LADY CHEROKEE 700 LE C828215 DNA 498A
COTTAGE FARM U 1/3 10/03 BT 8624A
** BLACK JACK 21 LE C817059 DNA 40A
SCHELL RANCH U 1/2 4/02 BT 7093A
ACE IN THE HOLE 70/3 LE C898727 DNA 249A
TRENT CROMER U 1/2 9/06 BT 8285A
SUGAR PIE 42/01 LE C852246
TRENT CROMER U 1/2 10/04 BT 7516B

EPDS						
	BW	WW	YW	MILK	TM	SC
EPD	1.5	9	12	3	8	-0.1
ACC	.52	.48	.44	.24	-	.29

ULTRASOUND EPDS				
	REA	%IMF	Rib Fat	Rump Fat
EPD	0.26	0.0	0.11	0.05
ACC	.41	.44	.42	.45

DAM: 914 LE C985633
R J R

INDIVIDUAL PERFORMANCE RECORDS								
	BW	WW	YW	Scrotal	REA	%IMF	Rib Fat	Rump Fat
Ratio	103	111			136	107	133	94
Contmp.	3	3			3	3	3	3
Adj. Trait	65	537			8.62	3.24	0.12	0.15

ONYX 415-1 LE C837437 DNA 364383A
T V R U 5/03 BT 7530A
MYSTERIOUS GIRL 52/4 LE C889240 DNA 475448A PV
WILMOTH & SONS U 6/06
NIRVANA 96/1 LH C846745 DNA 314853A
WILMOTH & SONS U 5/03 BT 7788A

LOT 20

**BOUNDS SWINGING B RANCH – PAIR
MACKIE & NORMA JEAN BOUNDS**

ID#: SWEET APPEAL 108
BREEDER: RJR
BBU#: 1015832
DOB: 4-3-10
COLOR: DUN

BULL
SWB FRANCISCO 1/13
BOUNDS
1021706
1-1-13
RED

QUASAR 991 LE C811785 DNA 26B
HARROD FARMS U 1/02 BT 7176A
** LOGAN 62M27 LE C883222 DNA 322220A
THE HOMESTEAD U 1/2 1/06 BT 7960A
JEZABELLE 62J8 LE C801257 DNA 371399A
THE HOMESTEAD U 2/00 BT 6925A

SIRE: LOGANOMICS 104 LE C1015833
R J R

HERE IS A MONEY MAKING PAIR RIGHT HERE!! THIS RIO GRANDE DAUGHTER IS SUPER NICE BALANCED, LEVEL TOPPED, AND HAS A PERFECT UDDER. SHE HAS AN OUTSTANDING BULL CALF AT SIDE Sired BY LOGANOMICS (C1015833). DON'T MISS THIS CALF. HE WILL PAY FOR THE WHOLE PACKAGE HIMSELF. SELLS OPEN AND READY TO BREED BACK TO THE BULL OF YOUR CHOICE. BULL CALF BORN 1-1-13

ONYX 415-1 LE C837437 DNA 364383A
T V R U 5/03 BT 7530A
MYSTERIOUS GIRL 52/4 LE C889240 DNA 475448A PV
WILMOTH & SONS U 6/06
NIRVANA 96/1 LH C846745 DNA 314853A
WILMOTH & SONS U 5/03 BT 7788A
9020 LH C798779 DNA 314158A
SPEAR RANCHES U 1/2 12/02 BT 7545A
RIO GRANDE SR 3184 LE C889892 DNA 542A
SPEAR RANCHES U 1/2 6/08 BT 8243A
7098-2C LH S19976
SPEAR RANCHES

ULTRASOUND EPDS				
	REA	%IMF	Rib Fat	Rump Fat
EPD	0.26	0.1	0.10	0.05
ACC	PE	PE	PE	PE

DAM: SWEET APPEAL 108 LE C1015832
R J R

EPDS						
	BW	WW	YW	MILK	TM	SC
EPD	-0.8	10	19	1	6	0.1
ACC	.28	.28	.26	.17	-	.15

ACE IN THE HOLE 70/3 LE C898727 DNA 249A
TRENT CROMER U 1/2 9/06 BT 8285A
ALLURE 91-7 RH C958776
CLARK JONES
BRINDLE PRINCESS KS 500 LE C920791 DNA 928A
HARROD FARMS U 3/07 BT 9194A

LOT 21

**BOUNDS SWINGING B RANCH – PAIR
MACKIE & NORMA JEAN BOUNDS**

ID#: SWB VENUS 67/11
BREEDER: BOUNDS
BBU#: 1004392
DOB: 1-18-11
COLOR: BLACK

BULL
VICTORY 7/13
BOUNDS
AF
2-17-13
DK RED

QUASAR 991 LE C811785 DNA 26B
HARROD FARMS U 1/02 BT 7178A
** LOGAN 62M27 LE C883222 DNA 322220A
THE HOMESTEAD U 1/2 1/06 BT 7960A
JEZABELLE 62J8 LE C801257 DNA 371399A
THE HOMESTEAD U 2/00 BT 6925A

SIRE: VISION 905 905/7 LH C956555 DNA 531691A PV
COLLIER FARMS U 1/2 3/10

VENUS IS POWERFULLY CONSTRUCTED FEMALE, EXTRA HEAVY BONED, AND SQUARE HIPPED. SHE CALVED ON SCHEDULE JUST AFTER HER SECOND BIRTHDAY AND IS RAISING A SUPER NICE BULL CALF Sired BY VISION. THERE IS A LOT OF POWER AND FERTILITY IN THIS YOUNG PAIR. BULL CALF BORN 2-17-13.

** PAINTED TIGER 3-390 LH C238565 DNA US3000923
DUNKIN FARMS U 10/85 BT 3081B
** PENELOPE 293/11 LE C901471 DNA 525668A
THE HOMESTEAD U 2/00 BT 6930B

EPDS						
	BW	WW	YW	MILK	TM	SC
EPD	1.9	10	24	2	7	0.0
ACC	.54	.51	.51	.26	-	.33

ULTRASOUND EPDS				
	REA	%IMF	Rib Fat	Rump Fat
EPD	0.29	0.0	0.13	0.16
ACC	.47	.50	.50	.51

DAM: VENUS 67/11
DNAUS9000957613PV

INDIVIDUAL PERFORMANCE RECORDS								
	BW	WW	YW	Scrotal	REA	%IMF	Rib Fat	Rump Fat
Ratio	100	99	123		118	110	132	114
Contmp.	34	20	11		11	11	11	11
Adj. Trait	64	570	940		11.21	3.13	0.32	0.48

ACE IN THE HOLE 70/3 LE C898727 DNA 249A
TRENT CROMER U 1/2 9/06 BT 8285A
SUGAR PIE 42/01 LE C852246
TRENT CROMER U 1/2 10/04 BT 7516B
** BLACK JACK 21 LE C817059 DNA 40A
SCHELL RANCH U 1/2 4/02 BT 7093A
NANCY'S AWESOME 1 LE C932969 DNA US9000948465 PV
SCHELL RANCH U 4/07
C J'S MISS AWESOME 646 RH C665963 DNA 51A
CLARK JONES FARMS U 1/2 8/06 BT 6296B

LOT 22

**BOUNDS SWINGING B RANCH – BRED
MACKIE & NORMA JEAN BOUNDS**

ID#: ALLURE 91-7
BREEDER: JONES
BBU#: 958776
DOB: 11-1-07
COLOR: BLACK
SAFE TO: BRAZOS 1010297

HERE IS A STOUT MADE NICELY DESIGNED ACE IN THE HOLE DAUGHTER. ALLURE GOES BACK TO LITTLE PRINCESS ON THE BOTTOM SIDE, WHO WAS A FULL SISTER TO CAVALIER. SELLS BRED TO BRAZOS, A LOGAN SON. THAT MATING WILL WORK!! BRAZOS (C1010297)

EPDS						
	BW	WW	YW	MILK	TM	SC
EPD	0.8	0	2	1	1	-0.2
ACC	.36	.36	.34	.26	-	.28

ULTRASOUND EPDS				
	REA	%IMF	Rib Fat	Rump Fat
EPD	0.12	0.1	0.10	0.08
ACC	.29	.29	.28	.29

INDIVIDUAL PERFORMANCE RECORDS								
	BW	WW	YW	Scrotal	REA	%IMF	Rib Fat	Rump Fat
Rank			100		100		100	100
Contmp.		1	1		1	1	1	1
Adj. Trait		542	926		9.78	2.99	0.36	0.48

SIRE: ACE IN THE HOLE 70/3 LE C898727 DNA 249A
TRENT CROMER U 1/2 9/06 BT 8285A

**** BLACK MAGIC 120/97 LE C754207 DNA 599A**
KOOPMAN U 1/2 11/99 BT 6408A
**** BLACK JACK 21 LE C817059 DNA 40A**
SCHELL RANCH U 1/2 4/02 BT 7093A
MISS SCARLET USA 8-1 LE C757559 DNA 34A
TRENT CROMER U 1/2 4/01 BT 6562B

**** INFINITY 120/96 LH C706197 DNA 674A**
L TWO RANCH U 1/2 12/97 BT 5956A
SUGAR PIE 42/01 LE C852246
TRENT CROMER U 1/2 10/04 BT 7516B
Q TEE PIE 13/9 LE C798178
TRENT CROMER U 9/00 BT 7223B
721 LE C755781
CLARK JONES FARMS
CJ'S SOUL MAN 168 RH C867835 DNA US3000427
CLARK JONES FARMS U 1/2 2/04 BT 7670A
SOULMANS MOMMA 928 LE C799411
CLARK JONES FARMS U 11/00 BT 8016A

DAM: BRINDLE PRINCESS KS 500 LE C920791 DNA 928A
HARROD FARMS U 3/07 BT 9194A

**** SPARTACUS 86/653 RH C317158 DNA 9A**
DAVID C BROWN BEEFMASTERS U 1/3 5/93 BT 3116A
LITTLE PRINCESS 590 LE C813244 DNA 346212A
COTTAGE FARM U 10/00 BT 7538D
**** 1-5/5 LH C245236**
LAZY M U 1/2 4/91 BT 2171A

LOT 23

**BOUNDS SWINGING B RANCH – BRED POLLED DONOR
MACKIE & NORMA JEAN BOUNDS**

ID#: LOVE ME 186
BREEDER: COTTAGE FARM
BBU#: 974136
DOB: 11-1-08
COLOR: RED
SAFE TO: BRAZOS 1010297

DNA527984APV LOVE ME HAS BEEN VERY PRODUCTIVE IN OUR DONOR PROGRAM. WE WANTED TO OFFER SOME OF OUR BEST IN THE SPRINGTIME IN TEXAS SALE AND THAT'S THE ONLY REASON SHE'S HERE!!! YOU WILL SEE SOME OF HER BULLET PROOF PROGENY IN OUR PRODUCTION SALE IN MAY. THIS 5 YEAR OLD POLLED COW IS RIGHT IN HER PRIME, PROVEN BUT NOT USED UP BY ANY MEANS. SELLS BRED TO BRAZOS, A LOGAN SON THAT WE PICKED UP FROM COLLIER FRAMS LAST FALL. WE ARE REALLY EXCITED ABOUT SEEING HIS CALVES AND LOVE ME WILL HAVE ONE OF THE FIRST.

ULTRASOUND EPDS				
	REA	%IMF	Rib Fat	Rump Fat
EPD	-0.17	0.1	0.00	0.00
ACC	.24	.24	.23	.24

EPDS						
	BW	WW	YW	MILK	TM	SC
EPD	1.4	4	6	-4	-2	-0.3
ACC	.34	.34	.33	.19	-	.26

SIRE: OF RIGHT DIRECTION 873 LE C923818 DNA 382094A
COTTAGE FARM U 3/08 BT BBU485

721 LE C755781
CLARK JONES FARMS
CJ'S SOUL MAN 168 RH C867835 DNA US3000427
CLARK JONES FARMS U 1/2 2/04 BT 7670A
SOULMANS MOMMA 928 LE C799411
CLARK JONES FARMS U 11/00 BT 8016A

**** CJ'S DESPERADO 530 RH C631430 DNA 16C**
CLARK JONES FARMS U 1/3 11/96 BT 5760A
SEX GODESS 398 LE C773489
COTTAGE FARM U 1/2 7/03 BT 6954B
**** SEX APPEAL 062/0 LH C453999**
ADAIR U 1/2 4/92 BT 4709A
**** RED SUGAR 104/93 LH C529759 DNA 184A**
L TWO RANCH U 1/2 11/94 BT 4550F
**** INFINITY 120/96 LH C706197 DNA 674A**
L TWO RANCH U 1/2 12/97 BT 5956A
**** VANNA 5660 LH C273206**
THOMPSON BROTHERS U 1/2 6/91 BT 2933C

DAM: OF PLAYMATE 807 LE C891778 DNA 318697A PV
COTTAGE FARM BT BBU243

**** SPARTACUS 86/653 RH C317158 DNA 9A**
DAVID C BROWN BEEFMASTERS U 1/3 5/93 BT 3116A
BOMB SHELL 396 LE C742387 DNA 313359A
COTTAGE FARM U 1/2 10/00 BT 6758B
**** SEX APPEAL 062/0 LH C453999**
ADAIR U 1/2 4/92 BT 4709A

LOT 24

**BOUNDS SWINGING B RANCH – BRED
MACKIE & NORMA JEAN BOUNDS**

ID#: SUNSPOT 911
BREEDER: RJR
BBU#: 992426
DOB: 4-15-09
COLOR: BLACK MUL
SAFE TO: LOGANOMICS 1015833

THIS IS WHY BULLET PROOF IS A LEGEND IN THE BREED. LOOK AT THIS STOUT, BIG BODIED, BROOD COW RIGHT HERE!! SHE IS WITHOUT QUESTION ONE OF MY FAVORITES IN THE SALE OFFERING. BULLET PROOF WITH NIRVANA ON THE BOTTOM SIDE, YOU CAN'T MISS HERE. SELLS BRED TO LOGANOMICS, A LOGAN SON. LOGANOMICS (C1015833)

ULTRASOUND EPDS				
	REA	%IMF	Rib Fat	Rump Fat
EPD	-0.16	0.1	-0.03	-0.03
ACC	PE	PE	PE	PE

EPDS						
	BW	WW	YW	MILK	TM	SC
EPD	1.0	14	17	0	7	0.4
ACC	PE	PE	PE	PE	PE	PE

SIRE: BULLET PROOF 864 LE C931489 DNA US9000957935 PV
COTTAGE FARM U 4/08

**** CJ'S DESPERADO 530 RH C631430 DNA 16C**
CLARK JONES FARMS U 1/3 11/96 BT 5760A
CJ'S BANDELERO 960 RH C809701 DNA 100A
CLARK JONES FARMS U 1/3 2/02 BT 7189A
WORK OF ART 507 LT C811580
CAIN U 1/2 8/98 BT 5694A

**** CAVALIER 19/5 LH C617557 DNA 302A**
LYR-CY U 1/2 11/96 BT 5679A
**** OASIS 655 LE C828198 DNA 251620A**
COTTAGE FARM U 1/2 2/04 BT 7828A
**** SEX LIFE 388 LE C714150 DNA 313360A**
COTTAGE FARM U 1/3 10/00 BT 6533C
**** BLACK MAGIC 120/97 LE C754207 DNA 599A**
KOOPMAN U 1/2 11/99 BT 6408A
ONYX 415-1 LE C837437 DNA 364383A
T V R U 5/03 BT 7530A

DAM: MYSTERIOUS GIRL 52/4 LE C889240 DNA 475448A PV
WILMOTH & SONS U 6/06

KITTY'S DIAMOND 11257 LE C756792
HAPPY DAY'S U 11/99
**** CAVALIER 19/5 LH C617557 DNA 302A**
LYR-CY U 1/2 11/96 BT 5679A
NIRVANA 96/1 LH C846745 DNA 314853A
WILMOTH & SONS U 5/03 BT 7788A
33/9 LH C811895
WILMOTH & SONS U 1/2 6/06 BT 7235B

LOT 25

**BOUNDS SWINGING B RANCH – BRED HEIFER
MACKIE & NORMA JEAN BOUNDS**

ID#: SWB SURPRISE 53-11
BREEDER: BOUNDS
BBU#: 1003545
DOB: 1-13-11
COLOR: RED
SAFE TO: GAME DAY 961101

**** CJS DESPERADO 530 RH C831430 DNA 16C**
CLARK JONES FARMS U 1/3 11/96 BT 5760A
CJ'S BANDELERO 960 RH C809701 DNA 100A
CLARK JONES FARMS U 1/3 2/02 BT 7189A
WORK OF ART 507 LT C811580
CAIN U 1/2 8/98 BT 5694A

SIRE: BULLET PROOF 864 LE C931489 DNA US9000957935 PV
COTTAGE FARM U 4/08

**** CAVALIER 19/5 LH C817557 DNA 302A**
LYR-CY U 1/2 11/96 BT 5679A

**** OASIS 655 LE C828198 DNA 251620A**
COTTAGE FARM U 1/2 2/04 BT 7628A

**** SEX LIFE 388 LE C714150 DNA 313360A**
COTTAGE FARM U 1/3 10/00 BT 6533C

**** CHEROKEE PHANTOM USA 122/90 LE C457159 DNA 4C**
CHANNAROCK FARM U 1/2 9/91 BT 4528A

**** CF'S GRAND CHEROKEE 346 LE C704643 DNA 306A**
COTTAGE FARM U 1/2 4/98 BT 6084A

**** SEX APPEAL 062/0 LH C453999**
ADAIR U 1/2 4/92 BT 4709A

DAM: TILY 160 LH C817945 DNA 403180A
CARLTON'S U 1/2 5/03

**** PAINTED TIGER 3-390 LH C238565 DNA US3000923**
DUNKIN FARMS U 10/85 BT 3081B

**** TIGER LILY 031 LH C483531**
LAZY X RANCH U 1/2 4/98 BT 5756A

BROWN SUGAR 811 LH C367693
LAZY X RANCH U 2/1 10/91

EPDS						
	BW	WW	YW	MILK	TM	SC
EPD	0.5	10	4	2	7	0.3
ACC	.52	.50	.48	.19	-	.28

ULTRASOUND EPDS				
	REA	%IMF	Rib Fat	Rump Fat
EPD	-0.36	-0.1	-0.14	-0.10
ACC	.42	.45	.44	.33

INDIVIDUAL PERFORMANCE RECORDS								
	BW	WW	YW	Scrotal	REA	%IMF	Rib Fat	Rump Fat
Ratio	104	103	82		82	74	49	36
Contmp.	34	20	11		11	11	11	11
Adj. Trait	61	591	626		7.85	2.11	0.12	0.15

LOT 26

**BOUNDS SWINGING B RANCH – BRED HEIFER
MACKIE & NORMA JEAN BOUNDS**

ID#: LAYLA 131
BREEDER: RJR
BBU#: 1015831
DOB: 6-6-11
COLOR: RED PAINT
SAFE TO: BRAZOS 1010297

**** GLADIATOR 8/36 LH C85998**
CIRCLE DOT U 11/80 BT 494

**** SPARTACUS 86/653 RH C317158 DNA 9A**
DAVID C BROWN BEEFMASTERS U 1/3 5/93 BT 3116A

**** DREAMLADY 2C 9-77 LH S769**
MAURICE HARRELL U 1/2 9/90 BT 2012A

SIRE: SMOOTH DELIVERY 866 LH C965869
EMMONS RANCH

EMS SMOOTHCONNECTION 698 LE C654949 DNA 4919926
WINDY HILLS U 1/2 11/97 BT 6203A

EMS BODY BY SMOOTH 0-31 LH C820410 DNA 4919925
EMMONS RANCH BT 7700A

EMS JACKIE 5-1 LS C618349
EMMONS RANCH U 1/2 11/97

**** BLACK JACK 21 LE C817059 DNA 40A**
SCHELL RANCH U 1/2 4/02 BT 7093A

JACKPOT 2/927 LE C873398 DNA 324915A PV
SCHELL RANCH U 1/2 10/04 BT 8173A

MISS STACI 927 LE C780836 DNA 39A
CLARK JONES FARMS U 1/1 4/02 BT 6981A

DAM: 807 LE C1015826
RJR

ONYX 415-1 LE C837437 DNA 364383A
T V R U 5/03 BT 7530A

MYSTERIOUS GIRL 52/4 LE C889240 DNA 475448A PV
WILMOTH & SONS U 6/06

NIRVANA 96/1 LH C846745 DNA 314853A
WILMOTH & SONS U 5/03 BT 7788A

THIS FLASHY BRED HEIFER COMBINES SPARTACUS AND BODY BY SMOOTH ON THE TOP WITH JACKPOT AND NIRVANA ON THE BOTTOM. SHE IS VERY LONG BODIED AND LEVEL IN HER DESIGN. SELLS SAFE IN CALF TO BRAZOS, A LOGAN SON. BRAZOS (C1010297).

LOT 27A

**BOUNDS SWINGING B RANCH – BRED HEIFER
MACKIE & NORMA JEAN BOUNDS**

ID#: SWB CHRISTINA 51-11
BREEDER: BOUNDS
BBU#: 1003570
DOB: 7-1-11
COLOR: PAINT
SAFE TO: BULLET PROOF 931489

**** L BAR 5502 5502 LH C663482 DNA 056071A**
* L BAR U 1/2 4/98 BT 6208A

DOC 2D-0C81 LE C893778 DNA 308374A
CHANNAROCK FARM U 1/2 8/04

PHALLON 512/7 LE C762020
CHANNAROCK FARM U 9/99

SIRE: 808 GAME DAY 808 LH C961101 DNA US3000952
CAIN

REACTION OF 956 729 253 BE C877311
CAIN BT 7921A

5123 LE C907093
CAIN

0-47 LH C836835
CASEY

**** BLACK MAGIC 120/97 LE C754207 DNA 599A**
KOOPMAN U 1/2 11/99 BT 6408A

**** BLACK JACK 21 LE C817059 DNA 40A**
SCHELL RANCH U 1/2 4/02 BT 7093A

MISS SCARLET USA 8-1 LE C757559 DNA 34A
TRENT CROMER U 1/2 4/01 BT 6562B

DAM: THE PAINT 34/5 LT C913498 DNA 638068A PV
BRADLEY'S CIRCLE J U 4/07

**** CAVALIER 19/5 LH C617557 DNA 302A**
LYR-CY U 1/2 11/96 BT 5679A

HALO 293J23 LE C801252 DNA 80A
THE HOMESTEAD U 1/1 7/02 BT 6965A

**** LADY VICTORIA 236 LE C703743**
MEADOWOOD U 12/99 BT 6586B

DNAUS9001041044PV. HERE IS A UNIQUE PICK OF BRED HEIFERS. THESE TWIN SISTERS ARE Sired BY THE PERFORMANCE KING GAME DAY. THEY ARE SUPER THICK, CORRECT, AND CLEAN IN THEIR LINES. THE BEST PART IS THAT THEY ARE BOTH CONFIRMED BRED TO THE LEGENDARY BULLET PROOF. ECD 9-6-13. BOTH HAVE BEEN DNA TESTED AND PARENT VERIFIED. CHRISTINA HAS A 1.23 RIBEYE AND A 3.51 IMF. THAT IS WHAT YOU CALL PERFORMANCE.

EPDS						
	BW	WW	YW	MILK	TM	SC
EPD	0.1	21	29	0	11	0.4
ACC	.41	.38	.38	.15	-	.23

ULTRASOUND EPDS				
	REA	%IMF	Rib Fat	Rump Fat
EPD	0.01	0.0	-0.02	0.04
ACC	.31	.34	.34	.36

INDIVIDUAL PERFORMANCE RECORDS								
	BW	WW	YW	Scrotal	REA	%IMF	Rib Fat	Rump Fat
Ratio	99	101	106		100	103	137	117
Contmp.	2	2	2		2	2	2	2
Adj. Trait	54	566	763		9.35	3.51	0.39	0.58

LOT 27B

**BOUNDS SWINGING B RANCH – BRED HEIFER
MACKIE & NORMA JEAN BOUNDS**

ID#: SHANIA T 50-11
BREEDER: BOUNDS
BBU#: 1003540
DOB: 7-1-11
COLOR: PAINT
SAFE TO: BULLET PROOF 931489

DNAUS9001041010PV. 1.38 REAWT 3.31 IMF

EPDS						
	BW	WW	YW	MILK	TM	SC
EPD	0.0	20	26	0	10	0.4
ACC	.41	.38	.38	.15	-	.23

ULTRASOUND EPDS				
	REA	%IMF	Rib Fat	Rump Fat
EPD	-0.02	-0.1	-0.20	-0.15
ACC	.31	.34	.34	.36

INDIVIDUAL PERFORMANCE RECORDS								
	BW	WW	YW	Scrotal	REA	%IMF	Rib Fat	Rump Fat
Ratio	101	99	94		100	97	63	83
Contmp.	2	2	2		2	2	2	2
Adj. Trait	53	551	682		9.44	3.31	0.18	0.41

SIRE: 808 GAME DAY 808 LH C961101 DNA US3000952
CAIN

** L BAR 5502 5502 LH C663482 DNA 056071A
* L BAR U 1/2 4/98 BT 6208A
DOC 2D-0C81 LE C893778 DNA 308374A
CHANNAROCK FARM U 1/2 8/04
PHALLON 5127 LE C762020
CHANNAROCK FARM U 9/99

5123 LE C907093
CAIN

REACTION OF 956 729 253 BE C877311
CAIN BT 7921A

0-47 LH C836835
CASEY

** BLACK MAGIC 120/97 LE C754207 DNA 599A
KOOPMAN U 1/2 11/99 BT 6408A
** BLACK JACK 21 LE C817059 DNA 40A
SCHELL RANCH U 1/2 4/02 BT 7093A

DAM: THE PAINT 34/5 LT C913498 DNA 636068A PV
BRADLEY'S CIRCLE J U 4/07

MISS SCARLET USA 8-1 LE C757559 DNA 34A
TRENT CROMER U 1/2 4/01 BT 6562B

** CAVALIER 19/5 LH C617557 DNA 302A
LYR-CY U 1/2 11/96 BT 5679A

HALO 293J23 LE C801252 DNA 80A
THE HOMESTEAD U 1/1 7/02 BT 6965A

** LADY VICTORIA 236 LE C703743
MEADOWOOD U 12/99 BT 6566B

LOT 28

**BOUNDS SWINGING B RANCH – OPEN HEIFER POLLED
MACKIE & NORMA JEAN BOUNDS**

ID#: SWB SHA 132/11
BREEDER: BOUNDS
BBU#: 1014128
DOB: 12-28-11
COLOR: PAINT

JUST SAY BULLET PROOF!! HERE IS AN OUTSTANDING POLLED BULLET PROOF DAUGHTER. SHA IS VERY BROODY, BIG RIBBED FEMALE THAT HAS A LOT OF CLASS. COMBINE BULLET PROOF WITH BLACK JACK 21 AND RED SUGAR AND YOU GET A TON OF MARKETABILITY AND PREDICTABILITY. SELLS OPEN AND READY TO BREED. ON TOP OF THAT SHE IS HALTER BROKEN! AND LOOK AT HER IMF OF A 2.94 AND SHE IS PARENT VERIFIED AND READY TO BE YOUR NEXT DONOR!!!

EPDS						
	BW	WW	YW	MILK	TM	SC
EPD	0.6	13	20	1	7	0.4
ACC	.33	.34	.33	.17	-	.21

ULTRASOUND EPDS				
	REA	%IMF	Rib Fat	Rump Fat
EPD				
ACC				

INDIVIDUAL PERFORMANCE RECORDS								
	BW	WW	YW	Scrotal	REA	%IMF	Rib Fat	Rump Fat
Ratio	100	100	100		100	100	100	100
Contmp.	1	1	1		1	1	1	1
Adj. Trait	67	422	805		9.12	2.94	0.24	0.33

SIRE: BULLET PROOF 884 LE C931489 DNA US9000957935 PV
COTTAGE FARM U 4/08

** CJS DESPERADO 530 RH C631430 DNA 16C
CLARK JONES FARMS U 1/3 11/96 BT 5760A
CJ'S BANDELERO 960 RH C809701 DNA 100A
CLARK JONES FARMS U 1/3 2/02 BT 7189A

WORK OF ART 507 LT C811580
CAIN U 1/2 8/98 BT 5694A

** CAVALIER 19/5 LH C617557 DNA 302A
LYR-CY U 1/2 11/96 BT 5679A

** OASIS 655 LE C828198 DNA 251620A
COTTAGE FARM U 1/2 2/04 BT 7628A

** SEX LIFE 388 LE C714150 DNA 313380A
COTTAGE FARM U 1/3 10/00 BT 6533C

** BLACK MAGIC 120/97 LE C754207 DNA 599A
KOOPMAN U 1/2 11/99 BT 6408A
** BLACK JACK 21 LE C817059 DNA 40A
SCHELL RANCH U 1/2 4/02 BT 7093A

DAM: SWEET SAMARA 26-6 LE C945078 DNA US4019225
D T RANCH

MISS SCARLET USA 8-1 LE C757559 DNA 34A
TRENT CROMER U 1/2 4/01 BT 6562B

** RED SUGAR 104/93 LH C529759 DNA 184A
L TWO RANCH U 1/2 11/94 BT 4550F

SWEET JUDY 88/95 LH C615695
L TWO CATTLE U 1/2 12/97 BT 8425B

** MISS JUDY 6/91 LH C459847
L TWO RANCH U 1/2 8/92 BT 4138B

LOT 29

**T5 RANCH, J.C. & TERI THOMPSON, JR.
POLLED DONOR PAIR**

ID#: 6/8
BREEDER: RICK SEEKER
BBU#: 972049
DOB: 3-30-08
COLOR: BLACK

BULL
523-3
T5 RANCH
AF
3-12-13
BLACK

OUR ACE X TIGER QUEEN DONOR. FLUSHED ONLY ONCE BUT WHAT A MOMMA SHE IS. CHECK OUT HER BULLYSEYE CALF AND HER HEIFER 459-1 THAT SELLS AS AN OPEN HEIFER IN THIS SALE AS LOT 32. 1.27 REA/CWT 3.09 IMF.

EPDS						
	BW	WW	YW	MILK	TM	SC
EPD	1.0	1	0	4	4	-0.1
ACC	.47	.51	.50	.34	-	.34

ULTRASOUND EPDS				
	REA	%IMF	Rib Fat	Rump Fat
EPD	0.15	0.0	0.11	0.02
ACC	.42	.45	.44	.45

INDIVIDUAL PERFORMANCE RECORDS								
	BW	WW	YW	Scrotal	REA	%IMF	Rib Fat	Rump Fat
Ratio		100	100		100	100	100	100
Contmp.		1	1		1	1	1	1
Adj. Trait		509	812		10.34	3.09	0.24	0.24

SIRE: BULLSEYE 946
DNA4056652

BULLET PROOF
CF 176

**BANDELERO
**OASIS
**XCITE
BOMBSHELL

DAM: 6/8 LH C972049 DNA 642833A
SEEKER

** BLACK JACK 21 LE C817059 DNA 40A
SCHELL RANCH U 1/2 4/02 BT 7093A

ACE IN THE HOLE 70/3 LE C898727 DNA 249A
TRENT CROMER U 1/2 9/06 BT 8285A

SUGAR PIE 42/01 LE C852246
TRENT CROMER U 1/2 10/04 BT 7516B

** PAINTED TIGER 3-390 LH C238565 DNA US3000923
DUNKIN FARMS U 10/85 BT 3081B

TIGER QUEEN 200 LE C759737
TRENT CROMER BT 6410A

TRENT CROMER BT 6410A

** MASON-DIXON QUEEN 3-2-6 LE C535009
CHEROKEE HILLS BT 5098D

LOT 30**T5 RANCH, J.C. & TERI THOMPSON, JR.
POLLED BRED HEIFER – POSSIBLE PAIR BY SALE**

ID#: T5 368/0
BREEDER: T5 RANCH
BBU#: 1003801
DOB: 12-7-10
COLOR: LT RED
SAFE TO: TANTAMOUNT 1003138

SYNERGY BRED POLLED HEIFER DUE TO CALF AROUND THE SALE TIME TO TANTAMOUNT, OUR ACE IN THE HOLE X

EPDS						
	BW	WW	YW	MILK	TM	SC
EPD	2.5	.14	.21	2	9	0.0
ACC	.47	.45	.45	.17	-	.24

ULTRASOUND EPDS				
	REA	%IMF	Rib Fat	Rump Fat
EPD	-0.09	-0.1	-0.03	-0.08
ACC	.39	.42	.42	.45

INDIVIDUAL PERFORMANCE RECORDS								
	BW	WW	YW	Scrotal	REA	%IMF	Rib Fat	Rump Fat
Ratio	80	103	100		89	77	95	98
Contmp.	6	7	7		7	7	7	7
Adj. Trait	85	550	704		8.69	2.5	0.22	0.29

SIRE: XEROX 2175 LE C916825 DNA 406109A PV
T V R U 1/2 8/10

** RED SUGAR 104/93 LH C529759 DNA 184A
L TWO RANCH U 1/2 11/94 BT 4550F
** SYNERGY 84/95 LH C615710 DNA 183A
L TWO CATTLE U 1/2 1/97 BT 5779A
** PRISSY LADY 117/93 LH C537931
L TWO RANCH U 1/2 9/95 BT 5207A

RONNIE 007 LH C315994
ROSEBUD U 2/89
** MAGIC MOM 72/2 LE C527692 DNA 416448A
KOOPMAN U 2/2 11/98 BT 6839A
223-0 LL C452249
CIRCLE K U 2/3 5/92
** BLACK MAGIC 120/97 LE C754207 DNA 599A
KOOPMAN U 1/2 11/99 BT 6408A
ONYX 415-1 LE C837437 DNA 364383A
T V R U 5/03 BT 7530A

DAM: 624 LE C939774
T V R

KITTY'S DIAMOND 11257 LE C756792
HAPPY DAY'S U 11/99
** SYNERGY 84/95 LH C615710 DNA 183A
L TWO CATTLE U 1/2 1/97 BT 5779A
SIERRA 91/99 LH C790043
L TWO RANCH U 2/00 BT 6925C
** FARRAH LADY 2/92 LH C490622 DNA 205A
L TWO RANCH U 1/3 8/93 BT 4465A

LOT 31**T5 RANCH, J.C. & TERI THOMPSON, JR.
OPEN HEIFER – POLLED**

ID#: T5 436-1
BREEDER: T5 RANCH
BBU#: 1014714
DOB: 11-11-11
COLOR: DUN

A POLLED RIO DAUGHTER OUT OF A CRIMSON WARRIOR DAUGHTER. HER MATERNAL SIDE GOES BACK TO SOME OF MY BEEFMASTER COWS PURCHASED IN THE 90'S INCLUDING SISTER SALLEY. LONGEVITY BUILT IN. 1.33 REA/CWT.

EPDS						
	BW	WW	YW	MILK	TM	SC
EPD	-1.1	.10	.18	0	4	0.2
ACC	.48	.45	.44	.21	-	.23

ULTRASOUND EPDS				
	REA	%IMF	Rib Fat	Rump Fat
EPD	0.09	0.1	0.06	-0.01
ACC	.34	.38	.36	.39

INDIVIDUAL PERFORMANCE RECORDS								
	BW	WW	YW	Scrotal	REA	%IMF	Rib Fat	Rump Fat
Ratio	101	90	96		90	96	127	99
Contmp.	5	4	4		4	4	4	4
Adj. Trait	69	405	627		8.31	1.54	0.19	0.21

SIRE: RIO GRANDE SR 3184 LE C889892 DNA 542A
SPEAR RANCHES U 1/2 6/08 BT 8243A

SALSA 94-403 LH C567901
S M U 1/3 12/95 BT 5357A
9020 LH C798779 DNA 314158A
SPEAR RANCHES U 1/2 12/02 BT 7545A
5130-2C LE S19005
SPEAR RANCHES U 12/03 BT 8055A

13/3 LH C588575
ADAIR
7098-2C LH S19976
SPEAR RANCHES
1167 LH F30203
SPEAR RANCHES

DAM: 24/4 RH C898616
T FIVE U 1/2 11/08

** CRIMSON WARRIOR 4/20 LH C46590
* CIRCLE DOT U 10/75 BT 609
43/2 LH C494361
BRYAN RANCH U 2/2 1/94
** 38-5 RH C891247 DNA 741A
ADAMS ROCKING J U 2/2 10/97 BT 8056A
** SISTER SALLEY 7/485 RH C329076
DAVID C BROWN BEEFMASTERS U 2/2 7/93

LOT 32**T5 RANCH, J.C. & TERI THOMPSON, JR.
OPEN HEIFER – POLLED**

ID#: T5 459-1
BREEDER: T5 RANCH
BBU#: 1017198
DOB: 12-8-11
COLOR: RED WUL

REA/CWT 1.47!! WHO DAT ON TOP OF ACE GIVES YOU SUGAR PIE AND INFINITY BRED IN TWICE ON THIS PEDIGREE. ADD PAINTED TIGER, POLLED MANDATE AND RICK SEEKER'S TIGER QUEEN DONOR AND THIS IS A PRETTY GOOD RESULT. DAM SELLS AS LOT 29

EPDS						
	BW	WW	YW	MILK	TM	SC
EPD	2.7	5	9	3	6	-0.2
ACC	.45	.39	.36	.17	-	.23

ULTRASOUND EPDS				
	REA	%IMF	Rib Fat	Rump Fat
EPD	0.15	-0.1	0.04	0.00
ACC	.23	.23	.23	.23

INDIVIDUAL PERFORMANCE RECORDS								
	BW	WW	YW	Scrotal	REA	%IMF	Rib Fat	Rump Fat
Ratio	87	96	100		100	100	100	100
Contmp.	5	2	1		1	1	1	1
Adj. Trait	79	468	676		9.91	1.5	0.16	0.16

SIRE: "WHO DAT" 240-9 LE C978735 DNA 608401A
T FIVE

** POLLED MANDATE 404/5 LE C705841
CHANNAROCK FARM U 1/2 4/98 BT 6226A
BLACK BAYOU 1071/3 LE C892444 DNA US3000542
CHANNAROCK FARM U 1/2 5/06 BT 8891A
** 2C48/8 LH S9887
* MULLINS U 3/3 6/91

** INFINITY 120/96 LH C706197 DNA 674A
L TWO RANCH U 1/2 12/97 BT 5956A
SUGAR PIE 42/01 LE C852246
TRENT CROMER U 1/2 10/04 BT 7516B
Q TEE PIE 13/9 LE C798178
TRENT CROMER U 9/00 BT 7223B
** BLACK JACK 21 LE C817059 DNA 40A
SCHELL RANCH U 1/2 4/02 BT 7093A
ACE IN THE HOLE 70/3 LE C898727 DNA 249A
TRENT CROMER U 1/2 9/06 BT 8285A
SUGAR PIE 42/01 LE C852246
TRENT CROMER U 1/2 10/04 BT 7516B

DAM: 6/8 LH C972049 DNA 642833A
SEEKER

** PAINTED TIGER 3-390 LH C238565 DNA US3000923
DUNKIN FARMS U 10/85 BT 3081B
TIGER QUEEN 200 LE C759737
TRENT CROMER BT 6410A
** MASON-DIXON QUEEN 3-2-6 LE C535009
CHEROKEE HILLS BT 5098D

LOT 33

**T5 RANCH, J.C. & TERI THOMPSON, JR.
OPEN HEIFER - SCURRED**

ID#: T5 484-2
BREEDER: T5 RANCH
BBU#: 1023595
DOB: 4-20-12
COLOR: BLACK WP

A VERY NICE MADE YEARLING HEIFER, 600+ POUNDS AT WEANING. DEEP FLANKED, SOGGY AND WILL MAKE A GREAT BROOD COW.

EPDS						
	BW	WW	YW	MILK	TM	SC
EPD	-0.2	0	1	4	4	-0.1
ACC	PE	PE	PE	PE	PE	PE

ULTRASOUND EPDS				
	REA	%IMF	Rib Fat	Rump Fat
EPD				
ACC				

INDIVIDUAL PERFORMANCE RECORDS								
	BW	WW	YW	Scrotal	REA	%IMF	Rib Fat	Rump Fat
Ratio	92	100						
Contmp.	2	1						
Adj. Trait	72	561						

SIRE: 231-8 RE C978741
T FIVE

DAM: 75/3 LT C883144
BRADLEY'S CIRCLE J U 1/2 11/08

**** BLACK JACK 21 LE C817059 DNA 40A**
SCHELL RANCH U 1/2 4/02 BT 7093A
ACE IN THE HOLE 70/3 LE C898727 DNA 249A
TRENT CROMER U 1/2 9/06 BT 8285A
SUGAR PIE 42/01 LE C852246
TRENT CROMER U 1/2 10/04 BT 7516B

**** INFINITY 120/96 LH C706197 DNA 674A**
L TWO RANCH U 1/2 12/97 BT 5956A
MINNIE LEE 62R10 LE C922337
THE HOMESTEAD U 3/06

MAGGIE MAE 62H17 LH C793442 DNA 1150A
THE HOMESTEAD U 12/99 BT 6764C

**** SANDMAN 10-1 LH C499023**
COTTAGE FARM U 1/2 3/93 BT 6052A

**** MR COFFEE 9006/8 LE C775045**
HARROD FARMS U 1/2 3/00 BT 6669A
MISS JF 9006 9006 LH C400697
JOE A. FESTERVAN U 1/2 11/90 BT 4389C

**** CHEROKEE PHANTOM USA 122/90 LE C457159 DNA 4C**
CHANNAROCK FARM U 1/2 9/91 BT 4528A

10/6 LT C654847
BRADLEY'S CIRCLE J U 1/3 9/97 BT 6508B
**** SWEET SENSATION 64/8 LH C419840**
FORKED DEER U 1/2 6/91 BT 3851B

LOT 34

DIAMOND L RANCH - BRED

ID#: 267-9
BREEDER: T5 RANCH
BBU#: 986686
DOB: 3-26-09
COLOR: BLACK
SAFE TO: "WHO DAT" 978735

MAGICAL FARRAH DAUGHTER OUT OF ACE-IN-THE-HOLE AND BRED TO "WHO DAT". IMF 3.26.

EPDS						
	BW	WW	YW	MILK	TM	SC
EPD	0.6	7	9	4	7	0.0
ACC	.48	.48	.48	.28	-	.34

ULTRASOUND EPDS				
	REA	%IMF	Rib Fat	Rump Fat
EPD	0.08	0.0	0.07	0.08
ACC	.42	.45	.44	.47

INDIVIDUAL PERFORMANCE RECORDS								
	BW	WW	YW	Scrotal	REA	%IMF	Rib Fat	Rump Fat
Ratio	103	113	108		96	102	100	124
Contmp.	2	2	2		2	2	2	2
Adj. Trait	65	432	675		7.15	3.26	0.1	0.18

SIRE: ACE IN THE HOLE 70/3 LE C898727 DNA 249A
TRENT CROMER U 1/2 9/06 BT 8285A

DAM: MAGICAL FARRAH 113-7 RE C949736 DNA 554112A
T FIVE U 11/07

**** BLACK MAGIC 120/97 LE C754207 DNA 599A**
KOOPMAN U 1/2 11/99 BT 6408A
**** BLACK JACK 21 LE C817059 DNA 40A**
SCHELL RANCH U 1/2 4/02 BT 7093A
MISS SCARLET USA 8-1 LE C757559 DNA 34A
TRENT CROMER U 1/2 4/01 BT 6562B

**** INFINITY 120/96 LH C706197 DNA 674A**
L TWO RANCH U 1/2 12/97 BT 5956A
SUGAR PIE 42/01 LE C852246
TRENT CROMER U 1/2 10/04 BT 7516B

Q TEE PIE 13/9 LE C798178
TRENT CROMER U 9/00 BT 7223B

**** BLACK MAGIC 120/97 LE C754207 DNA 599A**
KOOPMAN U 1/2 11/99 BT 6408A

**** BLACK JACK 21 LE C817059 DNA 40A**
SCHELL RANCH U 1/2 4/02 BT 7093A
MISS SCARLET USA 8-1 LE C757559 DNA 34A
TRENT CROMER U 1/2 4/01 BT 6562B

**** SYNERGY 84/95 LH C615710 DNA 183A**
L TWO CATTLE U 1/2 1/97 BT 5779A

MIA FARRAH 99/99 LH C790047
L TWO RANCH U 1/2 10/02 BT 7811A
**** FARRAH LADY 2/92 LH C490622 DNA 205A**
L TWO RANCH U 1/3 8/93 BT 4465A

LOT 35

DIAMOND L RANCH - BRED

ID#: 259-9
BREEDER: T5 RANCH
BBU#: 986679
DOB: 4-14-09
COLOR: RED
SAFE TO: "WHO DAT" 978735

A SOLID RED ACE DAUGHTER, EASY KEEPING YOUNG COW BRED TO "WHO DAT" FOR A FALL CALF. 3.10 IMF 1.32 REA/CWT.

EPDS						
	BW	WW	YW	MILK	TM	SC
EPD	2.1	10	14	3	8	0.0
ACC	.36	.36	.34	.26	-	.28

ULTRASOUND EPDS				
	REA	%IMF	Rib Fat	Rump Fat
EPD	0.25	0.0	0.07	0.03
ACC	.28	.28	.28	.28

INDIVIDUAL PERFORMANCE RECORDS								
	BW	WW	YW	Scrotal	REA	%IMF	Rib Fat	Rump Fat
Ratio	100	100	100		100	100	100	100
Contmp.	1	1	1		1	1	1	1
Adj. Trait	64	474	663		8.78	3.1	0.15	0.24

SIRE: ACE IN THE HOLE 70/3 LE C898727 DNA 249A
TRENT CROMER U 1/2 9/06 BT 8285A

DAM: MISS BIRDIE 1/34-9 LE C849064 DNA 554111A
SCHELL RANCH U 1/1 11/08

**** BLACK MAGIC 120/97 LE C754207 DNA 599A**
KOOPMAN U 1/2 11/99 BT 6408A
**** BLACK JACK 21 LE C817059 DNA 40A**
SCHELL RANCH U 1/2 4/02 BT 7093A
MISS SCARLET USA 8-1 LE C757559 DNA 34A
TRENT CROMER U 1/2 4/01 BT 6562B

**** INFINITY 120/96 LH C706197 DNA 674A**
L TWO RANCH U 1/2 12/97 BT 5956A

SUGAR PIE 42/01 LE C852246
TRENT CROMER U 1/2 10/04 BT 7516B

Q TEE PIE 13/9 LE C798178
TRENT CROMER U 9/00 BT 7223B

**** RANGER'S PRIDE 815/9 LH C127934 DNA 15B**
* THOMPSON - ROCKING T U 9/88 BT 1728A

**** SCARLET'S PRIDE 4101 LH C577841 DNA US3000459**
M J CATTLE COMPANY U 1/2 12/95 BT 5614A

**** MISS SCARLETT 81-8 LH C392218**
COTTAGE FARM U 1/1 11/90 BT 3987A

**** SIR KIFFER 6/3 LH C548659**
ADAIR U 1/2 1/95 BT 4906A

BIRDIE 34/9 LH C802931
C G BAR RANCH U 1/2 4/02 BT 8469A
**** LADY TIGER 26 LS C453152**
CLAYTON GIBSON U 1/2 8/92 BT 5059A

LOT 36

DIAMOND L RANCH – BRED

ID#: 261-9
BREEDER: T5 RANCH
BBU#: 986681
DOB: 4-15-09
COLOR: BLACK SF MUL
SAFE TO: BULLSEYE 983094

A BLACK VERSION OF THE PREVIOUS COW, SAME EASY KEEPING QUALITY BUT BRED TO BULLSEYE. 1.28 REA/CWT.

EPDS						
	BW	WW	YW	MILK	TM	SC
EPD	1.6	8	13	3	7	0.0
ACC	.51	.47	.42	.26	-	.31

ULTRASOUND EPDS				
	REA	%IMF	Rib Fat	Rump Fat
EPD	0.24	0.0	0.07	0.03
ACC	.29	.28	.28	.28

INDIVIDUAL PERFORMANCE RECORDS								
	BW	WW	YW	Scrotal	REA	%IMF	Rib Fat	Rump Fat
Ratio	107	100	100		100	100	100	100
Contmp.	6	3	1		1	1	1	1
Adj. Trait	66	561	765		10.01	2.5	0.14	0.24

SIRE: ACE IN THE HOLE 70/3 LE C898727 DNA 249A
 TRENT CROMER U 1/2 9/06 BT 8285A

**** BLACK MAGIC 120/97 LE C754207 DNA 599A**
 KOOPMAN U 1/2 11/99 BT 6408A
**** BLACK JACK 21 LE C817059 DNA 40A**
 SCHELL RANCH U 1/2 4/02 BT 7093A
MISS SCARLET USA 8-1 LE C757559 DNA 34A
 TRENT CROMER U 1/2 4/01 BT 6562B

**** INFINITY 120/96 LH C706197 DNA 674A**
 L TWO RANCH U 1/2 12/97 BT 5956A

SUGAR PIE 42/01 LE C852246
 TRENT CROMER U 1/2 10/04 BT 7516B

Q TEE PIE 13/9 LE C798178
 TRENT CROMER U 9/00 BT 7223B

**** RANGER'S PRIDE 815/9 LH C127934 DNA 15B**
 * THOMPSON - ROCKING T U 9/88 BT 1728A

**** SCARLET'S PRIDE 4101 LH C577841 DNA US3000459**
 M J CATTLE COMPANY U 1/2 12/95 BT 5614A
**** MISS SCARLETT 81-8 LH C392218**
 COTTAGE FARM U 1/1 11/90 BT 3987A

DAM: MISS BIRDIE 1/34-9 LE C849064 DNA 554111A
 SCHELL RANCH U 1/1 11/08

**** SIR KIFFER 6/3 LH C548659**
 ADAIR U 1/2 1/95 BT 4906A

BIRDIE 34/9 LH C802931
 C G BAR RANCH U 1/2 4/02 BT 8469A

**** LADY TIGER 26 LS C453152**
 CLAYTON GIBSON U 1/2 8/92 BT 5059A

LOT 37

DIAMOND L RANCH – BRED

ID#: 271-9
BREEDER: T5 RANCH
BBU#: 986690
DOB: 5-17-09
COLOR: RED
SAFE TO: BULLSEYE 983094

ANOTHER STOUT MADE ACE DAUGHTER BRED FROM THE CATHY LEE FAMILY. BRED TO BULLSEYE TO ADD BULLET PROOF AND OASIS.

EPDS						
	BW	WW	YW	MILK	TM	SC
EPD	0.9	-1	1	1	0	-0.4
ACC	.51	.39	.38	.26	-	.28

ULTRASOUND EPDS				
	REA	%IMF	Rib Fat	Rump Fat
EPD	0.15	0.0	0.08	0.05
ACC	PE	PE	PE	PE

INDIVIDUAL PERFORMANCE RECORDS								
	BW	WW	YW	Scrotal	REA	%IMF	Rib Fat	Rump Fat
Ratio	97							
Contmp.	6							
Adj. Trait	73							

SIRE: ACE IN THE HOLE 70/3 LE C898727 DNA 249A
 TRENT CROMER U 1/2 9/06 BT 8285A

**** BLACK MAGIC 120/97 LE C754207 DNA 599A**
 KOOPMAN U 1/2 11/99 BT 6408A
**** BLACK JACK 21 LE C817059 DNA 40A**
 SCHELL RANCH U 1/2 4/02 BT 7093A
MISS SCARLET USA 8-1 LE C757559 DNA 34A
 TRENT CROMER U 1/2 4/01 BT 6562B

**** INFINITY 120/96 LH C706197 DNA 674A**
 L TWO RANCH U 1/2 12/97 BT 5956A

SUGAR PIE 42/01 LE C852246
 TRENT CROMER U 1/2 10/04 BT 7516B

Q TEE PIE 13/9 LE C798178
 TRENT CROMER U 9/00 BT 7223B

**** SUGARMAN 9/89 LH C393826**
 L TWO RANCH U 1/3 9/90 BT 3631A

**** SHILOH 483 LH C567004**
 CAIN U 1/2 6/95 BT 5369E

**** 3033 LH C400050**
 THOMPSON - ROCKING T U 1/1 4/92 BT 3938A

DAM: 5/7 LH C735627 DNA 300968A
 HARROD FARMS U 1/3 12/99 BT 6825A

**** RANGER'S PRIDE 815/9 LH C127934 DNA 15B**
*** THOMPSON - ROCKING T U 9/88 BT 1728A**

**** CATHY LEE 359 LT C438678**
 CAIN U 1/2 4/92 BT 4760B

**** 6-2 LH C186819**
 EDUCATIONAL MTRLS. & SERV. U 4/83 BT 2434A

LOT 38

HILL SIDE FARM – 3 - N - 1

ID#: 13-6
BREEDER: NORRIS
BBU#: 928976
DOB: 6-17-06
COLOR: RED WUL
CLASSIFIED: U
SAFE TO: WILDCARD 991140

HEIFER
 327
 HILL SIDE FARM
 1023788
 12-3-12
 RED

A 3 N 1 THAT BRED RIGHT BACK. CHECK OUT THE GREATS IN THE PEDIGREE. CALVING AT THE RIGHT TIME. HEIFER CALF AT SIDE AND BRED BACK. MONEY MAKING COW. 1.45 REA/CWT!

EPDS						
	BW	WW	YW	MILK	TM	SC
EPD	1.3	2	3	-4	-3	-0.3
ACC	.28	.26	.24	.19	-	.17

SIRE: HSF WILDCARD 915 LH C991140
 HILL SIDE FARM

**** BLACK JACK 21 LE C817059 DNA 40A**
 SCHELL RANCH U 1/2 4/02 BT 7093A
ACE IN THE HOLE 70/3 LE C898727 DNA 249A
 TRENT CROMER U 1/2 9/06 BT 8285A
SUGAR PIE 42/01 LE C852246
 TRENT CROMER U 1/2 10/04 BT 7516B

**** CAVALIER 19/5 LH C617557 DNA 302A**
 L YR-CY U 1/2 11/96 BT 5679A

SPANK ME 658 LE C828199 DNA 421A
 COTTAGE FARM U 1/2 10/02 BT 8524A

**** SEX LIFE 388 LE C714150 DNA 313380A**
 COTTAGE FARM U 1/3 10/00 BT 6533C

**** BLACK MAGIC 120/97 LE C754207 DNA 599A**
 KOOPMAN U 1/2 11/99 BT 6408A

M G D 3-04 LE C899735 DNA 567A
 NORRIS FARMS U 1/3 3/06 BT 8761A

**** MORNING GLORY 3033J4 LE C801650 DNA US4091258**
 THE HOMESTEAD U 1/2 3/03 BT 6930D

DAM: 13-6 LE C928976
 NORRIS FARMS U 3/08

MISS CJ 161 161 LE C863822
 CLARK JONES U 7/03 BT 7626A

**** XCITE 497 LE C793242 DNA 247A**
 COTTAGE FARM U 1/2 10/00 BT 6780A

SEX GODESS 398 LE C773489
 COTTAGE FARM U 1/2 7/03 BT 6954B

LOT 39

HILL SIDE FARM – 3 - N - 1

ID#: 1836X
BREEDER: CHARLES JONES
BBU#: 997596
DOB: 4-3-10
COLOR: RED
SAFE TO: WILDCARD 991140

HEIFER
 313
 HILL SIDE FARM
 1023787
 10-25-12
 RED

SIRE: **** THE POSTMAN 465/6 LE C735644 DNA 536060A**
 CHANNAROCK FARM U 1/2 9/98 BT 6686A

**** PAINTED WARRIOR 0026 RH C134634**
 BARFIELD U 1/81 BT 535
**** PAINTED TIGER 3-390 LH C238565 DNA US3000923**
 DUNKIN FARMS U 10/85 BT 3081B
**** 1-126 LH C166366**
 DUNKIN FARMS U 1/3 9/90 BT 3535A

**** CHEROKEE PHANTOM USA 122/90 LE C457159 DNA 4C**
 CHANNAROCK FARM U 1/2 9/91 BT 4528A
**** TRIBAL PRINCESS 291/3 LE C620695**
 CHANNAROCK FARM U 1/2 12/95 BT 5489A
**** 105/9 LE C451412**
 CHANNAROCK FARM U 1/2 4/91 BT 4536B
**** L BAR 5502 5502 LH C663482 DNA 056071A**
*** L BAR U 1/2 4/98 BT 6208A**
DOC 2D-0C81 LE C893778 DNA 308374A

CHANNAROCK FARM U 1/2 8/04
 PHALLON 512/7 LE C762020
 CHANNAROCK FARM U 9/99

DAM: **CHRK 1836X 1836X LE C997596**
 CHANNAROCK FARM

C.J'S BANDELERO 960 RH C809701 DNA 100A
 CLARK JONES FARMS U 1/3 2/02 BT 7189A
 950/2 LE C881148 DNA 392296A
 CHANNAROCK FARM U 1/3 8/07 BT 8207A
11 LE C856093
 CHANNAROCK FARM

HIGH EPD FIRST CALF HEIFER WITH A POSTMAN HEIFER CALF. BRED RIGHT BACK TO WILDCARD OUR ACE IN THE HOLE SON OUT OF OASIS'S FULL SISTER, SPANK ME. MONEY MAKER.

EPDS						
	BW	WW	YW	MILK	TM	SC
EPD	-1.2	30	45	-9	6	1.1
ACC	.52	.51	.51	.28	.	.36

ULTRASOUND EPDS				
	REA	%IMF	Rib Fat	Rump Fat
EPD	0.46	0.0	0.01	0.22
ACC	.45	.48	.47	.50

INDIVIDUAL PERFORMANCE RECORDS								
	BW	WW	YW	Scrotal	REA	%IMF	Rib Fat	Rump Fat
Ratio	104	94	102		115	75	110	120
ConImp.	15	19	17		17	17	17	17
Adj. Trait	62	603	877		12.74	2.67	0.32	0.54

LOT 40

HILL SIDE FARM – OPEN HEIFER

ID#: LILLYBELLE 3541
BREEDER: TAYLOR GREEN
BBU#: 1013911
DOB: 11-15-11
COLOR: ROAN

THIS HEIFER WAS RAISED AND SHOWN BY JILLIANNE JACKO FROM HARKER HEIGHTS. BULLET PROOF AND MOLLY MOO IS A GREAT CROSS. READY TO BREED AND CONTINUE TO SHOW.

ULTRASOUND EPDS				
	REA	%IMF	Rib Fat	Rump Fat
EPD	0.02	0.1	0.01	0.03
ACC	PE	PE	PE	PE

EPDS						
	BW	WW	YW	MILK	TM	SC
EPD	1.4	16	19	2	10	0.4
ACC	PE	PE	PE	PE	PE	PE

SIRE: **BULLET PROOF 864 LE C931489 DNA US9000957935 PV**
 COTTAGE FARM U 4/08

**** C.J'S DESPERADO 530 RH C631430 DNA 18C**
 CLARK JONES FARMS U 1/3 11/96 BT 5760A
C.J'S BANDELERO 960 RH C809701 DNA 100A
 CLARK JONES FARMS U 1/3 2/02 BT 7189A
WORK OF ART 507 LT C611580
 CAIN U 1/2 8/98 BT 5694A

**** CAVALIER 19/5 LH C617557 DNA 302A**
 LYR-CY U 1/2 11/96 BT 5679A
**** OASIS 655 LE C828198 DNA 251820A**
 COTTAGE FARM U 1/2 2/04 BT 7628A
**** SEX LIFE 388 LE C714150 DNA 313360A**
 COTTAGE FARM U 1/3 10/00 BT 6533C
**** BLACK JACK 21 LE C817059 DNA 40A**
 SCHELL RANCH U 1/2 4/02 BT 7093A
ACE IN THE HOLE 70/3 LE C898727 DNA 249A
 TRENT CROMER U 1/2 9/06 BT 8285A
 SUGAR PIE 42/01 LE C852246
 TRENT CROMER U 1/2 10/04 BT 7516B

DAM: **MOLLY MOO 10 LE C948100 DNA US9000957566 PV**
 TAYLOR GREEN

BLACK LAZER 619 LH C695578 DNA 385847A
 PURVIS FARMS BT 6190A
BLACK BAYOU 610 LE C886931 DNA 737A
BLACK DIAMOND U 5/05 BT 8969A
BLACK BEAUTY 727 LE C829217
 BLACK DIAMOND U 1/2 9/04 BT 7976A

LOT 41

MANETH FARMS BEEFMASTERS - PAIR

ID#: 821/10
BREEDER: MANETH FARMS
BBU#: 1009935
DOB: 8-21-10
COLOR: RED WUL

HEIFER
 D1812
 MANETH FARMS
 1023719
 12-18-12
 RED

SIRE: **106 LE C997666**
 CEDAR VALLEY FARM

821/10 IS LIKE HER MOTHER AND IS AN EASY KEEPER.

EPDS						
	BW	WW	YW	MILK	TM	SC
EPD	0.1	20	27	-2	8	0.6
ACC	PE	PE	PE	PE	PE	PE

DAM: **821/10 LE C1009935**
 MANETH

BLACK BAYOU 1071/3 LE C892444 DNA US3000542
 CHANNAROCK FARM U 1/2 5/06 BT 8891A
CHRK GENESIS 1500T 1500T LE C955208 DNA US3000546 PV
 CHANNAROCK FARM U 1/2 6/10
**** CHRK MISS REBA 1194/5 LE C913104 DNA 343748A PV**
 CHANNAROCK FARM U 1/2 6/10 BT BBU353
**** POLLED MANDATE 404/5 LE C705841**
 CHANNAROCK FARM U 1/2 4/98 BT 6226A
MONICA 1308/5 LE C930453
 CHANNAROCK FARM
LITTLE MATHEA 1040/3 LE C892467
 CHANNAROCK FARM
**** BLACK JACK 21 LE C817059 DNA 40A**
 SCHELL RANCH U 1/2 4/02 BT 7093A
ACE IN THE HOLE 70/3 LE C898727 DNA 249A
 TRENT CROMER U 1/2 9/06 BT 8285A
 SUGAR PIE 42/01 LE C852246
 TRENT CROMER U 1/2 10/04 BT 7516B

DOC 2D-0C81 LE C893778 DNA 308374A
 CHANNAROCK FARM U 1/2 8/04
DOC'S DOTTIR 1184/4 LE C913099 DNA US4019090 PV
 CHANNAROCK FARM U 1/1 8/07
809/0 LE C845254 DNA 348563A
 CHANNAROCK FARM U 1/2 8/04

LOT 42

**MANETH FARMS BEEFMASTERS
POLLED BRED HEIFER**

ID#: 3241
BREEDER: MANETH FARMS
BBU#: 1000673
DOB: 3-24-11
COLOR: LT RED
SAFE TO: CEDAR VALLEY 106 997666

BRED TO OUR GENESIS SON 106 BBU# C997666. THIS OFFERING IS FROM OUR DONOR SYNTRITO OUT OF BANDITO AND 33/9 GOING BACK TO SYNERGY AND L2 VICTORS SISTER 45/93.

ULTRASOUND EPDS				
	REA	%IMF	Rib Fat	Rump Fat
EPD	0.28	-0.1	-0.01	-0.08
ACC	PE	PE	PE	PE

EPDS						
	BW	WW	YW	MILK	TM	SC
EPD	-0.1	10	18	3	8	0.3
ACC	PE	PE	PE	PE	PE	PE

SIRE: RED RYDER 8035 LE C968245 DNA US3000514 PV
EMMONS RANCH

** POLLED MANDATE 404/5 LE C705841
CHANNAROCK FARM U 1/2 4/98 BT 6226A
BLACK BAYOU 1071/3 LE C892444 DNA US3000542
CHANNAROCK FARM U 1/2 5/08 BT 8891A
** 2C46/8 LH 99887
* MULLINS U 3/3 6/91

ACE IN THE HOLE 70/3 LE C898727 DNA 249A
TRENT CROMER U 1/2 9/06 BT 8285A
EMS AMAZING ACE 630 LE C930525 DNA 991A
EMMONS RANCH

EMS MISS BUFF 86-6 LE C638483 DNA 4919923
DIAMOND M U 1/3 11/97 BT 7699A

CJ'S BANDELERO 980 RH C809701 DNA 100A
CLARK JONES FARMS U 1/3 2/02 BT 7189A

BANDITO 958/2 LE C881173 DNA US3000920
CHANNAROCK FARM U 8/04 BT 8131A

ANNIE MAE 517 H LE C843800 DNA 300210A
CHANNAROCK FARM U 1/2 8/02 BT 7337B

DAM: 119/5 LH C935087 DNA 419936A
WILMOTH & SONS U 1/2 1/08

** SYNERGY 84/95 LH C615710 DNA 183A
L TWO CATTLE U 1/2 1/97 BT 5779A

33/9 LH C811895

WILMOTH & SONS U 1/2 6/06 BT 7235B

** L2 VICTOR'S SISTER 45/93 LH C538973 DNA 634496A
L TWO RANCH U 1/2 11/94 BT 4841C

LOT 43

**ARMATY'S FIVE A RANCH, MAX ARMATYS
BRED HEIFER**

ID#: 5A HEARTBREAKER 2211
BREEDER: ARMATYS
BBU#: 1009388
DOB: 7-4-11
COLOR: RED
SAFE TO: ENTOURAGE 1000941

PAINTED TIGER AND CAPTAIN LUCEY CROSS. BRED TO ENTOURAGE, THE 2013 NBBC PERFORMANCE CHAMPION BULL WITH A REA/CWT OF 1.80.

EPDS						
	BW	WW	YW	MILK	TM	SC
EPD	1.3	8	13	1	5	0.1
ACC	.34	.21	.19	.14	-	.15

ULTRASOUND EPDS				
	REA	%IMF	Rib Fat	Rump Fat
EPD				
ACC				

INDIVIDUAL PERFORMANCE RECORDS								
	BW	WW	YW	Scrotal	REA	%IMF	Rib Fat	Rump Fat
Ratio	99							
Contmp.	2							
Adj. Trait	69							

SIRE: CAT IN THE HAT 987 LE C959799 DNA 9000019562 PV
T V R

** PAINTED WARRIOR 0026 RH C134634
BARFIELD U 1/81 BT 535
** PAINTED TIGER 3-390 LH C238565 DNA US3000923
DUNKIN FARMS U 10/85 BT 3081B

** 1-126 LH C166366

DUNKIN FARMS U 1/3 9/90 BT 3535A

** SYNERGY 84/95 LH C615710 DNA 183A

L TWO CATTLE U 1/2 1/97 BT 5779A

MM'S MASTERPIECE 2165 LE C916827 DNA 843A
T V R BT 9107A

** MAGIC MOM 72/2 LE C527692 DNA 416448A
KOOPTMAN U 2/2 11/98 BT 6839A

** INFINITY 120/96 LH C706197 DNA 674A

L TWO RANCH U 1/2 12/97 BT 5956A

L2 CAPTAIN LUCEY 116/01 LH C844030 DNA 133A

L TWO RANCH U 1/2 10/06 BT 7402A

** MILK & HONEY 45/98 LH C763541 DNA 112A

L TWO RANCH U 1/2 12/00 BT 6614B

DAM: BF25/07 LH C966346
BAILEY FARM U 12/08

CJ'S CEASAR 967 RH C809697 DNA 334869A
CLARK JONES FARMS U 1/2 2/02 BT 7106A

1849/3 LH C889884
H M S U 1/3 7/06

** T149 BE C454402

THORNBUSH U 1/1 7/93 BT 4941A

LOT 44

**ARMATY'S FIVE A RANCH, MAX ARMATYS
POLLED BRED HEIFER**

ID#: 5A SWEET ROBIN
BREEDER: ARMATYS
BBU#: 1009937
DOB: 8-5-11
COLOR: BRINDLE
SAFE TO: ENTOURAGE 1000941

LINE BRED BLACK JACK AND POLLED. BRED TO ENTOURAGE. BIRTH WEIGHT 76 LBS.

EPDS						
	BW	WW	YW	MILK	TM	SC
EPD	1.3	5	11	2	4	-0.3
ACC	.31	.17	.17	.10	-	.10

SIRE: THUNDER JOE 1223/7 LE C974948
MANETH

** BLACK JACK 21 LE C817059 DNA 40A
SCHELL RANCH U 1/2 4/02 BT 7093A

MO-JO 1204/5 LE C913181 DNA 961A

CHANNAROCK FARM U 2/06 BT 9256A

ANNIE MAE 517 H LE C843800 DNA 300210A

CHANNAROCK FARM U 1/2 8/02 BT 7337B

** BLACK MAGIC 120/97 LE C754207 DNA 599A

KOOPTMAN U 1/2 11/99 BT 6408A

THUNDER LADY 1200 LE C927954 DNA 419935A

TRUELOVE U 1/2 11/06

LAZER LADY 13/0 LH C828331

VALLEY RANCH U 5/01 BT 7728A

CJ'S SOUL MAN 168 RH C867835 DNA US3000427

CLARK JONES FARMS U 1/2 2/04 BT 7670A

ROCKIN-ROBBIN 501 RE C915859 DNA 295186A PV

CASTLEMAN U 1/3 6/07 BT BBU34

TESS 512 LE C843939 DNA 88A

BLACK DIAMOND BT 8051A

DAM: GM 1 1122/8 LE C1000669
MANETH

** BLACK JACK 21 LE C817059 DNA 40A

SCHELL RANCH U 1/2 4/02 BT 7093A

DEALMEIN 145 LE C871177 DNA 537912A

DOUBLE T RANCH U 11/03 BT 8163A

105 LH C838543

DOUBLE T RANCH U 8/03

LOT 45

**ARMATY'S FIVE A RANCH, MAX ARMATYS
BRED HEIFER**

ID#: PRISSY CAT 3111
BREEDER: ARMATYS
BBU#: 1009393
DOB: 11-15-11
COLOR: RED
SAFE TO: ENTOURAGE 1000941

NOTICE MISS PRISSY AND THE FULL SISTER TO ACE IN THE HOLE REPRESENTED. BRED TO ENTOURAGE, GOOD EPD'S.

EPDS						
	BW	WW	YW	MILK	TM	SC
EPD	0.0	16	21	2	10	0.4
ACC	.38	.28	.26	.12	-	.19

ULTRASOUND EPDS				
	REA	%IMF	Rib Fat	Rump Fat
EPD				
ACC				

INDIVIDUAL PERFORMANCE RECORDS								
	BW	WW	YW	Scrotal	REA	%IMF	Rib Fat	Rump Fat
Ratio	93							
Contmp.	2							
Adj. Trait	78							

SIRE: MR C.J. 847 847 LE C976144
 CLARK JONES

DAM: PRISSY'S WORK OF ART PW/345 LE C928388
 HARROD FARMS U 4/07

C.J'S SOUL MAN 168 RH C867835 DNA US3000427
 CLARK JONES FARMS U 1/2 2/04 BT 7670A
 C.J'S MOTOWN 412 LE C901889 DNA US3000443
 LAZY SUZAN RANCH U 1/3 5/06 BT 8804A
 LAURIE BABY 14/2 LE C851607 DNA 1142A
 ADAIR U 7/03 BT 7371D

** BLACK JACK 21 LE C817059 DNA 40A
 SCHELL RANCH U 1/2 4/02 BT 7093A
 CIRCLE C 109/5 109/5 LE C921708
 TRENT CROMER U 1/3 5/08
 SUGAR PIE 42/01 LE C852246
 TRENT CROMER U 1/2 10/04 BT 7516B
 C.J'S BANDELERO 960 RH C809701 DNA 100A
 CLARK JONES FARMS U 1/3 2/02 BT 7189A
 BANDITO 958/2 LE C881173 DNA US3000920
 CHANNAROCK FARM U 8/04 BT 8131A
 ANNIE MAE 517 H LE C843800 DNA 300210A
 CHANNAROCK FARM U 1/2 8/02 BT 7337B

DIAMOND RIO 6318 LH C668992
 CUMBERLAND MOUNTAIN U 1/3 6/98 BT 5765A
 PRISSY 293 293/0 LE C815979
 HARROD FARMS U 1/3 10/10 BT 7376B
 MISS PRISSY 112/93 LH C537932
 L TWO RANCH U 1/2 5/95 BT 4993B

LOT 46

**DUN ROVIN RANCH – SISTER GROVE RANCH
BRED HEIFER**

ID#: 1143
BREEDER: HG & JILL GRIFFIN
BBU#: 1009980
DOB: 3-21-11
COLOR: BLACK
SAFE TO: APPRENTICE 985938

LONG BODIED HEIFER BY OUR GREAT DONOR COW, AMAZING EMMA. THIS HEIFER HAS EMMONS RANCH BREEDING, BOTH TOP AND BOTTOM.

EPDS						
	BW	WW	YW	MILK	TM	SC
EPD	2.0	16	16	2	10	0.5
ACC	.48	.47	.45	.14	-	.26

ULTRASOUND EPDS				
	REA	%IMF	Rib Fat	Rump Fat
EPD	0.06	0.0	-0.03	-0.14
ACC	.38	.42	.41	.44

INDIVIDUAL PERFORMANCE RECORDS								
	BW	WW	YW	Scrotal	REA	%IMF	Rib Fat	Rump Fat
Ratio	99	91	93		90	93	82	78
Contmp.	5	4	4		4	4	4	4
Adj. Trait	69	437	713		7.74	2.31	0.21	0.34

SIRE: EMS SMOOTH CAVALIER 708 LH C953094 DNA US3000910 PV
 EMMONS RANCH

DAM: AMAZING EMMA 8031 LE C968237 DNA 511377A PV
 EMMONS RANCH

** SPARTACUS 86/653 RH C317158 DNA 9A
 DAVID C BROWN BEEFMASTERS U 1/3 5/93 BT 3116A
 ** CAVALIER 19/5 LH C617557 DNA 302A
 LYR-CY U 1/2 11/96 BT 5679A
 ** 1-5/5 LH C245236
 LAZY M U 1/2 4/91 BT 2171A

EMS SMOOTH CONNECTION 698 LE C654949 DNA 4919926
 WINDY HILLS U 1/2 11/97 BT 6203A
 EMS BODY BY SMOOTH 0-31 LH C820410 DNA 4919925
 EMMONS RANCH BT 7700A
 EMS JACKIE 5-1 LS C618349
 EMMONS RANCH U 1/2 11/97
 ** POLLED MANDATE 404/5 LE C705841
 CHANNAROCK FARM U 1/2 4/98 BT 6226A
 BLACK BAYOU 1071/3 LE C892444 DNA US3000542
 CHANNAROCK FARM U 1/2 5/06 BT 8891A
 ** 2C46/8 LH S9887
 * MULLINS U 3/3 6/91

ACE IN THE HOLE 70/3 LE C898727 DNA 249A
 TRENT CROMER U 1/2 9/06 BT 8285A
 EMS AMAZING ACE 630 LE C930525 DNA 991A
 EMMONS RANCH
 EMS MISS BUFF 86-6 LE C638483 DNA 4919923
 DIAMOND M U 1/3 11/97 BT 7699A

LOT 47

**DUN ROVIN RANCH – SISTER GROVE RANCH
EXPOSED HEIFER**

ID#: EMMA JANE RHGI
BREEDER: JERRY D. RONQUILLE
BBU#: 1015155
DOB: 10-3-11
COLOR: BLACK
EXPOSED TO: WHO DAT 978735

GOOD HEIFER FROM OUR EXCEPTIONAL DONOR COW AMAZING EMMA. PASTURE BRED TO WHO DAT GREAT EPDS. 1.35 REA/CWT 3.55 IMF.

EPDS						
	BW	WW	YW	MILK	TM	SC
EPD	1.6	11	12	1	6	0.0
ACC	.47	.47	.45	.19	-	.26

ULTRASOUND EPDS				
	REA	%IMF	Rib Fat	Rump Fat
EPD	0.10	0.0	0.01	-0.12
ACC	.38	.42	.41	.44

INDIVIDUAL PERFORMANCE RECORDS								
	BW	WW	YW	Scrotal	REA	%IMF	Rib Fat	Rump Fat
Ratio	98	90	92		92	114	94	75
Contmp.	4	4	4		4	4	4	4
Adj. Trait	69	380	673		9.07	3.55	0.18	0.26

SIRE: BLACK CAVALIER 19/4 LE C888745 DNA 409A
 HARROD FARMS U 10/04 BT 8508A

DAM: AMAZING EMMA 8031 LE C968237 DNA 511377A PV
 EMMONS RANCH

** SPARTACUS 86/653 RH C317158 DNA 9A
 DAVID C BROWN BEEFMASTERS U 1/3 5/93 BT 3116A
 ** CAVALIER 19/5 LH C617557 DNA 302A
 LYR-CY U 1/2 11/96 BT 5679A
 ** 1-5/5 LH C245236
 LAZY M U 1/2 4/91 BT 2171A

RONNIE 007 LH C315994
 ROSEBUD U 2/89
 ** MAGIC MOM 72/2 LE C527692 DNA 416448A
 KOOPMAN U 2/2 11/98 BT 6839A
 223-0 LL C452249
 CIRCLE K U 2/3 5/92
 ** POLLED MANDATE 404/5 LE C705841
 CHANNAROCK FARM U 1/2 4/98 BT 6226A
 BLACK BAYOU 1071/3 LE C892444 DNA US3000542
 CHANNAROCK FARM U 1/2 5/06 BT 8891A
 ** 2C46/8 LH S9887
 * MULLINS U 3/3 6/91

ACE IN THE HOLE 70/3 LE C898727 DNA 249A
 TRENT CROMER U 1/2 9/06 BT 8285A
 EMS AMAZING ACE 630 LE C930525 DNA 991A
 EMMONS RANCH
 EMS MISS BUFF 86-6 LE C638483 DNA 4919923
 DIAMOND M U 1/3 11/97 BT 7699A

LOT 48

STEVE & PEGGY DOTY – OPEN HEIFER

ID#: 10211
 BREEDER: DOTY
 BBU#: 1009522
 DOB: 10-21-11
 COLOR: RED BRINDLE

SIRE: "WHO DAT" 240-9 LE C978735 DNA 608401A
 T FIVE

** POLLED MANDATE 404/5 LE C705841
 CHANNAROCK FARM U 1/2 4/98 BT 6226A
BLACK BAYOU 1071/3 LE C892444 DNA US3000542
 CHANNAROCK FARM U 1/2 5/06 BT 8891A
** 2C46/8 LH S9887
* MULLINS U 3/3 6/91

** INFINITY 120/96 LH C706197 DNA 674A
 L TWO RANCH U 1/2 12/97 BT 5956A
SUGAR PIE 42/01 LE C852246
 TRENT CROMER U 1/2 10/04 BT 7516B
Q TEE PIE 13/9 LE C798178
 TRENT CROMER U 9/00 BT 7223B
** P W II 340-6 BE C275257
 LA MEJOR U 1/2 6/91 BT 3290B

71/1 RH C850717
 T FIVE U 1/1 5/03

** 38-5 RH C691247 DNA 741A
 ADAMS ROCKING J U 2/2 10/97 BT 8056A

SIRED BY JC'S WHO DAT BULL AND THE 71 BULL HE USED SO WELL THAT WAS CLASSIFIED A U11

DAM: 278-9 RE C986702
 T FIVE

NOAH 220 RH C810342
 MAPLES RANCH U 1/2 5/03

32/4 RH C899295
 T FIVE U 1/2 11/08

16/0 LE C835297
 M TWO CATTLE COMPANY U 1/2 5/03

EPDS						
	BW	WW	YW	MILK	TM	SC
EPD	2.0	5	9	-1	2	-0.2
ACC	PE	PE	PE	PE	PE	PE

LOT 49

STEVE & PEGGY DOTY – OPEN HEIFER

ID#: 11281
 BREEDER: DOTY
 BBU#: 1009523
 DOB: 11-28-11
 COLOR: BLACK

SIRE: MYSTERIOUS PROOF 910 LE C996885
 R J R

CJ'S BANDELERO 960 RH C809701 DNA 100A
 CLARK JONES FARMS U 1/3 2/02 BT 7189A
BULLET PROOF 864 LE C931489 DNA US9000957935 PV
 COTTAGE FARM U 4/08

** OASIS 655 LE C828198 DNA 251620A
 COTTAGE FARM U 1/2 2/04 BT 7628A

ONYX 415-1 LE C837437 DNA 364383A
 T V R U 5/03 BT 7530A
MYSTERIOUS GIRL 52/4 LE C889240 DNA 475448A PV
 WILMOTH & SONS U 6/06

NIRVANA 96/1 LH C846745 DNA 314853A
 WILMOTH & SONS U 5/03 BT 7788A
386/1 LE C850433
 COLLIER FARMS U 1/02

568/7 LH C951904
 COLLIER FARMS

8273 LT C768893
 RANDY WITTENBURG U 4/99

TIGER II 8127 LH C789942 DNA 589103A
 T H T U 1/2 5/01 BT 7163A

CABARET 144/7 LH C972469
 COLLIER FARMS U 2/3 3/10

** KING'S LADY 764/7 LE C781840 DNA 894A
 COLLIER FARMS U 4/99 BT 9160A

SIRED BY THE GRAND CHAMPION BULL IN HOUSTON IN 2011. OUT OF A GREAT PRODUCING COLLIER COW MATERNALLY.

DAM: CHARITY 821/0 LE C987308
 COLLIER FARMS

EPDS						
	BW	WW	YW	MILK	TM	SC
EPD	0.5	9	10	0	5	0.5
ACC	PE	PE	PE	PE	PE	PE

LOT 50

KAN BEEFMASTERS, KENNETH & NANCY ALLEN

3 - N - 1

ID#: STACI STACI 208/8
 BREEDER: JT FARMS
 BBU#: 967283
 DOB: 4-22-08
 COLOR: RED
 SAFE TO: AI SMITH & WESSON 2-9-13 978568

HEIFER
 202
 KAN
 1022374
 11-4-12
 RED SF

SIRE: INTEGRITY 501 RH C918880 DNA 292777A
 DANCE CREEK U 1/2 6/06 BT BBU67

** PAINTED TIGER 3-390 LH C238585 DNA US3000923
 DUNKIN FARMS U 10/85 BT 3081B
** THE POSTMAN 465/6 LE C735844 DNA 536080A
 CHANNAROCK FARM U 1/2 9/98 BT 6886A
** TRIBAL PRINCESS 291/3 LE C820695
 CHANNAROCK FARM U 1/2 12/95 BT 5489A

** SYNERGY 84/95 LH C615710 DNA 183A
 L TWO CATTLE U 1/2 1/97 BT 5779A

** 359 RH C801003
 MAPLES RANCH U 2/00 BT 7395A

** MISS LOUIE 87/3 RH C588258
 DOS SOMBREROS RANCH U 1/2 9/95 BT 6021A

** BLACK JACK 21 LE C817059 DNA 40A
 SCHELL RANCH U 1/2 4/02 BT 7093A

GUARDIAN ANGEL 123/4 LH C905857
 J T FARMS

ANGEL EYES 206 LE C869617
 SCHELL RANCH U 1/2 1/05 BT 7862A

DAM: STACI STACI 208/8 LH C967283
 J T FARMS

** BLACK JACK 21 LE C817059 DNA 40A
 SCHELL RANCH U 1/2 4/02 BT 7093A

146/5 LH C920230
 J T FARMS

ANGEL EYES 206 LE C869617
 SCHELL RANCH U 1/2 1/05 BT 7862A

LINE BRED MISS STACI AND ANGEL EYES NOW OWNED BY JC THOMPSON. ANGEL EYES WAS ARGUABLY ONE OF THE BEST MISS STACI DAUGHTERS. EASY KEEPING CATTLE. HEIFER CALF BY INTEGRITY AI. BRED RIGHT BACK ON TIME TO SMITH & WESSON ON 2-9-13 AND CLEAN UP AFTER 2-24-13 TO BLAU 026 OUR HIGH EPD SIRE WITH +25WW AND +32 YWT. C998659

EPDS						
	BW	WW	YW	MILK	TM	SC
EPD	0.9	7	10	4	7	-0.1
ACC	.39	.41	.34	.21	-	.23

ULTRASOUND EPDS				
	REA	%MF	Rib Fat	Rump Fat
EPD				
ACC				

INDIVIDUAL PERFORMANCE RECORDS								
	BW	WW	YW	Scrotal	REA	%MF	Rib Fat	Rump Fat
Ratio	105	106						
Contmp.	2	3						
Adj. Trait	79	558						

LOT 51

**GARETH JOHNSON
OPEN HEIFER**

ID#: SWEET CAROLINE 13/12
BREEDER: JOHNSON
BBU#: 1018505
DOB: 4-25-12
COLOR: BLACK

JAZZIE AND MISS STACI BRED YEARLING HEIFER. GENTLE AND FANCY.

ACE IN THE HOLE 70/3 LE C898727 DNA 249A
TRENT CROMER U 1/2 9/06 BT 8285A
BOSSMAN 1557-6 LH C936352 DNA US9000957924 PV
SCHELL RANCH
JAZZIE 293L55 LE C857929 DNA 648896 PV
THE HOMESTEAD U 1/03 BT 7711A
**** BLACK JACK 21 LE C817059 DNA 40A**
SCHELL RANCH U 1/2 4/02 BT 7093A
STACI ANN 421 LE C908095 DNA 496A
SCHELL RANCH U 3/06 BT 8622A
MISS STACI 927 LE C780836 DNA 39A
CLARK JONES FARMS U 1/1 4/02 BT 6981A
DR. PEPPER 3/2 LH C903798
DOUBLE OAKS
BE - A - PEPPER 24-05 LE C911833
BOUNDS SWINGING B RANCH
FEMME FATALE 2/3 LH C903795
DOUBLE OAKS
MAGIC TIGER 65/4 RH C910254
BOWMAN U 10/05
JL MAGIC WOMAN 31/08 LE C958823
JOHNNY LANDFRIED FARMS
MISS SASSIE 0104 LE C888737
JOHNNY LANDFRIED FARMS

SIRE: JUSTICE 58/09 LE C980969
BOUNDS SWINGING B RANCH

DAM: PEPPER'S DELIGHT 0110 LE C986999
J SIX RANCH GAJ

EPDS						
	BW	WW	YW	MILK	TM	SC
EPD	1.1	7	12	3	6	-0.1
ACC	PE	PE	PE	PE	PE	PE

LOT 52

**JACOB JOHNSON
OPEN HEIFER**

ID#: PRINCESS MYLEE 15/12
BREEDER: JOHNSON
BBU#: 1018506
DOB: 4-27-12
COLOR: RED WUL

ONE OF THE FIRST KIX'S SMITH & WESSONS TO SELL. FANCY FEMALE WITH A GREAT FUTURE. A YEAR OLD ON SALE DAY.

C.'S BANDELERO 960 RH C809701 DNA 100A
CLARK JONES FARMS U 1/3 2/02 BT 7189A
BULLET PROOF 864 LE C931489 DNA US9000957935 PV
COTTAGE FARM U 4/08
**** OASIS 655 LE C828198 DNA 251620A**
COTTAGE FARM U 1/2 2/04 BT 7828A
ACE IN THE HOLE 70/3 LE C898727 DNA 249A
TRENT CROMER U 1/2 9/06 BT 8285A
MARISSA 22/7 LT C944803 DNA 504519A PV
BRADLEY'S CIRCLE J U 10/07
LADY CHEROKEE 700 LE C828215 DNA 498A
COTTAGE FARM U 1/3 10/03 BT 8624A
KENTUCKY PRINCE 981 LE C811784
HARROD FARMS U 10/01 BT 7175A
KENTUCKY COTTON 10/03 LH C885462
CARLTON DOUBLE AA RANCH
COTTON REFLECTION 01-95 LH C803577
CARLTON DOUBLE AA RANCH U 1/2 4/97 BT 6088B
**** RED TIGER 9075 LH C429021 DNA 367A**
TURNER CREST U 1/3 10/93 BT 4401B
RED PRINCESS 6/9 LH C783225
WILMOTH & SONS U 11/00
501/3 LH C692513
ADAIR BT 5368A

SIRE: SMITH & WESSON 43-09 LE C978588 DNA 643803A PV
BOUNDS SWINGING B RANCH

DAM: COTTON PRINCESS 28-06 LE C940084
BOUNDS SWINGING B RANCH

LOT 53

RED BAYOU SYNDICATE - SEMEN

ID#: RED BAYOU 17/10
BREEDER: BOUNDS
BBU#: 990090
DOB: 3-18-10
COLOR: RED SF

DNAUS900094813. SALE DAY SEMEN \$55.00 WITH A 5 UNIT MINIMUM STORED AT EBS 800-654-2503. HIS CALVES ARE SIMPLY SHOW CALF PHENOMS. CHECK OUT SOME OF HIS FIRST OFFSPRING ON DISPLAY AT THE SALE. HIS EPD'S AND SCAN ARE SOME OF THE HIGHEST EVER IN BEEFMASTERS. IF YOU WANT TO "WIN" PUT RED BAYOU IN!! 1.22 REA/CWT 4.30 IMF!

**** NATURAL SELECTION 10-1 LH C490834**
COTTAGE FARM U 1/3 6/92 BT 4544D
**** POLLED MANDATE 404/5 LE C705841**
CHANNAROCK FARM U 1/2 4/98 BT 6226A
**** 9183 LE C522206**
CHANNAROCK FARM U 1/2 3/93 BT 5814B
MULTIPLE
**** 2C46/8 LH S9887**
*** MULLINS U 3/3 6/91**
8 LT F14888
COMISKEY
**** BLACK MAGIC 120/97 LE C754207 DNA 599A**
KOOPMAN U 1/2 11/99 BT 6408A
**** BLACK JACK 21 LE C817059 DNA 40A**
SCHELL RANCH U 1/2 4/02 BT 7093A
MISS SCARLET USA 8-1 LE C757559 DNA 34A
TRENT CROMER U 1/2 4/01 BT 6562B
**** MR COFFEE 9006/8 LE C775045**
HARROD FARMS U 3/00 BT 6669A
43/0 LE C828978
T - BOB U 11/01
293/3033 31/8 LE C828406
T - BOB U 1/2 4/04 BT 7143C

SIRE: BLACK BAYOU 1071/3 LE C892444 DNA US3000542
CHANNAROCK FARM U 1/2 5/06 BT 8891A

DAM: GATOR 597 597 LE C913748
GATOR FARMS U 1/2 4/08

EPDS						
	BW	WW	YW	MILK	TM	SC
EPD	1.4	24	36	5	17	0.5
ACC	.52	.42	.45	.28	-	.31

ULTRASOUND EPDS				
	REA	%IMF	Rib Fat	Rump Fat
EPD	0.24	0.1	-0.02	0.10
ACC	PE	PE	PE	PE

INDIVIDUAL PERFORMANCE RECORDS								
	BW	WW	YW	Scrotal	REA	%IMF	Rib Fat	Rump Fat
Ratio	104		118		110	159	168	142
Contmp.	4		4		4	4	4	4
Adj. Trait	69		1179		14.42	4.3	0.48	0.55

LOT 54

**JON COLBURN
SEMEN & EMBRYOS**

STORED AT RLR, NORMANGEE, TX 936-348-0379

EMBRYOS

- A) 6 **BLACK JACK X T-BABY** 444-0 (PAINTED TIGER X SUGAR BABY) SIRE 817059 DAM 832046
- B) 2 **ZZ TOP X CINCH** 6-9 (PAINTED TIGER X TROJAN LADY) SIRE 912215 DAM 798098
- C) 2 **SCARLET'S PRIDE X RITA** 12/5 (BLACK JACK DAUGHTER) SIRE 577841 DAM S22825

SEMEN

- D) 4 **BLACK JACK 21** C817059
- E) 16 **ZZ TOP** C912215
- F) 1 **THE SINGER** C157838
- G) 3 **ACE IN THE HOLE** C898727

BEEFMASTER BREEDERS UNITED

6800 Park Ten Blvd., Suite 290 West
San Antonio, Texas 78213
210/732-3132
Web site: www.beefmasters.org

**APPLICATION FOR MEMBERSHIP
NAME FRANCHISE & HOLDING BRAND CONTRACT**

Date

Application is hereby made for membership in Beefmaster Breeders United (BBU) in the name of

(The Membership Name and Prefix Name are permanent records and cannot be changed.)
This application is hereby made for a (*circle one of the following*): Lifetime, Active, *Junior or Associate membership
This is a (*circle one*): Corporation, Partnership, Firm or Individual

I (We) hereby make application for the Prefix Name: _____,
and will apply this Prefix Name, if accepted, to BEEFMASTER cattle of which I am (we are) the breeder and/or first owner. I
(We) agree to notify BBU annually, with payment of dues, as to whether I am (we are) still breeding BEEFMASTERS and using
this Prefix Name. If I (we) do not so notify BBU, I (we) authorize BBU to discontinue my (our) use of this Prefix Name. (Annual
notification and dues do not apply to Lifetime memberships.)

I (We) will use the following Holding Brand: _____ (please sketch)

I (We) hereby designate _____ to exercise all rights and
privileges of this membership and, no person other than that named may act for this membership until the BBU Executive Vice
President has been notified in writing that another name is being substituted for the above and receipt of notification has been
acknowledged in writing.

I (We), if elected to membership, agree to be governed by the By-Laws, Rules and Regulations of Beefmaster Breeders United, as
amended from time to time, and hereby acknowledge receipt of the current By-Laws, Rules and Regulations.

I (We) hereby affirm the above and foregoing is true and correct to the best of my (our) knowledge and belief.

Signature and Title of Applicant(s)

*Date of Birth & School Grade
JUNIOR APPLICANT ONLY

Spouse's First Name

Name of Ranch Manager

Mailing Address (Box No. or Street)

Ranch Address

City, State & Zip Code

Ranch – City, State & Zip Code

E-Mail Address

Home Area Code/Phone Number

Ranch Area Code/Phone Number

Mobile Area Code/Phone Number

Lifetime Member Dues = \$2,000 • Active Member Dues = \$100 • Associate Member Dues = \$100 • First Time Member Special = \$50
Junior Member Dues = \$60 *Junior applicants must be under the age of 21 years on January 1st of the current year.

The above membership dues include an annual subscription to *The Beefmaster Cowman*.

Payment of Beefmaster Breeders United dues are tax deductible for most members as an ordinary and necessary business expense.

However, charitable contributions or gifts to Beefmaster Breeders United are not deductible for Federal income tax purposes.

*****PLEASE SEND MEMBERSHIP DUES WITH THIS APPLICATION TO 6800 Park Ten Blvd., Suite 290 W, San Antonio, TX 78213*****

The Sam Houston National Forest borders 3G Ranch
Ranch Sells Absolute-No Minimums or Reservations

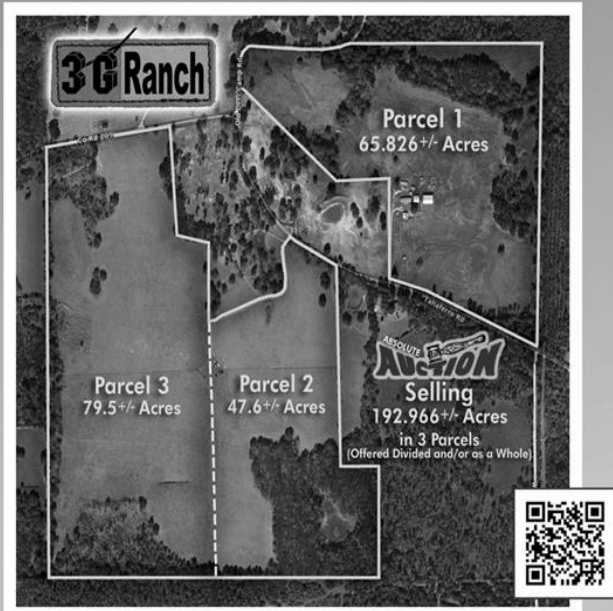

Location. Location. Location. Living on the edge of a National Forest is worth the ownership of this beautiful ranch.



Sunday, April 28th at 3:00 p.m.
At the Ranch, 26397 Taliaferro Road,
Richards, Texas 77873
in Montgomery County
Selling 192.966+/- Acres in 3 Parcels
(Offered Divided and/or as a Whole)

OPEN HOUSE:
April 12, 13, 14, 19, 20, 21, 26, 27,
11 a.m. to 6 p.m. to day of Auction.
Auction Time: 3 p.m. on the 28th.



Parcel 3: Hay Field



Parcel 1: Ranch Headquarters

Miles To: Houston 70, Montgomery 12, Richards 6, Conroe 32, Huntsville 20, Bryan 42 and College Station 35



The Auction Way Company
 P.O. Box 1663 • LaGrange, GA 30240 • 706/884-3062
 Gerald A. Bowie Auctioneer: TX Lic# 7237

SYLER & SALES
 Matt Syler 979-251-2159

5000 Syler-Kramer Road
 Burton, Texas 77835
 TX Broker Lic. #0153271

All Information Can Be Viewed at theauctionway.com

800.482.0775 (24/7)



Sales & Service
915 Pearidge Road
Franklin, GA 30217
979-229-6563 Cell
threeg1990@yahoo.com

FIRST CLASS MAIL
DATED MATERIAL

US POSTAGE
PAID
PERMIT #40
FIRST CLASS
FRANKLIN
GEORGIA