

"WHERE THE OPPORTUNITY AND QUALITY IS REAL"

Houston Magic



XII

March 2, 2012
10:30 a.m.

Houston Farm
& Ranch Club

Cattle Viewing Thursday, March 1



BBU Approved Sale

RCCM

Robbins Cattle Consulting & Marketing

210-545-6106 Office

210-861-5136 Mobile

ROBBINS

C A T T L E
CONSULTING & MARKETING

Dear Beefmaster Breeder,

Welcome to the **Houston Magic XII seedstock Beefmaster Sale** to be held **Friday March 2nd** at the **Houston Farm & Ranch Club** in **Houston, Texas**. This is the beginning of a great Beefmaster weekend with the STBBA Futurity & Classic Sale to be held at the same site and the Beefmaster Promotion Group International Beefmaster Gala Haltered Sale to be held at the Reliant Arena. This week of activity represents a **tremendous Beefmaster opportunity** with great crowds of Beefmaster Breeders gathered for all of these events. Do not miss this opportunity to improve your breeding program and expand your friendships in the breed.

The **Houston Magic XII sale offering is available for your viewing on the Internet at www.advancedvideoauctions.com**; make sure you go there and contact me with any questions.

The **Houston Magic sale** has built a tremendous reputation of having superior opportunity in every category and this **12th edition** confirms that tradition once again! A very select group of **Herd Sire Prospects** with tremendous visual appraisal, the proven pedigree you desire and the documented performance that will make any breeding program more consistent and profitable! **Proven Donors, Pairs, Bred and Open Heifers** in this female offering are unsurpassed in quality and opportunity. These individuals represent some of the most sought after maternal genetics in the breed that are the necessary ingredient for you to be truly successful in your Beefmaster breeding program. Then add in a select group of **Frozen Embryos** combined with a **Special Semen Offering on Adrenaline, Sugar Bear and El Dorado, the full brother to Cavalier** and you have all the necessary parts for **building a better Beefmaster**. With proper evaluation of this sale offering you realize this is a sale with the opportunity and the individuals necessary for you to **attain success** in your breeding program and in the Beefmaster business.

There is **NO sale offering DVD** available and the sale **WILL NOT** be broadcast live on the internet but you can **view the sale offering at www.advancedvideoauctions.com website**. So make your plans now to take advantage of the numerous opportunities being offered by joining us in Houston or by contacting me. This is the place and the time for you to make a statement about the type and kind of Beefmaster breeder you are or want to be. The Houston Magic XII Sale has what you need to make your breeding goals successful!

Do not hesitate to contact me if I can be of any assistance in making selections or purchases.

See you in Houston!

Bruce Robbins

“Where the opportunity and quality are real”

Houston Magic

XII

March 2, 2012
Friday, 10:30 a.m.

Cattle Viewing Thursday, March 1

*Preview of the
sale offering @
advancedvideoauctions.com*

**Houston Farm
& Ranch Club**
Abercrombie Drive, Houston



Auctioneer:
Gerald Bowie

Sale Accommodations:

Omni Hotel Houston Westside
800-THE-OMNI or 281-558-8338

Mention South Texas Beefmaster

For Information Contact:

RCCM

Robbins Cattle Consulting & Marketing

Sale Manager: Bruce Robbins
210-545-6106 Office • 210-861-5136 Mobile
robbinscattle@att.net

Houston Farm & Ranch Club
#1 Abercrombie Drive
Houston, TX 77084

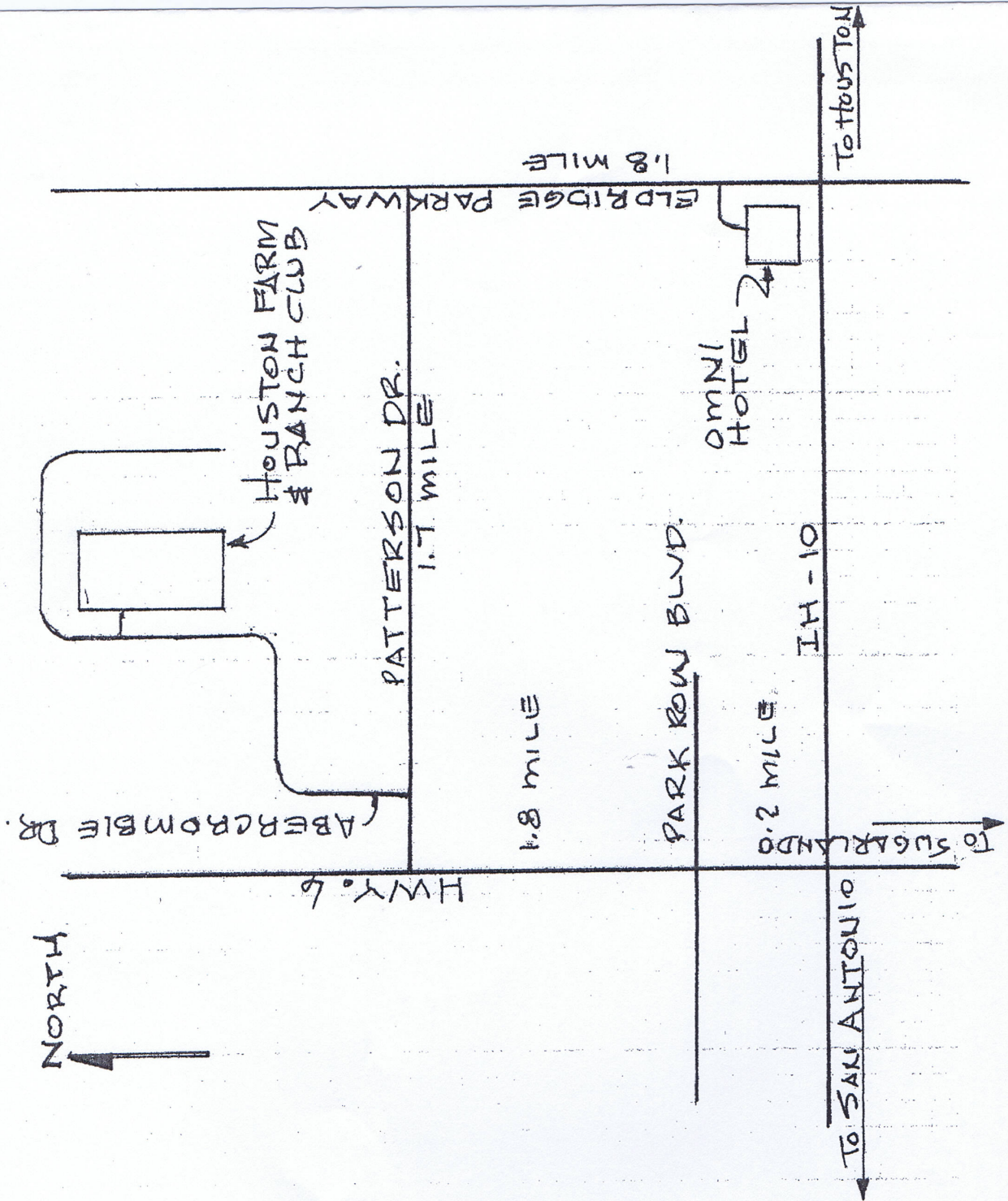

TERMS AND CONDITIONS OF SALE
ADOPTED BY BEEFMASTER BREEDERS UNITED
FOR BBU APPROVED SALES
Effective September 10, 2010

THE FOLLOWING TERMS ARE APPLICABLE TO ALL TRANSACTIONS IN BBU APPROVED SALES:

1. BIDDING: Each animal will be sold to the highest bidder without reserve.
2. BIDDING DISPUTE: The Auctioneer in charge will settle any dispute as to bids, and his decision on such matters shall be final.
3. TERMS: Terms of the sale are cash due upon sale, unless prior credit arrangements for the sale have been agreed upon in writing between the Buyer and Seller, in which event, the terms of the written credit arrangement between Buyer and Seller for the sale shall prevail. The failure of a member buyer to pay the appropriate party the sale amounts when due may constitute a cause for exclusion from BBU pursuant to Article I, section 9 of the By Laws of BBU.
4. PURCHASER'S RISK: Each animal becomes the risk of the purchaser as soon as the auctioneer declares it sold.
5. CERTIFICATE OF BREEDING AND/OR TRANSFERS: All required paperwork will be transferred to the buyer at the seller's expense, upon settlement.
6. HEALTH: All animals will have appropriate certificates of veterinary inspection for travel to the sale site and will to the best of the seller's knowledge be eligible for interstate shipment, however, buyers need to be aware of their individual resident state's requirements for shipment of cattle. Any and all testing will have been completed within thirty (30) days of the sale date.
7. ANNOUNCEMENTS: Any changes in information of any kind will be announced from the auction box and such announcements shall take precedence.
8. BREEDING GUARANTEES:
 - a) FEMALES: OPEN AND/OR EXPOSED FEMALES: Females younger than twenty-four (24) months of age can be sold as open. Open females are so guaranteed. Any female is considered a breeder if she is certified to be pregnant by a licensed veterinarian at the time of sale and/or has a nursing calf at side. Cows (including donor cows) with calves at side six (6) months or older must be certified to be pregnant by a licensed veterinarian.
 - b) SAFE IN CALF FEMALES have been examined by a competent veterinarian and are so guaranteed.
 - c) BULLS: Bulls eighteen (18) months or older are guaranteed to have passed a Bull Breeding Soundness Evaluation (BSE) and to have been certified a satisfactory potential breeder by a licensed veterinarian within forty-five (45) days prior to sale date. The results of the Breeding Soundness Evaluation (BSE) must be reported on a fully completed official form and attached to the health papers required for the sale.
9. DISCLOSURE OF PRIOR PROCEDURES: If known to the seller, there must be a disclosure in the current sale catalog or from the box of any circumcision or other surgical alteration of any underline of any male or female and of any single egg or super-ovulation flush of any female sold in a BBU Approved Sale.
10. INHERITED DEFORMITIES GUARANTEE: All bred females are guaranteed not to produce a calf with an inherited deformity occurring in Bovine for a period of nine months following date of sale.
11. REPRESENTATIONS AND GUARANTEES: All representations and guarantees, whether set forth in sale catalogs, these Terms and Conditions of Sale or otherwise, are solely those of seller and are not those of BBU. Except for the assurances set forth in the Approved Sales Agreement that an animal does not exhibit a genetic defect and that its registry information is consistent with the information in BBU's records, BBU makes no representations, warranties, guaranties or assurances whatsoever.
12. RIGHTS AND OBLIGATIONS: The above terms and conditions of sale shall constitute a contract between buyer and seller of each animal and shall be equally binding upon both. Each sale or resale of an animal constitutes a separate transaction. Neither BBU, the sale manager, nor any other person connected with the management of the sales assumes any liability, legal or otherwise, for any subsequent resale of an animal.
13. REMEDIES:
 - a) OPEN AND/OR EXPOSED FEMALES are guaranteed to be breeders by twenty-four (24) months of age except in cases of animals purchased and then fitted for show or administered any super ovulation drug. In cases of animals fitted for show or administered any super ovulation drug after purchase, the breeding guarantees, if any, shall be such as agreed upon between buyer and seller. All claims for a refund must be made in writing to the seller within six (6) months after the animal reaches twenty-four (24) months of age. Open females are so guaranteed. If within sixty (60) days after the sale date, a female sold as "open" proves to be with calf, the buyer may return the female to the farm of the seller, provided the female is in

good condition and in compliance with the health requirements of the seller's state, and receive refund of the full purchase price. The acceptance of the refund of the full purchase price shall in any case be deemed full satisfaction and settlement of the matter. The buyer's failure to notify the seller within sixty (60) days from the date of sale and to make the election as hereinabove provided shall relieve and absolve the seller of any duty, obligation or liability to the buyer regarding the purchase of said female. The seller and buyer shall bear equally all reasonable and necessary transportation expenses that are incurred in returning the animal to seller.

b) SAFE IN CALF FEMALES have been examined by a licensed veterinarian. If within thirty (30) days after sale date, a female sold as "safe in calf" proves not to be in calf, the buyer may immediately request that the female receive service from the bull previously used, if available, or return the female to the farm of the seller, provided the female is in good condition and in compliance with the health requirements of the seller's state, for a refund of the full purchase price. The acceptance of the refund of the full purchase price shall in any case be deemed full satisfaction and settlement of the matter. The buyer's failure to notify the seller within thirty (30) days from the sale date and to make the election as hereinabove provided shall relieve and absolve to the seller of any duty, obligation or liability to the buyer regarding the purchase of said female. The seller and buyer shall bear equally all reasonable and necessary transportation expenses that are incurred in returning the animal to seller.

c) FLUSHES AND TIME REQUIREMENTS: A flush consists of all viable embryos, transferred or frozen, received from a female as the result of the administration of any super ovulation drug. The sale of a flush or resulting pregnancies must specify in the sale catalog the number of pregnancies guaranteed and the disposition of any other pregnancies resulting from the flush, the disposition of any frozen embryos resulting from the flush and any additional charge for the recipient cows. The maximum time for the delivery of the guaranteed results must be specified along with a payment schedule. Non-delivery or only partial delivery by the specified time by the seller will result in a pro-rata refund of all monies previously paid by the buyer for such flush or pregnancies not delivered.

d) PREGNANCY AND/OR PREGNANT RECIPIENT COW: Pregnancy and/or pregnant recipient cow is a cow of any breed that is carrying a pregnancy (guaranteed to have been examined by a licensed veterinarian as safe in calf) as the result of a flush as so stated on the certification of embryo transplant form. Such pregnancy and/or pregnant recipient cow is guaranteed to be carrying the embryo pregnancy so stated and if found not safe in calf by a licensed veterinarian within thirty (30) days of delivery of the recipient cow to the buyer, the buyer will have the same remedies as set forth in clause b) for the safe in calf females. The amount bid by the buyer for the individual pregnancy and/or pregnant recipient cow offered at a sale will be inclusive of the recipient cow. A pregnancy and/or pregnant recipient cow should be available at the sale site; however, if not available it must be delivered to the buyer, at the seller's expense, within thirty (30) days of the sale with the necessary health papers sufficient for delivery to the buyer.

e) CLONES: Only BBU replication cell-cloned animals shall be eligible for registration and eligible to sell in BBU Voluntary Approved Sales. Genetically modified animals shall not be eligible for registration and cannot sell in BBU Approved Sales. Cloned animals shall be guaranteed by the seller to be breeders under the same terms of the agreement for females and bulls. *Any additional guarantees with respect to clones shall be a separate agreement between buyer and seller.*

f) BULLS: If within one-hundred twenty (120) days from the date of sale, the bull has failed to pass a Breeding Soundness Evaluation ("**BSE**") certified by a licensed veterinarian, buyer must send seller written notification of the failure of the test within one-hundred and twenty (120) days from the date of sale and include the BSE test results. Within sixty (60) days after seller's notification of the failed BSE test, buyer and seller shall identify a mutually agreeable licensed veterinarian or technician certified by a licensed veterinarian to perform another BSE on the bull at the buyer's expense. The results of the test shall be deemed final and conclusive of this matter and binding on buyer and seller. If, in the opinion of said veterinarian, the bull is unable to pass a BSE and be confirmed a satisfactory potential breeder, he shall so certify in writing to the seller and the buyer which shall include the official form used by the Society of Theriogenology or the official BBU Breeding Soundness Evaluation form. In such event the buyer may return the bull to the farm of seller, provided the bull is in good condition and in compliance with the health requirements of the seller's state, for a refund of the full purchase price. The acceptance of the refund of the full purchase price shall in any case be deemed full satisfaction and settlement of the matter. The seller and buyer shall bear equally all reasonable and necessary transportation expenses that are incurred in returning the animal to seller. A listing of industry standards for Scrotal Circumferences for bulls at various ages will be printed in the sale catalog. Satellites, Marketing Groups, or individuals may specify additional guarantees.



**Beefmaster
Breeders
United**

Voluntary Classification Guidelines:

Cattle are visually inspected by a BBU field representative for desirable traits. Each animal is classified according to BBU's Standards of Excellence.

Any bull or female in the "U" category will be so designated on the BBU Certificate of Breeding along with the date and initials of the BBU field representative. To be presented for a "U" classification, males and females must be a minimum of 8 months with no upper age limit. Classification of Certified Beefmaster cattle is \$5.00 per head or \$350.00 per stop, whichever is greater.

Any bull or female in the "X" category will be removed from the registry by BBU's office and so noted by correspondence to the member. BBU will not charge the member a classification fee for an "X" animal.

Bulls must have a yearling scrotal measurement (taken between 320-410 days of age) of at least 30 cm to meet the "U" qualification. A measurement of 34 cm is the objective.

All cattle presented for classification must have permanent identification and must be certified or an application for certification must be presented to the field representative.

To receive a number score all animals must have a "U" classification.

All animals (male and female) aged 13 months and up may be presented for "U" classification and number scores for conformation and underline, with the stipulation that if the animal is seen later in a BBU Approved or Sanctioned Sale it is subject to reclassification by the BBU field representative at the sale (at no charge).

Scrotal Circumference Scores:

SCORE:	AGE		
	15-20 Mo. Old	21-30 Mo. Old	Over 30 Mo. Old
Very Good	More than 37 cm.	More than 39 cm.	More than 40 cm.
Good	31-37cm.	32-39 cm.	33-40 cm.
Poor	Less than 31 cm.	Less than 32 cm.	Less than 33 cm.

BBU Mission Statement

BBU's Mission is to enhance breeders' ability to raise and promote cattle based upon the founding "Six Essentials."

*Disposition - Fertility - Weight - Conformation -
Hardiness - Milk Production*

Our Vision: To increase worldwide demand for Beefmaster cattle.

Guiding Principles:

- 1.) Always strive for breed improvement.
- 2.) Never compromise Integrity.
- 3.) Expand...Encourage...Educate...

CONSIGNOR INDEX

Consignor	Lot(s)
Adrenaline Syndicate.....	1A
Sugar Bear Syndicate.....	1B
Harrod Farms.....	1C
A&G Farms.....	2
Bailey Farm.....	3-11
Brazos Valley Beefmasters.....	12-14
Circle S Beefmasters.....	15-20
Cottage Farm.....	21-25
D&D Beefmasters.....	26
Dunkin's Four D.....	27-28
Dunkin's Four D/J&D.....	29
Emmons Ranch.....	30
Hall & Tate.....	31-32
J&T Farm.....	33-37
Clark Jones.....	38
KC Beefmasters.....	39-46
Kreger Beefmasters.....	47-50
Kreger Beefmasters/Bedlam Beefmasters.....	51
Little Horn.....	52-54
Ultimate Princess Syndicate.....	55
Lloyd & Lloyd Farms.....	56-61
New Cut Farms.....	62-64
Peck Land & Cattle.....	65-67
D&S Sweetwater Ranch.....	68
T Bar K.....	69-72
Thunder Valley Ranch.....	73-74
Whitley Family Farms.....	75
Windy Hills.....	76-78
Tommy Lee Smith.....	79

Adrenaline Syndicate

1A

SEMEN

ID No.: **170 CF Adrenaline**
 Breeder: **Cottage Farm** Birth: **5/10/08**
 BBU No.: **965778** Color: **Red**

**Infinity	**Red Sugar	**Cherokee Phantom
DNA 674A	**Vanna	**Sugar Ann
BT 5956A	**Cavalier	***Phantom Warrior
**Oasis	**Sex Life	**Madam X 3/293
DNA 251620A		**Spartacus
BT 7628A		**Madera 1-5/5
		**Sandman
		**Sex Appeal

OFFICIAL BBU INFORMATION

Expected Progeny Differences:										
	BW	WW	YW	Milk	TM	SC	REA	%IMF	Rib Fat	Rump Fat
EPD	-1.2	22	30	0	11	0.8	-0.12	0.2	0.07	0.06
ACC	.66	.62	.59	.33	-	.44	PE	PE	PE	PE
	BW	WW	YW	Scrotal	REA	%IMF	Rib Fat	Rump Fat		
Ratio	105	106	103		100	100	100	100		
Contemp.	19	19	2		1	1	1	1		
Adj. Trait	74	693	1309		12.28	3.33	0.41	0.73		

CUP LAB SCAN DATA

Scan Age	REA/cwt	%IMF	Rib Fat
15 mos.	1.24	3.33	.34

DNA US3000940 PV. Special sale day price of \$125 per unit with no minimum purchase. Price includes semen certificate with every unit purchased. Adrenaline is proving through his production that he can provide and produce the next generation of superior Beefmasters. Use this opportunity to improve your breeding program with the use of Adrenaline.

Purchaser _____ \$ _____

Sugar Bear Syndicate

1B

SEMEN

ID No.: **933 CF Sugar Bear**
 Breeder: **Cottage Farm** Birth: **2/1/09**
 BBU No.: **977252** Color: **Red**

Captain Sugar 12/02	**Infinity	**Red Sugar
DNA 134A	**Sugar Ann	**Vanna
BT 7526A	**Cavalier	***Ranger's Pride
**Oasis	**Sex Life	**EMS 6-2
DNA 251620A		**Spartacus
BT 7628A		**Madera 1-5/5
		**Sandman
		**Sex Appeal

OFFICIAL BBU INFORMATION

Expected Progeny Differences:											
	BW	WW	YW	Milk	TM	SC	REA	%IMF	Rib Fat	Rump Fat	
EPD	-0.3	26	29	1	14	0.9	-0.12	0.1	0.01	-0.06	
ACC	.52	.52	.51	.28	-	.50	PE	PE	PE	PE	
	BW	WW	YW	Scrotal	REA	%IMF	Rib Fat	Rump Fat			
Ratio	100	100	102		98	121	130	113			
Contemp.	2	2	2		2	2	2	2			
Adj. Trait	70	679	1352	37.15	13.4	2.91	0.45	0.56			

CUP LAB SCAN DATA

Scan Age	REA/cwt	%IMF	Rib Fat
	1.34	2.91	.24

DNA US3000936 PV. Special sale day price of \$125 per unit with no minimum purchase required and this price includes semen certificate with every unit purchased. Sugar Bear brings the predictable production of Captain Sugar and Oasis to you. Sugar Bear is your answer for predictable performance with proven pedigree. Use this opportunity to include this consistency in your breeding program.

Purchaser _____ \$ _____

Harrod Farms

1C

SEMEN

ID No.: **936 El Dorado**
 Breeder: **Harrod Farms** Birth: **4/10/99**
 BBU No.: **799760** Color: **Dun**

Gator 3
 **Gladiator Circle Dot 8/17
 **Spartacus Multiple
 DNA 9A Harrell 8/5
 BT 3116A **Ranger
**Ranger's Pride **Miss Lindeman
 **Madera 1-5/5 **Jeb Stuart
 BT 2171A **Kentucky Princess
**Harris 6/4

OFFICIAL BBU INFORMATION

Classification:	U	Conformation:	1	Underline:	3					
Expected Progeny Differences:										
	BW	WW	YW	Milk	TM	SC	REA	%IMF	Rib Fat	Rump Fat
EPD	1.0	5	2	-.4	-.2	-.01				
ACC	.52	.55	.51	.41	-	.42				

BT 7029A. Special sale day price: Buyer's choice \$10 per unit includes semen certificate with every unit purchased OR \$5 per unit and you contact Bruce and purchase semen certificates you want at \$5 per certificate. The only full brother to Cavalier. Now after Cavalier has blazed a trail of proven superior product, you can use El Dorado to continue. Cavalier is gone or very expensive if you find it. Try El Dorado today and reap the rewards in your next calf crop.

Purchaser _____ \$ _____

A&G Farms

2

A. PICK OF CALVES - BULL

ID No.: **43-0**
 Breeder: **A&G Farms** Birth: **12/7/10**
 BBU No.: **1006985** Color: **Red MUL**

B. PICK OF CALVES - HEIFER

ID No.: **44-0**
 Breeder: **A&G Farms** Birth: **12/7/10**
 BBU No.: **1006986** Color: **Red**

Captain Sugar 12/02 **Infinity
Sugar Britches 040 **Sugar Ann
DNA 345274A **Cavalier
**Oasis **Sex Life
Smoothconnection Windy Hills 320
Sugar Smooth 650 Robbie 24/2
DNA 555931A PV **Cavalier
Miss Sugarbelle Jezabelle 62J8

A. & B. OFFICIAL BBU INFORMATION

Expected Progeny Differences:										
	BW	WW	YW	Milk	TM	SC	REA	%IMF	Rib Fat	Rump Fat
EPD	0.2	11	8	0	5	0.4	-0.19	0.0	-0.01	-0.03
ACC	PE	PE	PE	PE	PE	PE	PE	PE	PE	PE

It doesn't matter if your program needs a bull or a heifer, you can't go wrong with this pick. Combine Oasis with Miss Sugarbelle, two tremendous producers backed by Sex Life and Jezabelle; this pick represents the Who's Who in Beefmasters. They will do that same production for you--a smart buyer takes them both!

Purchaser _____ \$ _____

Bailey Farm

3

BRED PROVEN DONOR

ID No.: **051 Luciana**
 Breeder: **Cottage Farm** Birth: **6/25/06**
 BBU No.: **940591** Color: **Red**
 Al'd To: **Sugar Britches, 940465 (8/15/11; ECD 5/25/12)**

**Infinity **Red Sugar
Captain Lucey 116/01 **Vanna
DNA 133A **Synergy
BT 7402A **Milk & Honey ***Dolce Freddo
**Cavalier **Spartacus
Nirvana 96/1 **Madera 1-5/5
DNA 314853A Wilmoth 33/9 **Synergy
BT 7788A **Victor's Sister

OFFICIAL BBU INFORMATION

Classification:	U	Conformation:	1	Underline:	2					
Expected Progeny Differences:										
	BW	WW	YW	Milk	TM	SC	REA	%IMF	Rib Fat	Rump Fat
EPD	1.0	8	8	0	4	0.1	-0.34	0.1	0.05	-0.06
ACC	.47	.44	.41	.26	-	.34	PE	PE	PE	PE

DNA 541867A PV. Proven superior producer and carries the unique and exclusive genetics that are time tested to be some of the best in the Beefmaster breed. This is your opportunity to add a Nirvana daughter that will super charge any breeding opportunity, plus a Sugar Britches baby coming! Look at the Dream Catcher heifer selling today as your inspiration.

Purchaser _____ \$ _____

Bailey Farm

3A

OPEN HEIFER

ID No.: **BF 1101**
 Breeder: **Bailey Farm** Birth: **3/8/11**
 BBU No.: **1000789** Color: **Dk. Red**

Captain Sugar 12/02 **Infinity
Dream Catcher 914 **Sugar Ann
DNA US3000924 PV **Cavalier
**Oasis **Sex Life
Captain Lucey 116/01 **Infinity
Luciana 051 **Milk & Honey
DNA 541867A PV **Cavalier
Nirvana 96/1 Wilmoth 33/9

OFFICIAL BBU INFORMATION

Expected Progeny Differences:										
	BW	WW	YW	Milk	TM	SC	REA	%IMF	Rib Fat	Rump Fat
EPD	0.7	18	19	0	10	0.5				
ACC	.44	.29	.28	.14	-	.19				
	BW	WW	YW	Scrotal	REA	%IMF	Rib Fat	Rump Fat		
Ratio										
Contemp.										
Adj. Trait										

Youth, quality genetics, superior individual and the Beefmaster breed character that sets her apart from the rest. Captain Sugar, Captain Lucey, Oasis and Nirvana--enough said!

Purchaser _____ \$ _____

Bailey Farm

4

BRED PROVEN DONOR

ID No.: **174**
 Breeder: **Cottage Farm** Birth: **5/10/08**
 BBU No.: **965771** Color: **Red**
 Bred To: **BF King Pin, 992569 (ECD 6/15/12)**

****Red Sugar** ****Cherokee Phantom**
****Infinity** ****Sugar Ann**
DNA 674A ****Vanna** ****Phantom Warrior**
BT 5956A ****Madam X 3/293**
****Cavalier** ****Spartacus**
****Oasis** ****Madera 1-5/5**
DNA 251620A ****Sex Life** ****Sandman**
BT 7628A ****Sex Appeal**

OFFICIAL BBU INFORMATION

Expected Progeny Differences:										
	BW	WW	YW	Milk	TM	SC	REA	%IMF	Rib Fat	Rump Fat
EPD	-0.5	25	30	0	13	0.8	-0.12	0.2	0.07	0.06
ACC	.58	.56	.55	.33	-	.42	PE	PE	PE	PE
		BW	WW	YW	Scrotal	REA	%IMF	Rib Fat	Rump Fat	
Ratio		103	101	97						
Contemp.		19	119	12						
Adj. Trait		69	598	968						

DNA US40002604 PV. Two Beefmaster breed legends combined to create this beautiful female. This female can become the cornerstone of any breeding program. Proven superior production and longevity throughout her genetics; this is the opportunity you have been looking for. Calf in the belly by our new herdsire that brings Spartacus and Aphrodite into the mix.

Purchaser _____ \$ _____

Bailey Farm

5

BRED HEIFER

ID No.: **BF 1015**
 Breeder: **Bailey Farm** Birth: **3/27/10**
 BBU No.: **1000767** Color: **Dk. Red**
 Al'd To: **CF Adrenaline, 865778 (11/7/11; ECD 8/17/12)**

Captain Sugar 12/02 ****Infinity**
Sugar Britches 040 ****Sugar Ann**
DNA 345274A ****Oasis** ****Cavalier**
****Sex Life**
****Painted Tiger** ****Painted Warrior**
Red Tiger Lady 94/06 ****Dunkin 1-126**
DNA 365455A PV **Dreamlady in Red** ****Spartacus**
Adair 062/4

OFFICIAL BBU INFORMATION

Expected Progeny Differences:										
	BW	WW	YW	Milk	TM	SC	REA	%IMF	Rib Fat	Rump Fat
EPD	0.8	15	17	0	7	0.5				
ACC	.50	.42	.39	.15	-	.26				
		BW	WW	YW	Scrotal	REA	%IMF	Rib Fat	Rump Fat	
Ratio		99	92							
Contemp.		4	2							
Adj. Trait		68	535							

Donor prospect with all the required ingredients to help you produce the quality Beefmaster product you desire. Every individual in her pedigree is U 1 quality and a baby coming by Adrenaline to help you start with a tremendous calf. Total package and calving this fall.

Purchaser _____ \$ _____

Bailey Farm

6

A. PICK OF OPEN HEIFERS

ID No.: **BF 9057**
 Breeder: **Bailey Farm** Birth: **9/8/10**
 BBU No.: **1000781** Color: **Dk. Red**

A. OFFICIAL BBU INFORMATION

Expected Progeny Differences:

	BW	WW	YW	Milk	TM	SC	REA	%IMF	Rib Fat	Rump Fat
EPD	1.1	20	23	0	10	0.6				
ACC	.50	.44	.39	.15	-	.26				
		BW	WW	YW	Scrotal	REA	%IMF	Rib Fat	Rump Fat	
Ratio		96	107							
Contemp.		5	3							
Adj. Trait		70	600							

B. PICK OF OPEN HEIFERS

ID No.: **BF 9056**
 Breeder: **Bailey Farm** Birth: **9/8/10**
 BBU No.: **1000779** Color: **Dk. Red**

B. OFFICIAL BBU INFORMATION

Expected Progeny Differences:

	BW	WW	YW	Milk	TM	SC	REA	%IMF	Rib Fat	Rump Fat
EPD	0.9	18	20	0	9	0.6				
ACC	.50	.44	.39	.15	-	.26				
		BW	WW	YW	Scrotal	REA	%IMF	Rib Fat	Rump Fat	
Ratio		97	101							
Contemp.		5	3							
Adj. Trait		69	566							

Captain Sugar 12/02 ****Infinity**
Sugar Britches 040 ****Sugar Ann**
DNA 345274A ****Oasis** ****Cavalier**
****Sex Life**
****Painted Tiger** ****Painted Warrior**
Red Tiger Lady 94/06 ****Dunkin 1-126**
DNA 365455A PV **Dreamlady in Red** ****Spartacus**
Adair 062/4

Powerful conformation plus predictable pedigree and you have consistent superior quality and profit. These sisters are great expressions of what quality with quality gets Quality. Superior production and quality top and bottom, all U 1. This is the place and time to take one home!

Purchaser _____ \$ _____

OPEN HEIFER

ID No.: **BF 1035**
 Breeder: **Bailey Farm** Birth: **10/5/10**
 BBU No.: **1000775** Color: **Red**

Captain Sugar 12/02 **Infinity **Red Sugar
DNA 134A **Vanna
BT 7526A **Sugar Ann ***Ranger's Pride
Miss Savannah 5004 **EMS 6-2
DNA 541869A PV Soul Man 168 CJ 721
Nelaz 9-162NZ Soulmans Momma 928
**Red Tiger
**Cottage Farm 108-0

OFFICIAL BBU INFORMATION

Expected Progeny Differences:											
	BW	WW	YW	Milk	TM	SC	REA	%IMF	Rib Fat	Rump Fat	
EPD	0.1	-1	-1	2	2	-0.1	-0.12	0.0	-0.03	-0.14	
ACC	.50	.44	.42	.24	-	.31	PE	PE	PE	PE	
	BW	WW	YW	Scrotal	REA	%IMF	Rib Fat	Rump Fat			
Ratio	105	90									
Contemp.	5	2									
Adj. Trait	64	478									

Here is your Captain Sugar with the class, quality and proven productive pedigree you desire. Captain Sugar daughters very rarely get offered; take this one home and you will understand why breeders love them.

Purchaser _____ \$ _____

A. PICK OF OPEN HEIFERS

ID No.: **BF 1043**
 Breeder: **Bailey Farm** Birth: **11/18/10**
 BBU No.: **1003427** Color: **Red**

A. OFFICIAL BBU INFORMATION

Expected Progeny Differences:											
	BW	WW	YW	Milk	TM	SC	REA	%IMF	Rib Fat	Rump Fat	
EPD	-0.6	11	13	1	6	0.4					
ACC	.50	.47	.42	.15	-	.26					
	BW	WW	YW	Scrotal	REA	%IMF	Rib Fat	Rump Fat			
Ratio	101	97									
Contemp.	6	6									
Adj. Trait	63	518									

B. PICK OF OPEN HEIFERS

ID No.: **BF 1044**
 Breeder: **Bailey Farm** Birth: **11/23/10**
 BBU No.: **1003428** Color: **Red**

B. OFFICIAL BBU INFORMATION

Expected Progeny Differences:											
	BW	WW	YW	Milk	TM	SC	REA	%IMF	Rib Fat	Rump Fat	
EPD	-0.5	12	13	1	6	0.4					
ACC	.50	.47	.42	.15	-	.26					
	BW	WW	YW	Scrotal	REA	%IMF	Rib Fat	Rump Fat			
Ratio	98	96									
Contemp.	6	6									
Adj. Trait	65	516									

Adrenaline 170 **Infinity **Red Sugar
DNA US3000940 PV **Oasis **Vanna
Victorian Sugar 6/06 Captain Sugar 12/02 **Cavalier
DNA 541870A PV Victorian Red 7/03 **Sex Life
**Infinity
**Sugar Ann
Entergy 9/8
Victoria 145/00

Some of our first Adrenaline production and out of our tremendous donor female from L2 that we just lost this winter. Super production, quality throughout and with the cutting edge genetics that will make you a better Beefmaster breeder!

Purchaser _____ \$ _____

Bailey Farm

9

HERDSIRE PROSPECT

ID No.: **BF 1040**
 Breeder: **Bailey Farm** Birth: **11/8/10**
 BBU No.: **1003421** Color: **Red**

Captain Sugar 12/02 **Infinity
 **Sugar Ann
 Sugar Britches 040 **Cavalier
 DNA 345274A **Sex Life
 **Oasis
 **Gladiator
 **Spartacus
 **Dreamlady
 Bailey 4/07 Hav-A-Dee 1206/8
 DNA 541866A PV Princess Maiden
 Maiden Lady 154/00

OFFICIAL BBU INFORMATION

Expected Progeny Differences:										
	BW	WW	YW	Milk	TM	SC	REA	%IMF	Rib Fat	Rump Fat
EPD	0.7	22	24	-2	9	0.6				
ACC	.42	.39	.36	.15	-	.26				
	BW	WW	YW	Scrotal	REA	%IMF	Rib Fat	Rump Fat		
Ratio	99	108								
Contemp.	2	2								
Adj. Trait	67	802								

Stout individual built on the same genetics that the high selling bull here last year was that Collier Farms and Melvin Sherer bought. These quality prospects built on unsurpassed maternal genetics and individuals are rarely offered. Take him home and you will be glad you did!

Purchaser _____ \$ _____

Bailey Farm

10

HERDSIRE PROSPECT

ID No.: **BF 1041**
 Breeder: **Bailey Farm** Birth: **11/17/10**
 BBU No.: **1003422** Color: **Red**

 **Infinity **Red Sugar
 **Vanna
 Adrenaline 170 **Cavalier
 DNA US3000940 PV **Sex Life
 **Oasis **Infinity
 **Milk & Honey
 Captain Lucey 116/01 **Desperado
 **Gladiator
 Lucey Baby 868 Baby Face 343/2
 DNA 541871A PV Baby 062/7

OFFICIAL BBU INFORMATION

Expected Progeny Differences:										
	BW	WW	YW	Milk	TM	SC	REA	%IMF	Rib Fat	Rump Fat
EPD	-0.1	12	17	-1	5	0.4				
ACC	.42	.31	.29	.15	-	.21				
	BW	WW	YW	Scrotal	REA	%IMF	Rib Fat	Rump Fat		
Ratio	101	100								
Contemp.	2	1								
Adj. Trait	68	675								

Our oldest Adrenaline calf and has a dam that is polled and powerful with the predictable genetics our breed has come to demand. Great opportunity and a calf that will demand attention with his quality and genetics.

Purchaser _____ \$ _____

Bailey Farm

11

10 FROZEN EMBRYOS

Captain Sugar 12/02 **Infinity
 **Sugar Ann
 Sugar Bear 933 **Cavalier
 DNA US3000936 PV **Sex Life
 **Oasis **Red Sugar
 **Infinity **Vanna
 Johnson 11/62 **Cherokee Phantom
 DNA 207A **LA 48-6
 **Double JJ 48/6
 BT 8199A

Selling in two groups of 5. This is some of the first Sugar Bear production to be offered. 11/62 is a proven through production superior producer. Great genetics and individuals assure you great product. Stored at Cottage Farm Genetics.

Purchaser _____ \$ _____

Brazos Valley Beefmasters

12

BULL

ID No.: **610 Mr BV 610**
 Breeder: **Brazos Valley** Birth: **2/1/10**
 BBU No.: **1007323** Color: **Dk. Red**

 **Robert E. Lee
 Warrior III 0073 Barfield 8/087
 Master of Legends 5230 **Phantom
 BT 8902A **Thompson 3033
 **Lady of Legends **Painted Tiger
 **Gladiator **Lady Victoria
 Picaboo 4804 Warrior III 0073
 **Desperado Southern Princess 0229
 Elegance 28/1

OFFICIAL BBU INFORMATION

Expected Progeny Differences:										
	BW	WW	YW	Milk	TM	SC	REA	%IMF	Rib Fat	Rump Fat
EPD	0.5	5	11	1	3	0.0				
ACC	PE	PE	PE	PE	PE	PE				
	BW	WW	YW	Scrotal	REA	%IMF	Rib Fat	Rump Fat		
Ratio	100	100								
Contemp.	1	1								
Adj. Trait	75	567								

Big, stout, growthy, dark red and out of Master of Legends bull that surely will help someone. There is no need to say more, just check his pedigree and see all the greats.

Purchaser _____ \$ _____

Brazos Valley Beefmasters

13

BRED HEIFER

ID No.: **2709 Miss BV 2709**
 Breeder: **Brazos Valley** Birth: **10/6/09**
 BBU No.: **991648** Color: **Red**
 Bred To: **Classic Cotton, 380077**

Real Deal 5304 **Painted Tiger **Painted Warrior
 **Dunkin 1-126
 Warrior III 0073
 Elegance 28/1 Southern Princess 0229
 Warrior III 0073
 Master of Legends **Lady of Legends
Brazos Valley 4704 ***Ranger's Pride
 House 26/6 **Tiger Lilly

OFFICIAL BBU INFORMATION										
Expected Progeny Differences:										
	BW	WW	YW	Milk	TM	SC	REA	%IMF	Rib Fat	Rump Fat
EPD	0.4	0	5	1	2	0.0				
ACC	.34	.33	.28	.14	-	.17				
	BW	WW	YW	Scrotal	REA	%IMF	Rib Fat	Rump Fat		
Ratio	100	96								
Contemp.	2	2								
Adj. Trait	70	526								

Another one of the great females produced by Real Deal. Meat, muscle, bone, everything you need in a producing female. Take her home and you will not be sorry you did. Miss BV 2709 was bred to the old great Classic Cotton on 7/14/11, ECD 4/24/12.

Purchaser _____ \$ _____

Brazos Valley Beefmasters

14

OPEN HEIFER

ID No.: **4710 Miss BV 4710**
 Breeder: **Brazos Valley** Birth: **11/7/10**
 BBU No.: **1007324** Color: **Red**

Real Deal 5304 **Painted Tiger **Painted Warrior
 **Dunkin 1-126
 Warrior III 0073
 Elegance 28/1 Southern Princess 0229
 Warrior III 0073
 Captain Sugar 12/02 **Infinity
L2 51/06 **Sugar Ann
 Captain Lucey 116/01
 Lucey's Lady 18/04 Fifteen Maid 15/98

OFFICIAL BBU INFORMATION										
Expected Progeny Differences:										
	BW	WW	YW	Milk	TM	SC	REA	%IMF	Rib Fat	Rump Fat
EPD	0.6	6	9	2	5	0.2				
ACC	PE	PE	PE	PE	PE	PE				
	BW	WW	YW	Scrotal	REA	%IMF	Rib Fat	Rump Fat		
Ratio	100	100								
Contemp.	1	1								
Adj. Trait	65	574								

Here she is, one of the best females to sell in this sale. Miss BV 4710 should be in someone's herd to flush. Her pedigree speaks volumes which goes along with her length, bone and feminine looks. Take this one home and you will be happy you did.

Purchaser _____ \$ _____

Circle S Beefmasters

15

HERDSIRE PROSPECT

ID No.: **018/10**
 Breeder: **Circle S** Birth: **4/5/10**
 BBU No.: **991490** Color: **Red**

Captain Jack 43/07 Captain Lucey 116/01 **Infinity
 DNA US4039456 PV **Farrah Anna **Milk & Honey
 **Synergy
 **Tiger Anna
 Captain Sugar 12/02 **Infinity
Sugar Sugar 97/06 **Sugar Ann
DNA 616884A PV L2 34/04 Encore 117/96
 **Milk & Honey

OFFICIAL BBU INFORMATION										
Expected Progeny Differences:										
	BW	WW	YW	Milk	TM	SC	REA	%IMF	Rib Fat	Rump Fat
EPD	1.8	18	27	3	11	0.4	-0.19	0.1	0.07	-0.01
ACC	.50	.44	.47	.15	-	.31	PE	PE	PE	PE
	BW	WW	YW	Scrotal	REA	%IMF	Rib Fat	Rump Fat		
Ratio	93	100	100		100	100	100	100		
Contemp.	2	1	1		1	1	1	1		
Adj. Trait	97	729	1174		11.84	2.7	0.28	0.43		

CUPLAB SCAN DATA					
Scan Age	Scan Wt.	REA	%IMF	Rib Fat	Rump Fat
373	1200	11.84	2.67	.28	.43

Wow, this prospect has the L2 Ranch look with all the powerful conformation you can desire. Clean sheath and Captain Jack are enough to get your attention but this prospect has the genetics that will complement any breeding program. Sugar Sugar has it all and this prospect will carry it all forward for you.

Purchaser _____ \$ _____

HERDSIRE PROSPECT

ID No.: **11-10**
 Breeder: **Circle S** Birth: **10/23/10**
 BBU No.: **1002900** Color: **Red MUL**

Captain Sugar 12/02 **Infinity
 Sugar Britches 040 **Sugar Ann
 DNA 345274A **Cavalier
**Oasis **Sex Life
**Infinity **Red Sugar
 Infinitely Sexy 46/03 **Vanna
 DNA 1085A **Spartacus
 BT 9382A **Sex Appeal

OFFICIAL BBU INFORMATION

Expected Progeny Differences:										
	BW	WW	YW	Milk	TM	SC	REA	%IMF	Rib Fat	Rump Fat
EPD	1.1	18	19	-1	8	0.4	-0.08	0.1	0.04	0.02
ACC	.50	.45	.41	.15	-	.28	PE	PE	PE	PE
	BW	WW	YW	Scrotal	REA	%IMF	Rib Fat	Rump Fat		
Ratio	89	107	109		105	128	159	132		
Contemp.	4	4	4		4	4	4	4		
Adj. Trait	89	673	1278		13.9	3.3	0.66	0.76		

CUPLAB SCAN DATA

Scan Age	Scan Wt.	REA	%IMF	Rib Fat	Rump Fat
374	1310	13.86	3.30	.66	.77

This is our highest growth performance calf this year. Powerful individuality along with pedigree full of predictable superior producers and individual performance that will be an asset in your calf crop. This is the prospect that can add conformation, performance and pedigree all at once!

Purchaser _____ \$ _____

HERDSIRE PROSPECT

ID No.: **228-10**
 Breeder: **Circle S** Birth: **10/28/10**
 BBU No.: **1002898** Color: **Red MUL**

**Red Sugar **Cherokee Phantom
**Infinity **Sugar Ann
 DNA 674A ***Phantom Warrior
 BT 5956A **Vanna **Madam X 3/293
Lion King 293J17 **Painted Tiger
Wilmoth 44/3 **Lady Victoria
 DNA 765A Wilmoth 33/9 **Synergy
 BT 9009A **Victor's Sister

OFFICIAL BBU INFORMATION

Expected Progeny Differences:										
	BW	WW	YW	Milk	TM	SC	REA	%IMF	Rib Fat	Rump Fat
EPD	0.8	4	9	2	4	0.0	-0.21	0.1	0.03	-0.04
ACC	.51	.48	.44	.29	-	.34	PE	PE	PE	PE
	BW	WW	YW	Scrotal	REA	%IMF	Rib Fat	Rump Fat		
Ratio	90	101	104		98	70	67	87		
Contemp.	4	4	4		4	4	4	4		
Adj. Trait	88	638	1223		13	1.8	0.28	0.5		

CUPLAB SCAN DATA

Scan Age	Scan Wt.	REA	%IMF	Rib Fat	Rump Fat
369	1240	12.91	1.83	.28	.50

Infinity with extra power of Painted Tiger and Lady Victoria and Victor's Sister. These powerful individuals are the kind you can build your program around. This prospect can make your breeding program more predictable as well as profitable!

Purchaser _____ \$ _____

OPEN HEIFER

ID No.: **302-10**
 Breeder: **Circle S** Birth: **10/21/10**
 BBU No.: **1002899** Color: **Red**

Captain Sugar 12/02 **Infinity
 Sugar Britches 040 **Sugar Ann
 DNA 345274A **Cavalier
**Oasis **Sex Life
**Infinity **Red Sugar
 Infinitely Sexy 46/03 **Vanna
 DNA 1085A **Spartacus
 BT 9382A **Sex Appeal

OFFICIAL BBU INFORMATION

Expected Progeny Differences:										
	BW	WW	YW	Milk	TM	SC	REA	%IMF	Rib Fat	Rump Fat
EPD	0.7	17	17	-1	7	0.4	-0.08	0.1	0.04	0.02
ACC	.50	.45	.41	.15	-	.28	PE	PE	PE	PE
	BW	WW	YW	Scrotal	REA	%IMF	Rib Fat	Rump Fat		
Ratio	88	103	100		114	80	114	92		
Contemp.	6	4	4		4	4	4	4		
Adj. Trait	84	570	1006		12.97	2.91	0.71	0.75		

CUPLAB SCAN DATA

Scan Age	Scan Wt.	REA	%IMF	Rib Fat	Rump Fat
376	1035	13.05	2.92	.71	.75

Powerful individual with all the predictable genetics that assure you the superior quality production that any Beefmaster breeder would be proud to own. This is a great set of individuals. Look at her sibling selling here today and in the STBBA sale.

Purchaser _____ \$ _____

OPEN HEIFER

ID No.: **835-10**
 Breeder: **Circle S** Birth: **10/27/10**
 BBU No.: **1002903** Color: **Red MUL**

**Infinity **Cherokee Phantom
DNA 674A **Sugar Ann
BT 5956A ***Phantom Warrior
Wilmoth 44/3 **Vanna **Madam X 3/293
DNa 765A Lion King 293J17 **Painted Tiger
BT 9009A **Lady Victoria
Wilmoth 33/9 **Synergy
**Victor's Sister

OFFICIAL BBU INFORMATION

Expected Progeny Differences:										
	BW	WW	YW	Milk	TM	SC	REA	%IMF	Rib Fat	Rump Fat
EPD	0.5	-2	2	2	1	-0.2	-0.21	0.1	0.03	-0.04
ACC	.52	.48	.44	.29	-	.34	PE	PE	PE	PE
	BW	WW	YW	Scrotal	REA	%IMF	Rib Fat	Rump Fat		
Ratio	84	83	93		83	113	69	83		
Contemp.	6	4	4		4	4	4	4		
Adj. Trait	87	458	935		9.49	4.12	0.43	0.68		

CUPLAB SCAN DATA

Scan Age	Scan Wt.	REA	%IMF	Rib Fat	Rump Fat
370	950	9.44	4.13	.43	.68

Here is your Infinity daughter that will help move your breeding program to new production highs! Maternal genetics second to none and proven superior producers. This is your opportunity to add superior production and value to your breeding program. Top 5% for %IMF.

Purchaser _____ \$ _____

OPEN HEIFER

ID No.: **46-10**
 Breeder: **Circle S** Birth: **11/12/10**
 BBU No.: **1002906** Color: **Red**

Tiger Treasure 81/05 **Painted Tiger **Painted Warrior
DNA 389990A PV Cathy's Treasure **Dunkin 1-126
BT BBU488 **Infinity **Cathy Lee
Priola 46/07 **Red Sugar
Red Red Wine 67/04 **Vanna
Carmenett 15/00

OFFICIAL BBU INFORMATION

Expected Progeny Differences:										
	BW	WW	YW	Milk	TM	SC	REA	%IMF	Rib Fat	Rump Fat
EPD	0.1	5	9	3	5	0.0				
ACC	.28	.24	.23	.17	-	.19				
	BW	WW	YW	Scrotal	REA	%IMF	Rib Fat	Rump Fat		
Ratio	100	100	100		100	100	100	100		
Contemp.	1	1	1		1	1	1	1		
Adj. Trait	76	504	904		8.54	1.06	0.41	0.69		

CUPLAB SCAN DATA

Scan Age	Scan Wt.	REA	%IMF	Rib Fat	Rump Fat
354	874	8.05	1.06	.39	.66

Tiger Treasure is not only an impressive individual that we purchased from the 2007 Houston Magic sale, but here is proof he puts the "right kind" on the ground. This female has the power, thickness and quality of her breeding and your reward for taking her home is the predictable maternal production she brings with her! Remember, Red Red Wine was high seller here two years ago.

Purchaser _____ \$ _____

HERDSIRE PROSPECT

ID No.: **998**
 Breeder: **Cottage Farm** Birth: **5/27/10**
 BBU No.: **995906** Color: **Red**

**Synergy **Cherokee Phantom
DNA 183A **Sugar Ann
BT 5779A **Prissy Lady **Spartacus
**Cavalier **Madam X 3/293
**Oasis **Spartacus
DNA 251620A **Madera 1-5/5
BT 7628A **Sandman
**Sex Life **Sex Appeal

OFFICIAL BBU INFORMATION

Expected Progeny Differences:										
	BW	WW	YW	Milk	TM	SC	REA	%IMF	Rib Fat	Rump Fat
EPD	0.0	33	46	0	17	1.3	-0.15	0.0	0.02	-0.02
ACC	.58	.56	.56	.34	-	.56	PE	PE	PE	PE
	BW	WW	YW	Scrotal	REA	%IMF	Rib Fat	Rump Fat		
Ratio	105	108	114		114	90	119	116		
Contemp.	13	13	10		2	2	2	2		
Adj. Trait	69	654	1284		39.49	13.89	2.23	0.43	0.66	

CF 998 is a remarkable young herdsire prospect. Meat and thickness, yet very correct in his phenotype and structure. His dam Oasis keeps stamping out the breed's top herdsires. His sire Synergy is extremely popular and has four sons to take his place. Here is your opportunity to add Oasis and Synergy to your herd. Certified free herd #8416.

Purchaser _____ \$ _____

A. PICK OF OPEN HEIFERS

ID No.: **462**
 Breeder: **Cottage Farm** Birth: **1/4/11**
 BBU No.: **1003445** Color: **Red**

A. OFFICIAL BBU INFORMATION										
Expected Progeny Differences:										
	BW	WW	YW	Milk	TM	SC	REA	%IMF	Rib Fat	Rump Fat
EPD	-0.5	31	36	-2	14	1.0				
ACC	.54	.51	.45	.17	-	.31				
	BW	WW	YW	Scrotal	REA	%IMF	Rib Fat	Rump Fat		
Ratio	101	104	111							
Contemp.	12	10	8							
Adj. Trait	69	567	850							

B. PICK OF OPEN HEIFERS

ID No.: **458**
 Breeder: **Cottage Farm** Birth: **1/4/11**
 BBU No.: **1003444** Color: **Red**

B. OFFICIAL BBU INFORMATION										
Expected Progeny Differences:										
	BW	WW	YW	Milk	TM	SC	REA	%IMF	Rib Fat	Rump Fat
EPD	-0.9	31	36	-2	14	1.0				
ACC	.54	.51	.45	.17	-	.31				
	BW	WW	YW	Scrotal	REA	%IMF	Rib Fat	Rump Fat		
Ratio	108	106	110							
Contemp.	12	10	8							
Adj. Trait	64	578	845							

French Connection 142
 DNA 514037A PV French Kiss 397
 **Oasis
 DNA 251620A
 BT 7628A

Captain Sugar 12/02 **Infinity
French Connection 142 **Sugar Ann
DNA 514037A PV French Kiss 397 **Spartacus
**Oasis **Sex Appeal
DNA 251620A **Cavalier **Spartacus
BT 7628A **Sex Life **Madera 1-5/5
**Sex Appeal **Sandman
**Sex Appeal **Sex Appeal

Oasis has become one of the most prolific producers of both herdsires and females in the history of the breed. These two outstanding French Connection daughters will make exceptional cows. Strong performance backed by great genetics. Certified free herd #8416.

Purchaser _____ \$ _____

BRED HEIFER

ID No.: **1003 Sugar Chic**
 Breeder: **Four B** Birth: **1/17/10**
 BBU No.: **990727** Color: **Red**
 Al'd To: **Adrenaline, 965778 (10/1/11)**
 Clean Up: **Cottage Farm 973, 995943**

Captain Sugar 12/02 **Infinity
Sugar Britches 040 **Sugar Ann
DNA 345274A **Oasis **Cavalier
**Xcite **Sex Life
Wilmoth 117/3 **Desperado
DNA 373626A dam of Nirvana **Miss Lee
BT BBU438 **Synergy
**Victor's Sister

OFFICIAL BBU INFORMATION										
Expected Progeny Differences:										
	BW	WW	YW	Milk	TM	SC	REA	%IMF	Rib Fat	Rump Fat
EPD	-0.8	12	12	-2	4	0.4				
ACC	.48	.34	.33	.15	-	.23				
	BW	WW	YW	Scrotal	REA	%IMF	Rib Fat	Rump Fat		
Ratio	103									
Contemp.	3									
Adj. Trait	59									

Sugar Chic has excited everyone since we purchased her at Tom & Judy Bell's last sale as a weaning heifer. If not for the weak housing market, she would be a mainstay in our herd. Super powerful female going back to the dam of Nirvana. Great donor prospect bred to Adrenaline for great results. Certified free herd #8416.

Purchaser _____ \$ _____

OPEN HEIFER

ID No.: **9/1**
 Breeder: **Circle J** Birth: **10/28/10**
 BBU No.: **993950** Color: **Red MUL**

**Painted Warrior **Robert E. Lee
**Painted Tiger **Barfield 8/123
DNA US3000923 **Dunkin 1-126 McCullars 116
BT 3081B **Volunteer 66
**Synergy **Red Sugar
Sexy Sugar 36/3 **Prissy Lady
DNA 314963A PV **Sexy Lady **Sandman
BT BBU223 **Sex Appeal

OFFICIAL BBU INFORMATION										
Expected Progeny Differences:										
	BW	WW	YW	Milk	TM	SC	REA	%IMF	Rib Fat	Rump Fat
EPD	1.2	7	10	3	6	0.2	-0.16	-0.1	-0.04	-0.09
ACC	PE	PE	PE	PE	PE	PE	PE	PE	PE	PE

Painted Tiger daughters are in high demand and here is one of his best. Bottom side of her pedigree represents some of the best cattle in the industry. Collier Farms owns several full sisters to this exciting young donor prospect. Certified free herd #8416.

Purchaser _____ \$ _____

Cottage Farm

25

OPEN HEIFER

ID No.: **1010**
 Breeder: **Cottage Farm** Birth: **1/3/11**
 BBU No.: **1003439** Color: **Red**

Adrenaline 170
 DNA US3000940 PV ****Infinity** ****Red Sugar**
****Vanna**
****Cavalier**
****Sex Life**
****Painted Tiger**
****Miss Gladys**
****Red Tiger** ****Red Sugar**
****Prissy Lady**

Red Prissy 0277NZ
 DNA 595621A **L2 75/95**

BT 7593A

OFFICIAL BBU INFORMATION

Expected Progeny Differences:										
	BW	WW	YW	Milk	TM	SC	REA	%IMF	Rib Fat	Rump Fat
EPD	-0.1	17	23	3	11	0.5				
ACC	.50	.45	.39	.17	-	.24				
	BW	WW	YW	Scrotal	REA	%IMF	Rib Fat	Rump Fat		
Ratio	101	101	106							
Contemp.	12	10	8							
Adj. Trait	69	555	819							

One of the first Adrenaline heifers offered for sale. She's thick, powerful and correct. Her dam is the great Red Prissy female going back to Prissy Lady. Incredibly predictable genetic makeup ensures consistent results. Certified free herd #8416.

Purchaser _____ \$ _____

D&D Beefmasters

26

BRED HEIFER

ID No.: **108 Southern Rose**
 Breeder: **Raburn** Birth: **5/12/10**
 BBU No.: **988900** Color: **Red WP**
 Al'd To: **Dream Catcher, 977250 (12/14/11; ECD 9/24/12)**

Legendary 906
 DNA 403178A ****Spartacus** ****Gladiator**
****Dreamlady**
****Red Tiger**
****Baby Doll**
****Cherokee Phantom**
HMS 669/4
****Spartacus**
****Christopher 628** **Christopher 255**

Cherokee Bandit 707

Christopher 992

OFFICIAL BBU INFORMATION

Expected Progeny Differences:										
	BW	WW	YW	Milk	TM	SC	REA	%IMF	Rib Fat	Rump Fat
EPD	0.7	7	11	-5	-1	0.1	0.01	-0.1	-0.05	0.04
ACC	.23	.29	.34	.12	-	.15	.29	.33	.33	.36
	BW	WW	YW	Scrotal	REA	%IMF	Rib Fat	Rump Fat		
Ratio			98		107	110	90	99		
Contemp.			4		3	3	3	3		
Adj. Trait			759		10.88	3.32	0.2	0.37		

CUPLAB SCAN DATA

Scan Age	Scan Wt.	REA	%IMF	Rib Fat	Rump Fat
371	772	10.85	3.29	.20	.37

Southern Rose is one I wanted to keep. She is out of my Spartacus bull, Legendary, and a great producing Christopher female. Al'd to Dream Catcher. All you have to do is take a good look at her, you will want to take her home and reap the rewards of her production and the Dream Catcher calf coming!

Purchaser _____ \$ _____

D&D Beefmasters/Sierra's Love DISPLAY

BULL

ID No.: **509 Dream Man**
 Breeder: **Raburn** Birth: **9/14/09**
 BBU No.: **986617** Color: **Dk. Red**

BT 3116A
****Spartacus** ****Gladiator** **Gator 3**
****Dreamlady** **Circle Dot 8/17**
Multiple
Harrell 8/5
****Havana**
****Miss Dee**
****Sir Kiffer**
****Thornbush T129**

Francey 1581/1
 DNA 389063A **HMS 960/6**

BT BBU484

OFFICIAL BBU INFORMATION

Expected Progeny Differences:										
	BW	WW	YW	Milk	TM	SC	REA	%IMF	Rib Fat	Rump Fat
EPD	1.0	5	6	-6	-4	-0.1	-0.11	-0.1	-0.3	0.05
ACC	.36	.34	.33	.29	-	.28	PE	PE	PE	PE
	BW	WW	YW	Scrotal	REA	%IMF	Rib Fat	Rump Fat		
Ratio			100		100	100	100	100		
Contemp.			1		1	1	1	1		
Adj. Trait			1157		14.21	1.91	0.36	0.52		

DNA 9000817613 PV. Dream Man represents what we believe to be the complete Beefmaster bull. He has the genetics, eye appeal, color, performance and conformation that we love in a Beefmaster. Come see for yourself! His first calves are being born now and they look great! Semen is priced at \$50 per unit with a 5 unit minimum purchase. Contact us or Bruce Robbins with any questions.

Purchaser _____ \$ _____

PAIR

ID No.: **2811/7** Calf At Side: **Heifer**
 Breeder: **HMS** ID No.: **5411**
 BBU No.: **960370** BBU No.: **AF**
 Birth: **8/16/07** Birth: **12/30/11**
 Color: **Red Paint** Color: **Red**

Captain Sugar 12/02 **Infinity
Sugar Bear 933 **Sugar Ann
DNA US3000936 PV **Cavalier
**Oasis **Sex Life
**Painted Tiger **Painted Warrior
HMS 2811/7 DNA US3000923 **Dunkin 1-126
BT 3081B **Infinity
Windy Hills 2067 Temptation 9006
DNA 696A, BT 8925A

OFFICIAL BBU INFORMATION										
Classification:	U	Conformation:				Underline:				
Expected Progeny Differences:										
	BW	WW	YW	Milk	TM	SC	REA	%IMF	Rib Fat	Rump Fat
EPD	0.9	.6	.10	.1	.4	.0.2				
ACC	.50	.47	.42	.31	-	.34				
	BW	WW	YW	Scrotal	REA	%IMF	Rib Fat	Rump Fat		
Ratio	100	100								
Contemp.	1	1								
Adj. Trait	74	470								

Pretty Painted Tiger that has the superior maternal genetics that will boost her production past the majority of the breed. Proof is standing at her side, one of the first Sugar Bear babies born and shows the power of both her parents. This is a tremendous opportunity and can be a great asset to any breeding program. Pedigree of calf.

Purchaser _____ \$ _____

PAIR

ID No.: **993 Angel Ann** Calf At Side: **Heifer**
 Breeder: **TVR** ID No.: **3411**
 BBU No.: **991398** BBU No.: **1009456**
 Birth: **9/1/09** Birth: **10/16/11**
 Color: **Dk. Red** Color: **Red**

Full Throttle 172 **Infinity **Red Sugar
**Vanna
**Cavalier
**Oasis **Sex Life
**Red Tiger
Equity 8295A **Prissy Lady
Angel Ann 993 DNA 397611A
BT 7973A Onyx 415-1
TVR 618 Nelaz 6072

OFFICIAL BBU INFORMATION										
Classification:	U	Conformation:				Underline:				
Expected Progeny Differences:										
	BW	WW	YW	Milk	TM	SC	REA	%IMF	Rib Fat	Rump Fat
EPD	1.3	0	2	3	3	-0.3	-0.01	-0.1	-0.02	-0.09
ACC	.44	.41	.36	.15	-	.21	PE	PE	PE	PE
	BW	WW	YW	Scrotal	REA	%IMF	Rib Fat	Rump Fat		
Ratio	90	90								
Contemp.	4	5								
Adj. Trait	73	513								

Angel Ann has the power of her pedigree--293 and Sugar Ann--to help her produce exactly what you desire. First calf female that has an excellent Full Throttle calf at side that brings Vanna and Oasis. This is the Who's Who of the Beefmaster breed. Put them to work for you! Pedigree of calf.

Purchaser _____ \$ _____

POLLED PAIR

ID No.: **2809** Calf At Side: **Bull**
 Breeder: **J&T Farm** ID No.: **3711**
 BBU No.: **997563** BBU No.: **1009457**
 Birth: **8/27/09** Birth: **11/12/11**
 Color: **Dk. Red** Color: **Red**

Jackpot 2/927 **Black Jack 21 **Black Magic
DNA 324915A PV Miss Staci 927 Missy 8-1
BT 8173A **Grand Cherokee
**Spartacus Miss Awesome 646
J&T 2809 DNA 9A, BT 3116A **Gladiator
Excitingly Red 11/07 **Dreamlady
**Xcite
Red Diva 92/99

OFFICIAL BBU INFORMATION										
Expected Progeny Differences:										
	BW	WW	YW	Milk	TM	SC	REA	%IMF	Rib Fat	Rump Fat
EPD	1.0	7	9	-8	-5	0.0				
ACC	PE	PE	PE	PE	PE	PE	PE			

Young Spartacus that has what you are looking for on her maternal side. Spartacus daughters consistently bring great production and this Jackpot bull shows the strength of mama and daddy. Strong young pair with the color you love! Pedigree of calf.

Purchaser _____ \$ _____

BRED COW

ID No.: **697**
 Breeder: **Dunkin** Birth: **3/10/07**
 BBU No.: **950333** Color: **Red**
 Bred To: **Beau Britches, 989879**

****Spartacus** ****Gladiator**
****Cavalier** ****Dreamlady**
 DNA 302A ****Madera 1-5/5** *****Ranger's Pride**
 BT 5679A ****Kentucky Princess**
Tiger Sugar 64/91 ****Painted Tiger**
Tiger Farrah 293H10 ****Sugar Ann**
 DNA 1000A ****Farrah Lady** ****J Fifteen**
 BT 9313A ****Madam X 3/293**

OFFICIAL BBU INFORMATION

Classification:	U	Conformation:							Underline:		
Expected Progeny Differences:											
	BW	WW	YW	Milk	TM	SC	REA	%IMF	Rib Fat	Rump Fat	
EPD	-0.2	-3	-12	2	0	-0.1	-0.23	0.0	0.05	-0.05	
ACC	.54	.51	.51	.34	-	.36	.42	.44	.42	.33	
	BW	WW	YW	Scrotal	REA	%IMF	Rib Fat	Rump Fat			
Ratio	101	94	88		96	112	79	72			
Contemp.	10	6	4		4	4	4	4			
Adj. Trait	74	407	713		9.05	5.81	0.34	0.49			

Full sister to Dunkin 4D's Tequilla Sunrise, this Cavalier x Tiger Farrah daughter is bred to our Sugar Britches son, Beau Britches, selling as lot 42. Her yearling ultrascan results included a whopping REA/cwt of 1.24 and an IMF of 5.79! With Beau Britches' REA/cwt of 1.31, this combination is destined to produce thick! ECD 7/10/12. Certified free herd #962694040.

Purchaser _____ \$ _____

BRED HEIFER

ID No.: **0-22 Summer Sunshine**
 Breeder: **KC Beefmasters** Birth: **3/25/10**
 BBU No.: **995150** Color: **Red SF MUL**
 Bred To: **Red Tiger, 429021 (ECD 8/31/12)**

****Infinity** ****Red Sugar**
 Captain Sugar 12/02 ****Vanna**
 DNA 134A *****Ranger's Pride**
 BT 7526A ****Sugar Ann** ****EMS 6-2**
****Cavalier** ****Spartacus**
 Sunshine 105J2 ****Madera 1-5/5**
 BT 6930E ****REL** ****Robert E. Lee**
 Cherokee 105

OFFICIAL BBU INFORMATION

Expected Progeny Differences:										
	BW	WW	YW	Milk	TM	SC	REA	%IMF	Rib Fat	Rump Fat
EPD	-0.4	7	3	1	4	0.2	-0.29	0.0	-0.04	-0.13
ACC	.54	.51	.50	.26	-	.36	.41	.44	.42	.45
	BW	WW	YW	Scrotal	REA	%IMF	Rib Fat	Rump Fat		
Ratio	98	101	102		96	110	86	92		
Contemp.	3	3	3		3	3	3	3		
Adj. Trait	59	440	787		9.79	3.69	0.2	0.44		

DNA US4018560 PV. This Captain Sugar x Sunshine combination has consistently produced exceptional heifers. Summer Sunshine sells safe bred to Red Tiger. This should be a great combination (Painted Tiger, Captain Sugar and Cavalier!). Her yearling scan results were excellent and included a REA/cwt of 1.21 @ 822 lbs. with an IMF of 3.69! KC Beefmasters is a BBU whole herd reporting member. Certified free herd #962694040.

Purchaser _____ \$ _____

BRED HEIFER

ID No.: **0-24 Princess Cavalier**
 Breeder: **KC Beefmasters** Birth: **4/7/10**
 BBU No.: **989887** Color: **Red SF MUL**
 Bred To: **Secret Storm, 989890 (ECD 5/12/12)**

****Spartacus** ****Gladiator**
****Cavalier** ****Dreamlady**
 DNA 302A ****Madera 1-5/5** *****Ranger's Pride**
 BT 5679A ****Kentucky Princess**
Captain Lucey 116/01 ****Infinity**
Vicky Lu 3/07 ****Milk & Honey**
 DNA 544635A PV **Victoria 145/00** ****Red Sugar**
****Victor's Sister**

OFFICIAL BBU INFORMATION

Expected Progeny Differences:										
	BW	WW	YW	Milk	TM	SC	REA	%IMF	Rib Fat	Rump Fat
EPD	1.2	9	6	0	5	0.0	-0.34	0.0	0.03	-0.03
ACC	.39	.39	.38	.31	-	.33	.28	.28	.26	.26
	BW	WW	YW	Scrotal	REA	%IMF	Rib Fat	Rump Fat		
Ratio	100	100	100		100	100	100	100		
Contemp.	1	1	1		1	1	1	1		
Adj. Trait	67	623	924		10.49	3.32	0.41	0.32		

DNA US4041913 PV. This Cavalier daughter out of a Victor's Sister granddaughter is hard to part with. Her yearling scan report at 940 lbs. included REA 10.37, REA/cwt 1.1, and IMF of 3.29. Selling heavy bred to our solid red bull, Secret Storm. He is by Captain Jack out of our premier donor Sweet Secret (Painted Tiger x Secret Sensation). ECD 5/12/12. Certified free herd #962694040.

Purchaser _____ \$ _____

HERD BULL

ID No.: **0-29 Beau Britches**
 Breeder: **KC Beefmasters** Birth: **4/20/10**
 BBU No.: **989879** Color: **Red**

Captain Sugar 12/02 **Infinity
**Sugar Ann
 Sugar Britches 040 **Cavalier
 DNA 345274A **Oasis **Sex Life
CJ 721
 Soul Man 168 Soulmans Momma 928
 Graceful Soul R7-4 **Spartacus
 DNA 544639A PV Amazing Grace 293J Victoria's Secret 72/91

OFFICIAL BBU INFORMATION

Expected Progeny Differences:										
	BW	WW	YW	Milk	TM	SC	REA	%IMF	Rib Fat	Rump Fat
EPD	1.4	19	28	1	10	0.7	0.11	0.1	0.04	0.02
ACC	.48	.45	.44	.15	-	.44	PE	PE	PE	PE
	BW	WW	YW	Scrotal	REA	%IMF	Rib Fat	Rump Fat		
Ratio	93	105	108		113	105	122	115		
Contemp.	4	3	3		3	3	3	3		
Adj. Trait	79	697	1216	33.75	15.67	2.1	0.37	0.47		

DNA US4018536 PV. Fabulous Sugar Britches son, solid red and thick. Yearling scan results @ 1170 lbs.: REA 15.27, REA/cwt 1.31, IMF 2.11. We have used him on our heifers and should see his first production in May. This guy has what it takes to improve your herd. We hate to let him go. Certified free herd #962694040.

Purchaser _____ \$ _____

OPEN HEIFER

ID No.: **1-4 Secret Wish**
 Breeder: **KC Beefmasters** Birth: **1/14/11**
 BBU No.: **1001009** Color: **Red**

Captain Lucey 116/01 **Infinity
**Milk & Honey
 Captain Jack 43/07 **Synergy
 DNA US4039456 PV **Farrah Anna **Tiger Anna
**Painted Warrior
**Painted Tiger **Dunkin 1-126
 Sweet Secret 434 **Spartacus
 DNA 994A **Secret Sensation Victoria's Secret 72/91
 BT 9307A

OFFICIAL BBU INFORMATION

Expected Progeny Differences:										
	BW	WW	YW	Milk	TM	SC	REA	%IMF	Rib Fat	Rump Fat
EPD	0.9	12	21	3	9	0.3	-0.10	-0.1	0.02	0.06
ACC	.34	.34	.33	.17	-	.26	PE	PE	PE	PE
	BW	WW	YW	Scrotal	REA	%IMF	Rib Fat	Rump Fat		
Ratio	100	100								
Contemp.	1	1								
Adj. Trait	81	746								

Captain Jack daughter out of our premier donor, Sweet Secret. Great EPDs across the board (WW +12, YW +19). Halter broken and shown by the Stephen F Austin show team. Open and ready to join your herd or continue her show career. Certified free herd #962694040.

Purchaser _____ \$ _____

OPEN HEIFER

ID No.: **0-48 Tiger Sunrise**
 Breeder: **KC Beefmasters** Birth: **11/22/10**
 BBU No.: **1002778** Color: **Red**

**Painted Warrior **Robert E. Lee
**Barfield 8/123
**Painted Tiger McCollars 116
 DNA US3000923 **Dunkin 1-126 **Volunteer 66
 BT 3081B **Spartacus
**Cavalier **Madera 1-5/5
 Sunshine 105J2 **Robert E. Lee
 BT 6930E **REL Cherokee 105

OFFICIAL BBU INFORMATION

Expected Progeny Differences:										
	BW	WW	YW	Milk	TM	SC	REA	%IMF	Rib Fat	Rump Fat
EPD	0.2	7	9	3	7	0.3	-0.08	-0.1	-0.02	-0.04
ACC	.52	.42	.41	.33	-	.33	PE	PE	PE	PE
	BW	WW	YW	Scrotal	REA	%IMF	Rib Fat	Rump Fat		
Ratio	95									
Contemp.	3									
Adj. Trait	69									

Solid light red Painted Tiger daughter out of our great donor, Sunshine, who is by Cavalier. There are only 3 from this flush. We are keeping one of them in our herd. Scan results (actual numbers): IMF 3.03, REA/cwt 1.17 @ 830 lbs. She is open and ready to breed. Certified free herd #962694040.

Purchaser _____ \$ _____

OPEN HEIFER

ID No.: **1-6 Princess Prada**
 Breeder: **KC Beefmasters** Birth: **3/16/11**
 BBU No.: **1001011** Color: **Red MUL**

**Cavalier **Spartacus
**Madera 1-5/5
 Kentucky Prince 981 **Cherokee Phantom
 BT 7175A Misty 605/6 **Royal Lady
**Infinity
Captain Lucey 116/01 **Milk & Honey
 Lady Prada 7119 **Cavalier
 DNA US4018488 PV Carmelitta 16/05 Carmenett 15/00

OFFICIAL BBU INFORMATION

Expected Progeny Differences:										
	BW	WW	YW	Milk	TM	SC	REA	%IMF	Rib Fat	Rump Fat
EPD	0.3	1	-3	-1	0	-0.1				
ACC	.47	.33	.29	.19	-	.21				
	BW	WW	YW	Scrotal	REA	%IMF	Rib Fat	Rump Fat		
Ratio	108	99								
Contemp.	3	2								
Adj. Trait	70	621								

Really nice dark red Kentucky Prince daughter out of our Carmelitta daughter, Lady Prada, that we purchased from Tom & Judy Bell. She is halter broken and has been shown by the Stephen F Austin show team. You can continue her show career or put her directly into your herd. Certified free herd #962694040.

Purchaser _____ \$ _____

KC Beefmasters

46

OPEN HEIFER

ID No.: **1-10 Sweet Liberty**
 Breeder: **KC Beefmasters** Birth: **3/27/11**
 BBU No.: **1001015** Color: **Red MUL**

	<u>Captain Sugar 12/02</u>	<u>**Infinity</u>
<u>French Connection 142</u>		<u>**Sugar Ann</u>
<u>DNA 514037A PV</u>	<u>French Kiss 397</u>	<u>**Spartacus</u>
		<u>**Sex Appeal</u>
	<u>**Painted Tiger</u>	<u>**Painted Warrior</u>
<u>Sweet Secret 434</u>		<u>**Dunkin 1-126</u>
<u>DNA 994A</u>	<u>**Secret Sensation</u>	<u>**Spartacus</u>
<u>BT 9307A</u>		<u>Victoria's Secret 72/91</u>

OFFICIAL BBU INFORMATION

Expected Progeny Differences:										
	BW	WW	YW	Milk	TM	SC	REA	%IMF	Rib Fat	Rump Fat
EPD	0.1	9	12	0	4	0.2				
ACC	.29	.29	.28	.15	-	.21				
	BW	WW	YW	Scrotal	REA	%IMF	Rib Fat	Rump Fat		
Ratio	100	100								
Contemp.	1	1								
Adj. Trait	64	530								

DNA US4058480 PV. This is the only heifer produced out of our flush between Lyssey's French Connection herdsire and our premier donor, Sweet Secret (Painted Tiger x Secret Sensation). Scanned early (295 days); actual results include IMF 2.23, REA/cwt 1.21 @ 660 lbs. Take advantage of this unique opportunity and add her to your herd. Certified free herd #962694040.

Purchaser _____ \$ _____

Kreger Beefmasters

47

BULL

ID No.: **4/0**
 Breeder: **Kreger** Birth: **3/30/10**
 BBU No.: **1003078** Color: **Dk. Red**

	<u>Gator 3</u>
<u>**Gladiator</u>	<u>Circle Dot 8/17</u>
<u>**Spartacus</u>	<u>Multiple</u>
<u>DNA 9A</u>	<u>Harrell 8/5</u>
<u>BT 3116A</u>	
	<u>**Levi</u>
<u>Achtung 215</u>	
<u>BT 6657A</u>	<u>**Ranger's Pride</u>
	<u>Wicker 197</u>
	<u>**Twelve Oaks 649</u>

OFFICIAL BBU INFORMATION

Expected Progeny Differences:										
	BW	WW	YW	Milk	TM	SC	REA	%IMF	Rib Fat	Rump Fat
EPD	1.9	12	14	-5	1	0.1	-0.01	-0.1	0.00	0.08
ACC	.52	.52	.51	.39	-	.38	PE	PE	PE	PE
	BW	WW	YW	Scrotal	REA	%IMF	Rib Fat	Rump Fat		
Ratio	102	92	98		98	125	100	145		
Contemp.	4	4	4		4	4	4	4		
Adj. Trait	79	506	809		8.46	2.13	0.08	0.16		

Spartacus genetics are in high demand and this bull is out of the most prolific cow in our herd's history, est. 1977. She has produced numerous herdsires including the 2005 STBBA Grand Champion. His full sister sells as lot 49.

Purchaser _____ \$ _____

Kreger Beefmasters

48

BULL

ID No.: **92/0 JK The Source**
 Breeder: **Kreger** Birth: **5/12/10**
 BBU No.: **1003066** Color: **Red SF MUL**

	<u>**Gladiator</u>
<u>**Spartacus</u>	<u>**Dreamlady</u>
<u>**Cavalier</u>	<u>***Ranger's Pride</u>
<u>DNA 302A</u>	<u>**Kentucky Princess</u>
<u>BT 5679A</u>	<u>**Robert E. Lee</u>
	<u>**Phantom</u>
<u>Edelweiss 50/1</u>	<u>**Lady Phantom</u>
<u>DNA 630849A</u>	<u>***Levi</u>
	<u>**Twelve Oaks 649</u>
	<u>Achtung 215</u>

OFFICIAL BBU INFORMATION

Expected Progeny Differences:										
	BW	WW	YW	Milk	TM	SC	REA	%IMF	Rib Fat	Rump Fat
EPD	1.4	2	-7	-1	0	-0.3	-0.19	0.1	0.03	0.00
ACC	.51	.50	.50	.34	-	.34	PE	PE	PE	PE
	BW	WW	YW	Scrotal	REA	%IMF	Rib Fat	Rump Fat		
Ratio	97	93	89		90	135	125	71		
Contemp.	11	13	11		11	10	11	10		
Adj. Trait	81	567	848		9.64	2.42	0.11	0.12		

The Source is a herdsire prospect from some of the most reliable genetics in the history of our breed. His dam is still a strong producer in our herd at 11 years old. The Achtung cow family is known for producing good herdsires.

Purchaser _____ \$ _____

Kreger Beefmasters

49

BRED HEIFER

ID No.: **6/0 JK Adventure**
 Breeder: **Kreger** Birth: **3/20/10**
 BBU No.: **996586** Color: **Red**
 Al'd To: **Red Sugar, 529759 (12/15/11)**
 Clean Up: **JK The Source, 1003066**

	<u>Gator 3</u>
<u>**Gladiator</u>	<u>Circle Dot 8/17</u>
<u>**Spartacus</u>	<u>Multiple</u>
<u>DNA 9A</u>	<u>Harrell 8/5</u>
<u>BT 3116A</u>	
	<u>**Levi</u>
<u>Achtung 215</u>	
<u>BT 6657A</u>	<u>**Twelve Oaks 649</u>
	<u>***Ranger's Pride</u>
	<u>Wicker 197</u>

OFFICIAL BBU INFORMATION

Expected Progeny Differences:										
	BW	WW	YW	Milk	TM	SC	REA	%IMF	Rib Fat	Rump Fat
EPD	2.1	14	16	-5	2	0.1	-0.01	-0.1	0.00	0.08
ACC	.42	.42	.41	.39	-	.36	PE	PE	PE	PE
	BW	WW	YW	Scrotal	REA	%IMF	Rib Fat	Rump Fat		
Ratio	100	100								
Contemp.	1	1								
Adj. Trait	99	496								

We are able to sell some great young Achtung daughters like Adventure because she was such a solid, long-term producer. We only flushed her to Spartacus once, but it yielded 3 strong herdsire prospects and 3 donor prospects. Her full brother is selling as lot 47. Adventure's udder and productive traits will be outstanding.

Purchaser _____ \$ _____

Little Horn

53

OPEN HEIFER

ID No.: **146**
 Breeder: **Little Horn** Birth: **4/2/11**
 BBU No.: **1006082** Color: **Red**

Captain Sugar 12/02 **Infinity
 French Connection 142 **Sugar Ann
 DNA 514037A PV **Spartacus
 French Kiss 397 **Sex Appeal
 Sable 44/4 **Country Western
 Honey "V" SV13 **Magic Mom
 Mr V 4/5
 Bit O Honey 724

OFFICIAL BBU INFORMATION

Expected Progeny Differences:										
	BW	WW	YW	Milk	TM	SC	REA	%IMF	Rib Fat	Rump Fat
EPD	0.3	7	12	-1	3	-0.1				
ACC	.44	.41	.36	.14	-	.21				
	BW	WW	YW	Scrotal	REA	%IMF	Rib Fat	Rump Fat		
Ratio	103	95								
Contemp.	4	5								
Adj. Trait	69	512								

Very feminine French Connection daughter out of an excellent Black Magic x Honey "V" cow. We are very impressed with the French Connection calves and think they have great potential.

Purchaser _____ \$ _____

Ultimate Princess Syndicate

55

POLLED PROVEN DONOR PAIR

ID No.: **HF 479 Ultimate** Calf At Side: **Bull**
 Breeder: **Harrod Princess** ID No.: **28**
 BBU No.: **913162** BBU No.: **AF**
 Birth: **9/7/04** Birth: **9/29/11**
 Color: **Lt. Red** Color: **Red**

O'Sugar 043 **Infinity
 DNA 463926A PV **Sugar Ann
**Cavalier
**Sex Life
 CJ 721
 Soul Man 168 Soulmans Momma 928
 Ultimate Princess DNA US3000427
 BT 7670A **Spartacus
 DNA 301017A Little Princess 590
 BT BBU127 DNA 346212A
 BT 7538D **Madera 1-5/5

OFFICIAL BBU INFORMATION

Expected Progeny Differences:										
	BW	WW	YW	Milk	TM	SC	REA	%IMF	Rib Fat	Rump Fat
EPD	3.6	6	12	-1	2	-0.2	-0.02	0.2	0.05	0.00
ACC	.64	.52	.48	.31	-	.34	.33	.31	.29	.31

DNA 301017A, BT BBU127. Tremendous opportunity to put the quality production of Little Princess--sister to Cavalier--in your breeding program. The superior female has flushed great and is being offered only because she has produced so well. Unique opportunity and a great individual. Pedigree of calf.

Purchaser _____ \$ _____

Little Horn

54

OPEN HEIFER

ID No.: **147**
 Breeder: **Little Horn** Birth: **4/25/11**
 BBU No.: **1006083** Color: **Dk. Red**

Captain Sugar 12/02 **Red Sugar
 DNA 134A **Vanna
 BT 7526A ***Ranger's Pride
 Goldie 74/08 **EMS 6-2
 DNA 505177A PV **Gladiator
 Circle C 114/0 **Dreamlady
 Cherokee Lee 5-10-246 **Painted Tiger

OFFICIAL BBU INFORMATION

Expected Progeny Differences:										
	BW	WW	YW	Milk	TM	SC	REA	%IMF	Rib Fat	Rump Fat
EPD	1.4	10	11	-1	4	0.1				
ACC	.39	.47	.42	.24	-	.33				
	BW	WW	YW	Scrotal	REA	%IMF	Rib Fat	Rump Fat		
Ratio	100	102								
Contemp.	1	5								
Adj. Trait	77	550								

Tremendous opportunity to purchase a young heifer with the top genetics of today. Captain Sugar daughter out of a Spartacus/Painted Tiger cow. Don't miss this one.

Purchaser _____ \$ _____

Lloyd & Lloyd Farms

56

BRED FEMALE

ID No.: **257**
 Breeder: **Lloyd & Lloyd** Birth: **1/4/06**
 BBU No.: **930137** Color: **Red SF**
 Bred To: **O'Sugar, 940597**

**Gladiator
**Dreamlady
***Ranger's Pride
**Kentucky Princess
***King Cotton
**Phannie Mae
***Ranger's Pride
**EMS 6-2

**Spartacus
**Cavalier
 DNA 302A **Madera 1-5/5
 BT 5679A **Cherokee Phantom
 Baby's Sister 25/7 **Miss Lee

OFFICIAL BBU INFORMATION

Expected Progeny Differences:										
	BW	WW	YW	Milk	TM	SC	REA	%IMF	Rib Fat	Rump Fat
EPD	0.8	3	-2	-3	-1	-0.1				
ACC	PE	PE	PE	PE	PE	PE				

Cavalier daughters are great producers and this one is heavy bred to our herdsire, O'Sugar, the flushmate to Sugar Britches and out of a Miss Lee daughter that is full sister to Sugar Baby, Lady In Red, Miss Leigh Ann, and Vanilla Ice, to name a few. Bred right and coming soon with a great coupon!

Purchaser _____ \$ _____

BRED FEMALE

ID No.: **331**
 Breeder: **Lloyd & Lloyd** Birth: **12/3/07**
 BBU No.: **963832** Color: **Dk. Red MF WUL**
 Bred To: **O'Sugar, 940597**

	<u>**Infinity</u>	<u>**Red Sugar</u>
Captain Sugar 12/02	<u>**Vanna</u>	<u>**Ranger's Pride</u>
DNA 134A	<u>**Sugar Ann</u>	<u>**EMS 6-2</u>
BT 7526A		<u>***King Cotton</u>
	<u>**Cherokee Phantom</u>	<u>**Phannie Mae</u>
Jungle Fever 3019/5		<u>**Gladiator</u>
DNA 294120A	<u>**Jungle Red</u>	<u>Mariposa 104</u>
BT 6303B		

OFFICIAL BBU INFORMATION

Expected Progeny Differences:										
	BW	WW	YW	Milk	TM	SC	REA	%IMF	Rib Fat	Rump Fat
EPD	0.5	-1	-2	2	2	-0.3				
ACC	PE	PE	PE	PE	PE	PE				

Tremendous opportunity to add Sugar Ann and Jungle Red. This simply does not happen. One of only 3 in the breed. She is bred to O'Sugar to calve this fall and you can begin building a breeding program around her and her production.

Purchaser _____ \$ _____

EXPOSED PAIR

ID No.: **2892** Calf At Side: **Heifer**
 Breeder: **Lloyd & Lloyd** ID No.: **21**
 BBU No.: **975278** BBU No.: **AF**
 Birth: **9/19/08** Birth: **8/31/11**
 Color: **Red** Color: **Red MUL**
 Exposed To: **O'Sugar, 940597**

	<u>Captain Sugar 12/02</u>	<u>**Infinity</u>
O'Sugar 043	<u>**Sugar Ann</u>	<u>**Cavalier</u>
DNA 463926A PV	<u>**Oasis</u>	<u>**Sex Life</u>
	<u>The Electric Co. 3155</u>	<u>Equity 8295A</u>
Lloyd & Lloyd 2892	<u>DNA 298502A</u>	<u>Black Jack's Sister</u>
	<u>BT BBU61</u>	<u>**Mr Coffee</u>
	<u>Lloyd & Lloyd 97</u>	<u>Spring Fever 815</u>
	<u>DNA 149A, BT 8088A</u>	

OFFICIAL BBU INFORMATION

Expected Progeny Differences:										
	BW	WW	YW	Milk	TM	SC	REA	%IMF	Rib Fat	Rump Fat
EPD	0.5	6	7	2	5	0.0				
ACC	PE	PE	PE	PE	PE	PE				

Good looking, good udder, long bodied, correct made female with a good coupon at side that makes this TECO daughter one to think about. Her dam is one of our most prolific producing donors out of our tremendous Spring Fever donor. Great genetics back this product that you can use to be a more successful Beefmaster breeder. Pedigree of calf.

Purchaser _____ \$ _____

3 IN 1

ID No.: **252** Calf At Side: **Heifer**
 Breeder: **Lloyd & Lloyd** ID No.: **3**
 BBU No.: **930133** BBU No.: **AF**
 Birth: **11/14/05** Birth: **4/6/11**
 Color: **Red MUL** Color: **Red SF**
 Bred To: **O'Sugar, 940597**

	<u>Captain Sugar 12/02</u>	<u>**Infinity</u>
O'Sugar 043	<u>**Sugar Ann</u>	<u>**Cavalier</u>
DNA 463926A PV	<u>**Oasis</u>	<u>**Sex Life</u>
	<u>**Cavalier</u>	<u>**Spartacus</u>
Lloyd & Lloyd 252	<u>DNA 302A, BT 5679A</u>	<u>**Madera 1-5/5</u>
	<u>Baby's Sister 25/7</u>	<u>**Cherokee Phantom</u>
	<u>BT 7539C</u>	<u>**Miss Lee</u>

OFFICIAL BBU INFORMATION

Expected Progeny Differences:										
	BW	WW	YW	Milk	TM	SC	REA	%IMF	Rib Fat	Rump Fat
EPD	0.8	3	-2	-3	-1	-0.1				
ACC	PE	PE	PE	PE	PE	PE				

Heavy bred to calve back the same way, this young lady is proving through her production at side that she is worth your attention. Bred right and built around superior individuals, this is a 3 in 1 that you will be "glad you did" if you take her home! Pedigree of calf.

Purchaser _____ \$ _____

EXPOSED PAIR

ID No.: **2993** Calf At Side: **Bull**
 Breeder: **Lloyd & Lloyd** ID No.: **25**
 BBU No.: **975287** BBU No.: **AF**
 Birth: **9/21/08** Birth: **9/21/11**
 Color: **Red** Color: **Red**
 Exposed To: **O'Sugar, 940597**

	<u>Captain Sugar 12/02</u>	<u>**Infinity</u>
O'Sugar 043	<u>**Sugar Ann</u>	<u>**Cavalier</u>
DNA 463926A PV	<u>**Oasis</u>	<u>**Sex Life</u>
	<u>The Electric Co. 3155</u>	<u>Equity 8295A</u>
Lloyd & Lloyd 2993	<u>DNA 298502A</u>	<u>Black Jack's Sister</u>
	<u>BT BBU61</u>	<u>**Mr Coffee</u>
	<u>Lloyd & Lloyd 97</u>	<u>Spring Fever 815</u>
	<u>DNA 149A, BT 8088A</u>	

OFFICIAL BBU INFORMATION

Expected Progeny Differences:										
	BW	WW	YW	Milk	TM	SC	REA	%IMF	Rib Fat	Rump Fat
EPD	0.5	6	7	2	5	0.0				
ACC	PE	PE	PE	PE	PE	PE				

Study the thick, stout made O'Sugar calf at side. This is potentially your next herdsire! Long bodied, good milking TECO that brings the genetics that this breed has been built around. Pedigree of calf.

Purchaser _____ \$ _____

Lloyd & Lloyd Farms

61

EXPOSED PAIR

ID No.: **2962** Calf At Side: **Bull**
 Breeder: **Lloyd & Lloyd** ID No.: **32**
 BBU No.: **975286** BBU No.: **AF**
 Birth: **9/24/08** Birth: **10/23/11**
 Color: **Red** Color: **Red**
 Exposed To: **O'Sugar, 940597**

Captain Sugar 12/02
 O'Sugar 043
 DNA 463926A PV
 Lloyd & Lloyd 2962
 The Electric Co. 3155
 DNA 298502A
 BT BBU61
 Lloyd & Lloyd 97
 DNA 149A, BT 8088A

OFFICIAL BBU INFORMATION

Expected Progeny Differences:										
	BW	WW	YW	Milk	TM	SC	REA	%IMF	Rib Fat	Rump Fat
EPD	0.5	6	7	2	5	0.0				
ACC	PE	PE	PE	PE	PE	PE				

Strong clean sheathed herdsire prospect at side. O'Sugar and TECO is working to produce both superior females and males just as we hoped and these are the first of their kind. Great opportunity to add quality and cutting edge genetics at the same time! Pedigree of calf.

Purchaser _____ \$ _____

New Cut Farms

63

POLLED BRED HEIFER

ID No.: **921 Red Reba Britches**
 Breeder: **New Cut Farms** Birth: **3/1/10**
 BBU No.: **993727** Color: **Red**
 Al'd To: **Sugar Bear, 977252 (11/23/11)**

Mr CJ 99-7
 South Oaks 5003
 Homestead 293J7

Motown 412
 Soul Man 168
 Laurie Baby 14/2
 **Xcite
 Aycock 2072
 Dunkin 7-054
 **Black Magic
 **Black Jack 21
 Missy 8-1
 **Red Sugar
 Miss Poll Texas 77/92

OFFICIAL BBU INFORMATION

Expected Progeny Differences:										
	BW	WW	YW	Milk	TM	SC	REA	%IMF	Rib Fat	Rump Fat
EPD	-0.8	12	18	2	8	0.4	-0.12	-0.1	-0.05	-0.01
ACC	.41	.31	.34	.12	-	.19	.28	.31	.29	.33
	BW	WW	YW	Scrotal	REA	%IMF	Rib Fat	Rump Fat		
Ratio	96		96		86	54	80	113		
Contemp.	3		2		2	2	2	2		
Adj. Trait	74		625		6.42	1.26	0.08	0.18		

DNA MMD0195077. Red Reba Britches was Al'd to Sugar Bear on 11/23/11. Impressive female with special performance. Couldn't go wrong with a heifer of this eye appeal, soundness and performance. Grand Champion Heifer in SABMG Futurity 9/11.

Purchaser _____ \$ _____

New Cut Farms

62

BULL

ID No.: **924 O'Rielly**
 Breeder: **New Cut Farms** Birth: **1/31/10**
 BBU No.: **993710** Color: **Dk. Red**

Captain Sugar 12/02
 Sugar Britches 040
 DNA 345274A
 Lela 424-6
 Alabama's
 Black Magic 601
 JHM 29-4
 Harrod 3033/7

OFFICIAL BBU INFORMATION

Expected Progeny Differences:										
	BW	WW	YW	Milk	TM	SC	REA	%IMF	Rib Fat	Rump Fat
EPD	1.0	22	29	1	12	0.5	0.08	0.0	0.03	0.00
ACC	.41	.34	.36	.10	-	.21	PE	PE	PE	PE
	BW	WW	YW	Scrotal	REA	%IMF	Rib Fat	Rump Fat		
Ratio	95		109		101	147	129	131		
Contemp.	2		2		3	3	3	3		
Adj. Trait	81		927		9.96	2.02	0.18	0.27		

A powerful Sugar Britches son that has all the performance you're looking for. O'Rielly has eye appeal, great topline, thickness and is dark red with EPDs ahead of the pack!

Purchaser _____ \$ _____

New Cut Farms

64

POLLED OPEN HEIFER

ID No.: **221**
 Breeder: **New Cut Farms** Birth: **2/25/11**
 BBU No.: **1002829** Color: **Red**

Valiant 90/1
 DNA 781A
 BT 9032A
 Miss TP 10/7

**Cavalier
 Soul Man 168
 Perrys 549

**Spartacus
 **Madera 1-5/5
 **Synergy
 **Victor's Sister
 CJ 721
 Soulmans Momma 928
 **Painted Tiger
 Dunkin 3-020

OFFICIAL BBU INFORMATION

Expected Progeny Differences:										
	BW	WW	YW	Milk	TM	SC	REA	%IMF	Rib Fat	Rump Fat
EPD	-0.2	-1	0	0	0	-0.1	-0.15	0.1	0.01	-0.05
ACC	PE	PE	PE	PE	PE	PE	PE	PE	PE	PE

This heifer raises the bar. Without question, one of the highlights of our program. Impressive to go with her good looks!

Purchaser _____ \$ _____

10 FROZEN EMBRYOS

Sugar Britches 040	Captain Sugar 12/02	**Infinity
DNA 345274A	**Oasis	**Sugar Ann
		**Cavalier
		**Sex Life
CP 162	Soul Man 168	CJ 721
	Red Sister 44	Soulmans Momma 928
		**Red Sugar
		**Victor's Sister

Get some Sugar Britches production of your own! Proven producer and look at Sugar Britches' production being offered here. Stored at Cottage Farm Genetics; will be sold per embryo with minimum of 5 embryo purchase.

Purchaser _____ \$ _____

POLLED BRED HEIFER

ID No.:	10-48	Birth:	7/18/10
Breeder:	T Bar K	Color:	Black
BBU No.:	1008539		
Bred To:	Casey 126-9, 993854		
	Captain Lucey 116/01	**Infinity	
Capt Oasis 015		**Milk & Honey	
DNA 324263A	**Oasis	**Cavalier	
		**Sex Life	
	Soul Man 168	CJ 721	
TVR 2197		Soulmans Momma 928	
	Brindle Tigeress 895	**Painted Tiger	
		Triple T 293/91	

Polled with powerful conformation and genetics that will help put the extra predictable performance in your breeding program. Bred to the Xcite x Pride x Victoria's Secret bull we bought here last year. Strong package.

Purchaser _____ \$ _____

BRED HEIFER

ID No.:	CV 96 Dee Dee	Birth:	6/12/10
Breeder:	Hall & Tate	Color:	Red
BBU No.:	989943		
AI'd To:	Bulletproof, 931489 (10/23/11)		
	Black Synergy 2195	**Synergy	
Mr. Brown M743	TVR 2117	**Magic Mom	
DNA 636067A PV		**Xcite	
		Dunkin 0/049	
	Catalyst 729	Cain 537	
Lisa Rose CV28		Lasater 610	
	DRN 470-1	**American Standard	
		Adair 28/8	

Extra nice Mr. Brown heifer bought from Tate & Hall, Covertside, TN. She is safe in calf, AI'd 10/23/11 to Bulletproof. Her dam's last calf was sold as a show calf.

Purchaser _____ \$ _____

BRED HEIFER

ID No.:	10-53	Birth:	8/10/10
Breeder:	T Bar K	Color:	Red
BBU No.:	1008538		
Bred To:	T Bar K 10-54, 1008541		
	Captain Lucey 116/01	**Infinity	
Capt Oasis 015		**Milk & Honey	
DNA 324263A	**Oasis	**Cavalier	
		**Sex Life	
	**Synergy	**Red Sugar	
Pack TP 21/4		**Prissy Lady	
	HMS 632/4	**Spartacus	
		**Cedar Crest 6050	

OFFICIAL BBU INFORMATION

Expected Progeny Differences:										
	BW	WW	YW	Milk	TM	SC	REA	%IMF	Rib Fat	Rump Fat
EPD	1.1	20	25	-1	9	0.5				
ACC	PE	PE	PE	PE	PE	PE				

Wow, here is your Captain Oasis out of tremendous maternal genetics all the way back to Jungle Red. Coming with a calf by our Spartacus son out of our Infinity Oasis donor. Total package!

Purchaser _____ \$ _____

T Bar K

71

POLLED BRED HEIFER

ID No.: **10-49**
 Breeder: **T Bar K** Birth: **9/21/10**
 BBU No.: **1008540** Color: **Brown WP**
 Bred To: **T Bar K 10-54, 1008541**

Captain Lucey 116/01	**Infinity
Capt Oasis 015	**Milk & Honey
DNA 324263A	**Cavalier
	**Sex Life
	**Black Magic
Black Country 5-02	T Bar K 8-23
Atlantia Tigeress 6-18	Atlanta 7/6
Hill's H&H 294	Dunkin 9-054

Captain Oasis is consistently putting out calves with the quality of his genetics. These females have what you desire. Bred to our Spartacus son out of our Infinity Oasis donor.

Purchaser _____ \$ _____

Thunder Valley Ranch

73

HERDSIRE

ID No.: **2175 Xerox**
 Breeder: **TVR** Birth: **2/17/05**
 BBU No.: **916825** Color: **Red**

**Synergy	**Red Sugar	**Cherokee Phantom
DNA 183A	**Prissy Lady	**Sugar Ann
BT 5779A		**Spartacus
	Ronnie 007	**Madam X 3/293
**Magic Mom		**Tailor Made
DNA 416448A	Circle K 223-0	**Horlock 151-4
BT 6839A		Lightning 719
		Circle K 191

OFFICIAL BBU INFORMATION

Classification:	U	Conformation:	1	Underline:	2					
Expected Progeny Differences:										
BW	WW	YW	Milk	TM	SC	REA	%IMF	Rib Fat	Rump Fat	
EPD	1.4	10	19	4	9	0.0	-0.03	0.0	-0.01	-0.07
ACC	.68	.56	.51	.33	-	.38	.29	.26	.26	.26
		BW	WW	YW	Scrotal	REA	%IMF	Rib Fat	Rump Fat	
Ratio				101						
Contemp.				2						
Adj. Trait				589						

DNA 406109A PV. We have kept so many of his daughters out of some of the best Beefmaster females in the breed that we are selling him. He sells proven in every way and with 100 straws of embryo quality semen. Parent verified and ready for service.

Purchaser _____ \$ _____

T Bar K

72

OPEN HEIFER

ID No.: **11-07 Sweet Tigeress**
 Breeder: **T Bar K** Birth: **5/8/11**
 BBU No.: **1008564** Color: **Lt. Brown WUL**

**Painted Tiger	**Painted Warrior	**Robert E. Lee
DNA US3000923	**Dunkin 1-126	**Barfield 8/123
BT 3081B		McCullars 116
	**Black Jack 21	**Volunteer 66
Sweet Janine 18-5		**Black Magic
DNA 484137A	Sugar Sweet 38-0	Missy 8-1
		**Spartacus
		L2 102/93

OFFICIAL BBU INFORMATION

Expected Progeny Differences:										
BW	WW	YW	Milk	TM	SC	REA	%IMF	Rib Fat	Rump Fat	
EPD	1.6	7	13	3	7	0.2	0.07	-0.02	-0.04	-0.05
ACC	PE	PE	PE	PE	PE	PE	PE	PE	PE	PE

Powerful Painted Tiger with all the maternal genetics you can ask for going back to Sugar Ann. This is a Painted Tiger daughter that you can build with and rest on the assurance that she will reward you for your confidence.

Purchaser _____ \$ _____

Thunder Valley Ranch

74

BRED DONOR PROSPECT

ID No.: **5104**
 Breeder: **Cotton & Davis** Birth: **5/10/047**
 BBU No.: **897871** Color: **Paint**
 Bred To: **Dr. J, 850830**

**Painted Tiger	**Painted Warrior	**Robert E. Lee
DNA US3000923	**Dunkin 1-126	**Barfield 8/123
BT 3081B		McCullars 116
	**Synergy	**Volunteer 66
Farrah's Promise 65/99		**Red Sugar
DNA 485A	**Farrah Lady	**Prissy Lady
BT 6940C		**J Fifteen
		**Madam X 3/293

OFFICIAL BBU INFORMATION

Expected Progeny Differences:										
BW	WW	YW	Milk	TM	SC	REA	%IMF	Rib Fat	Rump Fat	
EPD	0.2	7	17	5	9	0.4	0.05	-0.1	0.02	-0.06
ACC	.54	.42	.42	.36	-	.36	PE	PE	PE	PE

A very good female that needs to be in someone's donor program. 7-8 months bred to our polled Infinity son, Dr. J, that we purchased from Mr. Bradley. You won't find females with this breeding much anymore.

Purchaser _____ \$ _____

Whitley Family Farms

75

BRED HEIFER

ID No.: **03910W Raven**
 Breeder: **Whitley** Birth: **3/9/10**
 BBU No.: **994740** Color: **Red**
 Bred To: **281/9**

	<u>**Black Jack 21</u>	<u>**Black Magic</u>
<u>Ace in the Hole 70/3</u>		<u>Missy 8-1</u>
<u>DNA 249A</u>	<u>Sugar Pie 42/01</u>	<u>**Infinity</u>
<u>BT 8285A</u>		<u>Q Tee Pie 13/9</u>
	<u>Soul Man 168</u>	<u>CJ 721</u>
<u>Felicity's Ebony 1018/6</u>		<u>Soulmans Momma 928</u>
<u>DNA 634948A</u>	<u>Clara's Felicity 829/1</u>	<u>**Grand Cherokee</u>
		<u>Clara 321/6</u>

OFFICIAL BBU INFORMATION

Expected Progeny Differences:

	BW	WW	YW	Milk	TM	SC	REA	%IMF	Rib Fat	Rump Fat
EPD	1.0	2	5	2	3	-0.2				
ACC	PE	PE	PE	PE	PE	PE				

Raven is a solid red heifer out of Whitley Family Farms' Champion donor, Felicity's Ebony, and sired by Ace in the Hole. She has polled genetics and is a proven winner in the show ring on all sides including full sisters and brothers. She is bred to J.C. Thompson's new bull 281/9 (Ace in the Hole x Red Mama [Painted Tiger daughter]), due 4/3/12. She is very feminine and clean fronted. She will add appeal to any herd whether you are marketing show calves or looking for highly fertile bloodlines. A picture of her taken at 12 months of age can be found on heifershop.com; a new picture will be updated soon. Thank you for your consideration.

Purchaser _____ \$ _____

Windy Hills

76

PAIR BY SALE

ID No.: **5065** Calf At Side:
 Breeder: **Windy Hills** ID No.:
 BBU No.: **911101** BBU No.: **AF**
 Birth: **12/25/04** Birth:
 Color: **Red** Color:

	<u>Soul-A-Tiger 5001</u>	<u>Soul Man 168</u>
<u>WH 9000</u>		<u>Dunkin 3-1</u>
<u>US9000948163 PV</u>	<u>Dreamworks 66/3</u>	<u>**Cavalier</u>
		<u>Red Farrah Lady 41/97</u>
	<u>Soul Man 168</u>	<u>CJ 721</u>
<u>WH 5065</u>	<u>DNA US3000427</u>	<u>Soulmans Momma 928</u>
<u>DNA 537918A</u>	<u>BT 7670A</u>	<u>**Red Tiger</u>
	<u>Red Prissy 0277NZ</u>	<u>L2 75/95</u>
	<u>DNA 595621A</u>	
	<u>BT 7593A</u>	

OFFICIAL BBU INFORMATION

Classification: U Conformation: 1 Underline: 3

Expected Progeny Differences:

	BW	WW	YW	Milk	TM	SC	REA	%IMF	Rib Fat	Rump Fat
EPD	0.3	5	13	5	7	0.2	-0.05	0.1	0.04	0.05
ACC	.42	.41	.38	.31	-	.31	.31	.31	.31	.31

DNA 537918A. Red Prissy has proven through her production to be in the elite end of the breed. WH 5065 is the next generation, built perfectly and ready to work with any of the bulls in the breed. We would not be selling her if we did not have a sister in our donor herd. Great opportunity to attach to this performance genetic package. Pedigree of calf to be born before sale out of our young herdsire who brings Miss Broadhooks and Red Farrah Lady into the genetic package!

Purchaser _____ \$ _____

Windy Hills

76A

14 FROZEN EMBRYOS

	<u>Captain Sugar 12/02</u>	<u>**Infinity</u>
<u>Sugar Bear 933</u>		<u>**Sugar Ann</u>
<u>DNA US3000936 PV</u>	<u>**Oasis</u>	<u>**Cavalier</u>
		<u>**Sex Life</u>
	<u>Soul Man 168</u>	<u>CJ 721</u>
<u>WH 5065</u>		<u>Soulmans Momma 928</u>
<u>DNA 537918A</u>	<u>Red Prissy 0277NZ</u>	<u>**Red Tiger</u>
		<u>L2 75/95</u>

Great opportunity to get some of the first Sugar Bear production plus the bonus of 5065 and her fantastic individuality and genetics. Stored at Genex.

Purchaser _____ \$ _____

PAIR BY SALE

ID No.: **8440** Calf At Side:
 Breeder: **Windy Hills** ID No.:
 BBU No.: **982445** BBU No.: **AF**
 Birth: **11/25/08** Birth:
 Color: **Red SF MUL** Color:

Soul Man 168
 Soul-A-Tiger 5001 Dunkin 3-1
 **Cavalier
 Dreamworks 66/3 Red Farrah Lady 41/97
 **Infinity
 Captain Sugar 12/02 **Sugar Ann
 DNA 134A, BT 7526A **Red Tiger
 Red Prissy 0277NZ
 DNA 595621A L2 75/95
 BT 7593A

WH 9000

US9000948163 PV

WH 8440

DNA US9000948177 PV

OFFICIAL BBU INFORMATION

Classification:	U	Conformation:	Underline:							
Expected Progeny Differences:										
	BW	WW	YW	Milk	TM	SC	REA	%IMF	Rib Fat	Rump Fat
EPD	0.7	7	6	4	7	0.2	-0.24	-0.1	-0.01	-0.07
ACC	PE	PE	PE	PE	PE	PE	PE	PE	PE	PE

DNA US9000948177 PV. Captain Sugar and Red Prissy gather two of the maternal legends of the breed up close and personal. If you put 293 and Sugar Ann together, you get the quality and the production with all the six essentials plus consistency! One of only two in the breed! Pedigree of calf to be born before sale out of our young herdsire who brings Miss Broadhooks and Red Farrah Lady into the genetic package!

Purchaser _____ \$ _____

OPEN HEIFER

ID No.: **110**
 Breeder: **Windy Hills** Birth: **12/3/10**
 BBU No.: **1003643** Color: **Red**

**Infinity
 Captain Lucey 116/01 **Red Sugar
 DNA 133A **Vanna
 BT 7402A **Synergy
 **Milk & Honey
 ***Dolce Freddo
 **Spartacus
 **Gladiator
 Gucci Girl 8103 **Dreamlady
 Synergy's Lady 81/99 **Synergy
 **BTV

OFFICIAL BBU INFORMATION

Expected Progeny Differences:										
	BW	WW	YW	Milk	TM	SC	REA	%IMF	Rib Fat	Rump Fat
EPD	1.5	13	17	-1	5	0.2				
ACC	.39	.45	.41	.26	-	.34				
	BW	WW	YW	Scrotal	REA	%IMF	Rib Fat	Rump Fat		
Ratio	100	100								
Contemp.	1	2								
Adj. Trait	73	570								

This is Gucci Girl's first calf! Powerful Captain Lucey female that has the predictable pedigree, performance and visual quality necessary for you to be successful!

Purchaser _____ \$ _____

OPEN HEIFER

ID No.: **01 Sugar Britches Star**
 Breeder: **Smith** Birth: **9/8/10**
 BBU No.: **998259** Color: **Red SF MUL**

Captain Sugar 12/02 **Infinity
 Sugar Britches 040 **Sugar Ann
 DNA 345274A **Oasis **Cavalier
 **Sex Life
 **Painted Tiger **Painted Warrior
 Dreamtime 87/06 **Dunkin 1-126
 DNA 580856A PV Dreamlady in Red **Spartacus
 Adair 062/4

OFFICIAL BBU INFORMATION

Expected Progeny Differences:										
	BW	WW	YW	Milk	TM	SC	REA	%IMF	Rib Fat	Rump Fat
EPD	0.5	15	17	0	7	0.5				
ACC	PE	PE	PE	PE	PE	PE	PE	PE	PE	PE

Sugar Britches Star is a beautiful combination of powerful conformation and predicable pedigree. She can be an asset to any breeding program built around Oasis and Dreamlady in Red. Here's your deal!

Purchaser _____ \$ _____

NOTES

BEEFMASTER BREEDERS UNITED

6800 Park Ten Blvd., Suite 290 West

San Antonio, Texas 78213

210/732-3132

Web site: www.beefmasters.org

**APPLICATION FOR MEMBERSHIP
NAME FRANCHISE & HOLDING BRAND CONTRACT**

Date

Application is hereby made for membership in Beefmaster Breeders United (BBU) in the name of

(The Membership Name and Prefix Name are permanent records and cannot be changed.)

This application is hereby made for a (circle one of the following): Lifetime, Active, *Junior or Associate membership

This is a (circle one): Corporation, Partnership, Firm or Individual

I (We) hereby make application for the Prefix Name: _____,
and will apply this Prefix Name, if accepted, to BEEFMASTER cattle of which I am (we are) the breeder and/or
first owner. I (We) agree to notify BBU annually, with payment of dues, as to whether I am (we are) still breeding
BEEFMASTERS and using this Prefix Name. If I (we) do not so notify BBU, I (we) authorize BBU to discontinue
my (our) use of this Prefix Name. (Annual notification and dues do not apply to Lifetime memberships.)

I (We) will use the following Holding Brand: _____ (please sketch)

I (We) hereby designate _____ to exercise all rights and
privileges of this membership and, no person other than that named may act for this membership until the BBU
Executive Vice President has been notified in writing that another name is being substituted for the above and
receipt of notification has been acknowledged in writing.

I (We), if elected to membership, agree to be governed by the By-Laws, Rules and Regulations of Beefmaster
Breeders United, as amended from time to time, and hereby acknowledge receipt of the current By-Laws, Rules
and Regulations.

I (We) hereby affirm the above and foregoing is true and correct to the best of my (our) knowledge and belief.

Signature and Title of Applicant(s)

*Date of Birth & School Grade
JUNIOR APPLICANT ONLY

Spouse's First Name

Name of Ranch Manager

Mailing Address (Box No. or Street)

Ranch Address

City, State & Zip Code

Ranch - City, State & Zip Code

E-Mail Address

(Res.) _____
Area Code/Telephone No.

(Bus.) _____
Area Code/Telephone No.

(Ranch) _____
Area Code/Telephone No.

(Mobile) _____
Area Code/Telephone No.

Lifetime Member Dues = \$2,000 • Active Member Dues = \$100 • Associate Member Dues = \$100 • First Time Member Special = \$50
Junior Member Dues = \$60 *Junior applicants must be under the age of 21 years on January 1st of the current year.

The above membership dues include an annual subscription to *The Beefmaster Cowman*.

Payment of Beefmaster Breeders United dues are tax deductible for most members as an ordinary and necessary business expense.

However, charitable contributions or gifts to Beefmaster Breeders United are not deductible for Federal income tax purposes.

*****PLEASE SEND MEMBERSHIP DUES WITH THIS APPLICATION TO 6800 Park Ten Blvd., Suite 290 W, San Antonio, TX 78213*****

ROBBINS

C A T L E
CONSULTING & MARKETING

Bruce Robbins
19202 Heather Creek
San Antonio, TX 78258

FIRST CLASS MAIL
DATED MATERIAL